

LANDMARK SUITES PARKING REQUIREMENTS

PARCEL 1 (PORTION OF LOTS 17-24), PARCEL 2 OF LOTS 17-24 AND SOUTH 1/2 OF VACATED ALLEY NORTH AND ADJACENT LESS THE SOUTH 67 FEET AND THE SOUTH 50 FEET OF LOTS 25-27 AND THE 17 FET OF THE RAIL ROAD RIGHT OF WAY, BLOCK 63 OF ORIGINAL TOWN OF RAPID CITY, IN SECTION 36, T2N, R7E, BHM, RAPID CITY, PENNINGTON COUNTY, SOUTH DAKOTA

PARKING REQUIREMENTS PROVIDED:		66 SPACES (54 ONSITE + 12 OFFSITE WITHIN 300 FT)
REQUIRED:		66 (65.94) SPACES
SPACE 318-A	7.5	
SPACE 318-B	10.62	
SPACE 318-C	5.66	
SPACE 318-D	5.06	
SPACE 318-E	33.0	(21 ONSITE AND 12 OFFSITE)
SPACE 318-F	1.70	
SPACE 315	0.61	
BASEMENT 318-LOWER	1.79	

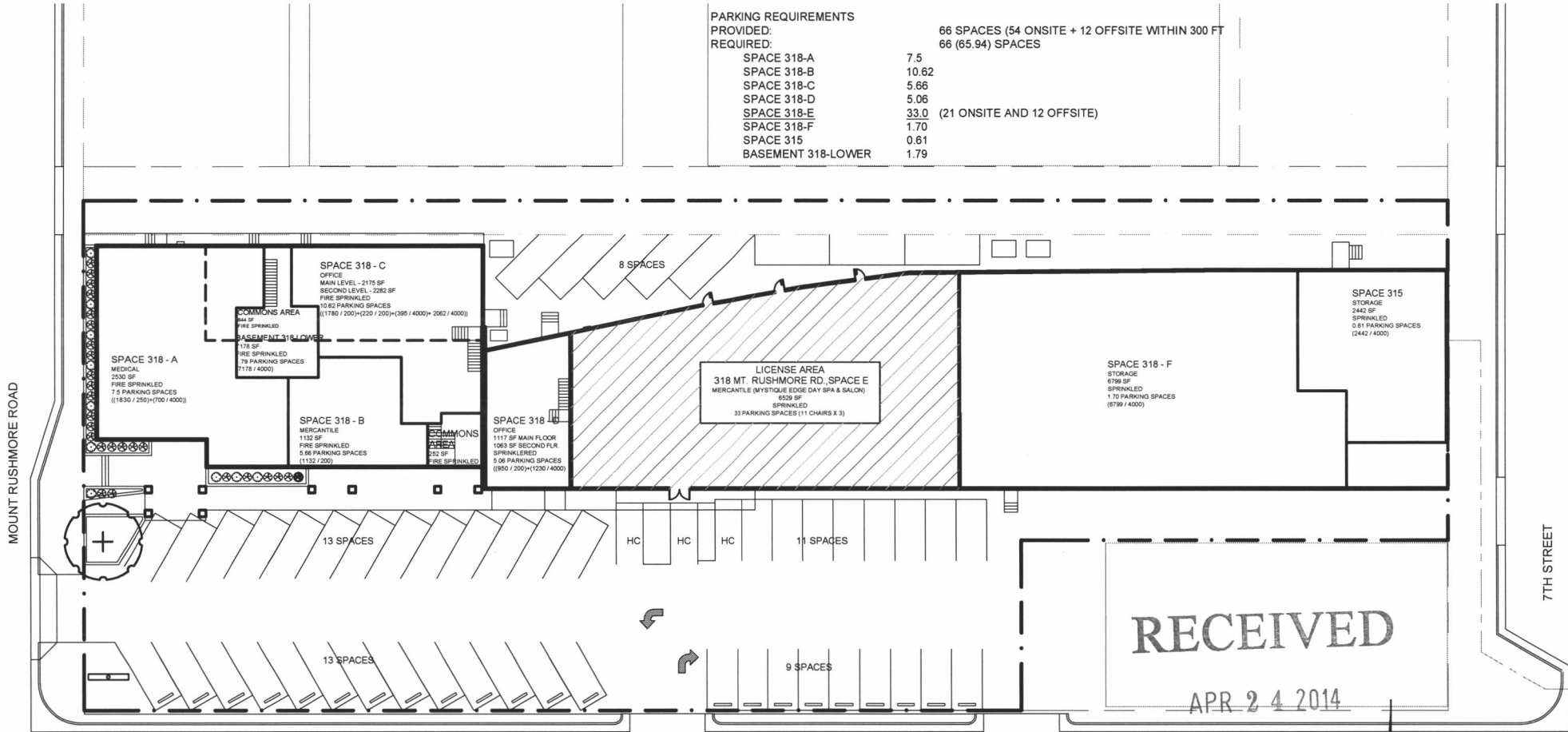

APOLDA STREET

RECEIVED
APR 24 2014

RAPID CITY COMMUNITY PLANNING & DEVELOPMENT SERVICES
CITY PARKING LOT EMPLOYEE PARKING SPACES

