

Option #1 only BEM

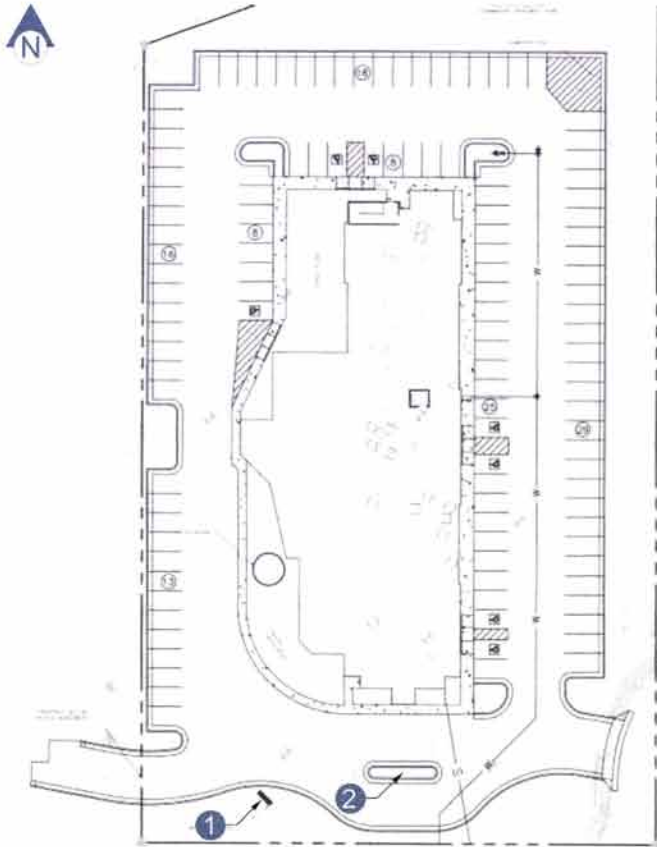

CHEYENNE BLVD

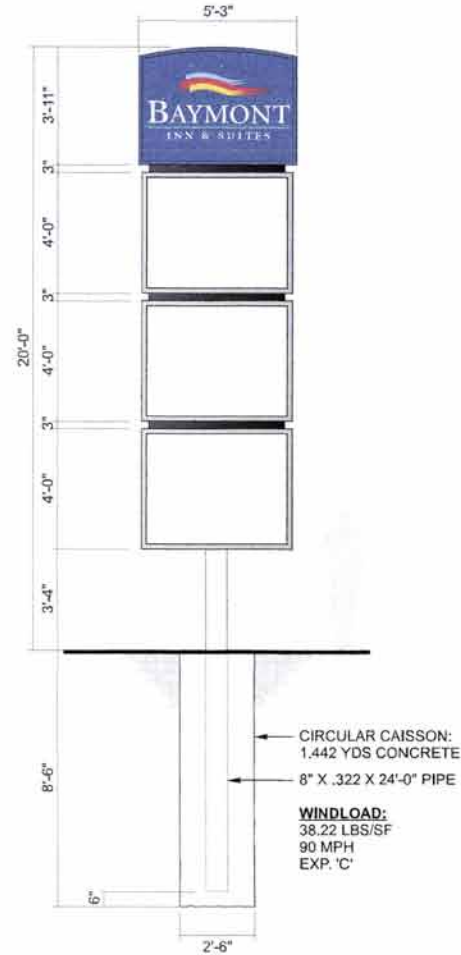

1 **CUSTOM BAY-P20 - D/F Internally Illum'd Pylon Sign w/ additional Tenant Cabinets**
SCALE: 1/2"=1'-0"

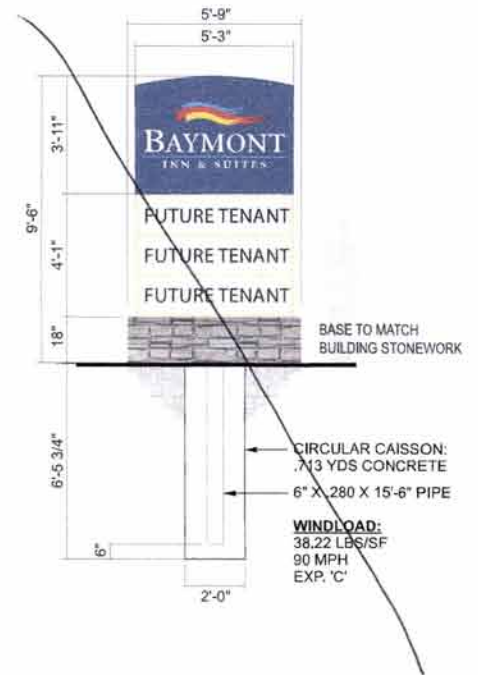

2 **CUSTOM BAY-P20 - S/F Internally Illum'd Pylon Sign w/ additional Tenant Cabinets**
SCALE: 1/2"=1'-0"

16265 Star Road Nampa, ID 83687 toll free: 800.592.8058 tele: 208.345.4020 fax: 208.336.9886 www.imagenational.com

RECEIVED
image national signs
bringing your image to light!
MAY 10 2013

PROJECT TITLE:

LOCATION: Site #48640
4040 Cheyenne Blvd
Rapid City, SD. 57703

DATE: 042213

S/R: N/A

APPROVE DES: Frank Ikhan

DRAWN BY: S.J.V.L.

COMPLETE FILE: 35-430-Rapid-City-SD-042213

PROJECT NO: 433195-001

NAMPA PLANT -
UL # 433195-001

page # 1 of 1