

08-23-12 P:\05-105\AutoCAD\Easements\EXHIBIT PARCEL 9VAC.dwg

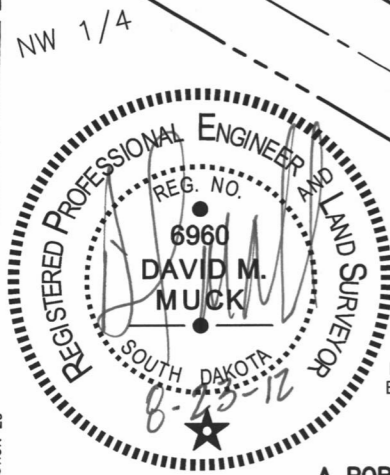

A PORTION OF LOT H2 AND LOT H4 TO BE VACATED IN THE NW1/4, A PORTION OF LOT H3 TO BE VACATED IN LOT C OF SE1/4NW1/4, A PORTION OF LOT H5 TO BE VACATED IN THE SE1/4, A PORTION OF LOT H7 TO BE VACATED IN LOT 1 OF THE NE1/4SW1/4 AND A PORTION OF LOT H8 TO BE VACATED IN THE SW1/4, ALL LOCATED IN SECTION 29, T2N, R8E, BHM, RAPID CITY, PENNINGTON COUNTY, SOUTH DAKOTA



SECTION 30  
SECTION 29

LOT H2  
NW 1/4-29-2-8  
BK HW 11 PG 45  
06/07/06

A PORTION OF LOT H3  
TO BE VACATED  
CONTAINING 0.01 AC  
354 SQ FT  
MORE OR LESS  
LOT H3  
NW 1/4-29-2-8  
BK HW 11 PG 45  
06/07/06

LOT H4  
NW 1/4-29-2-8  
BK HW 11 PG 45  
06/07/06

A PORTION OF LOT H4  
TO BE VACATED  
CONTAINING 0.40 AC  
17250 SQ FT  
MORE OR LESS

A PORTION OF LOT H2  
TO BE VACATED  
CONTAINING 0.01 AC  
577 SQ FT  
MORE OR LESS

A PORTION OF LOT H7  
TO BE VACATED  
CONTAINING 0.31 AC  
13478 SQ FT  
MORE OR LESS  
LOT H7  
SW 1/4-29-2-8  
BK HW 11 PG 34  
06/07/06

A PORTION OF LOT H8  
TO BE VACATED  
CONTAINING 0.55 AC  
23803 SQ FT  
MORE OR LESS  
LOT H8  
SW 1/4-29-2-8  
BK HW 11 PG 34  
06/07/06

LOT H5  
SE 1/4-29-2-8  
BK HW 6 PG 63  
06/06/78

A PORTION OF LOT H5  
TO BE VACATED  
CONTAINING 0.04 AC  
1902 SQ FT  
MORE OR LESS

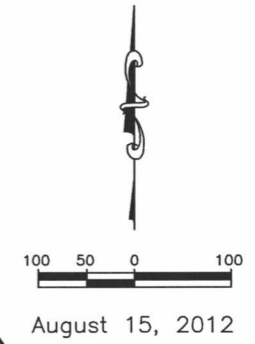

| LINE # | DIRECTION   | L (FT) |
|--------|-------------|--------|
| L1     | S01°48'37"W | 9.56   |
| L2     | N59°18'18"W | 136.27 |
| L3     | N73°33'47"E | 0.97   |
| L4     | N88°08'16"W | 25.22  |
| L5     | N59°18'18"W | 22.96  |
| L6     | N88°00'34"W | 63.22  |
| L7     | N59°18'18"W | 170.29 |
| L8     | S01°35'39"W | 37.64  |
| L9     | S47°17'57"W | 10.80  |
| L10    | S42°42'03"E | 100.00 |
| L11    | N47°17'57"E | 17.79  |
| L12    | S86°59'44"E | 27.93  |
| L13    | N88°03'39"W | 71.07  |
| L14    | S02°01'29"W | 16.67  |
| L15    | N39°27'45"W | 135.70 |

| CURVE # | DELTA ANGLE | R (FT)  | L (FT) | CHORD BEARING | LC (FT) |
|---------|-------------|---------|--------|---------------|---------|
| C1      | 1°29'07"    | 5062.00 | 131.22 | S62°38'54"E   | 131.22  |
| C2      | 0°33'50"    | 5062.00 | 49.82  | S63°40'23"E   | 49.82   |
| C3      | 0°20'03"    | 5062.00 | 29.52  | S64°07'19"E   | 29.52   |
| C4      | 14°28'13"   | 2438.00 | 615.73 | S57°03'14"E   | 614.10  |
| C5      | 10°21'49"   | 2442.50 | 441.79 | N54°07'23"W   | 441.19  |
| C6      | 5°18'34"    | 2438.00 | 225.92 | S47°09'50"E   | 225.84  |
| C7      | 0°23'50"    | 2438.00 | 16.90  | S40°51'25"E   | 16.90   |
| C8      | 9°00'35"    | 2442.50 | 384.08 | N44°26'11"W   | 383.69  |
| C9      | 3°40'12"    | 2438.00 | 156.16 | S38°49'25"E   | 156.13  |
| C10     | 25°29'15"   | 977.00  | 434.61 | S49°43'56"E   | 431.03  |
| C11     | 27°14'25"   | 1057.50 | 502.77 | N53°04'58"W   | 498.05  |
| C12     | 0°28'09"    | 2442.50 | 20.00  | N39°41'50"W   | 20.00   |
| C13     | 15°32'39"   | 977.00  | 265.06 | S70°14'53"E   | 264.25  |
| C14     | 14°06'14"   | 1057.50 | 260.31 | N73°45'17"W   | 259.66  |

EXHIBIT A