

RECEIVED

FEB 25 2011

Rapid City Growth Management Department

LOT 1

LOT 2

LOT 3

LOT 4

LOT 5

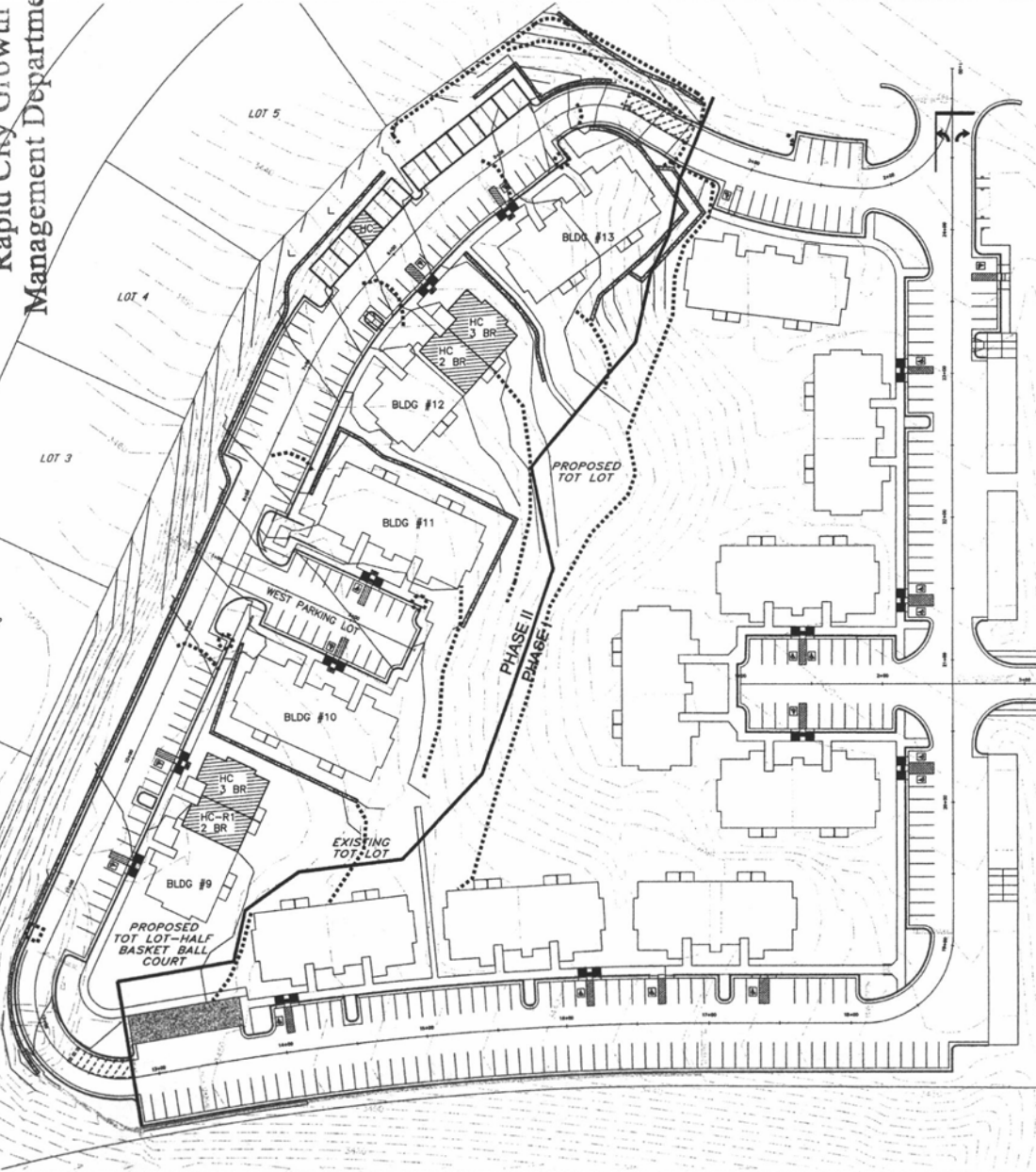

ALL EROSION CONTROL NOTES AND SPECIFICATIONS STATED IN THE ORIGINAL EAGLE RIDGE PRD DOCUMENTS SHALL APPLY TO THE PRD AMENDMENT UNLESS OTHERWISE NOTED IN THIS PLAN.

RIVER ROCK MULCH ALONG THE WEST PROPERTY LINE SHALL BE INSTALLED WITHIN 5 DAYS AFTER THE COMPLETION OF RETAINING WALL AND 4:1 BACKSLOPE CONSTRUCTION.

THE CONCRETE WASH OUT SHALL CONSIST OF 9" COMPOST FILTER SOCK OR SILT FENCE AROUND THE PERIMETER OF THE DESIGNATED AREA.

STABILIZED CONSTRUCTION ENTRANCES SHALL BE INSTALLED AS PER RAPID CITY SPECIFICATIONS.

9" COMPOST FILTER SOCK SHALL BE DIETEN COMPOST FILTER SOCK OR APPROVED EQUAL.

PERMANT COMPOST FILTER SOCK OR SILT FENCE SHALL BE INSTALLED PRIOR TO GRADING OPERATIONS.

PERMANT SEEDING SHALL BE INSTALLED NO LATER THAN 14 DAYS AFTER FINAL GRADING IS FINISHED OR TEMPORARY EROSION CONTROL MEASURES SHALL BE IMPLEMENTED.

EXISTING TOP SOIL WITHIN GRADING LIMITS SHALL BE STRIPED AND REUSED. THE CONTRACTOR SHALL STORE TOPSOIL IN PILES WITHIN THE PROJECT LIMITS. EROSION CONTROL WATTLES SHALL BE INSTALLED AROUND TOPSOIL PILES.

STOCK PILES OF ANY SOIL MATERIAL SHALL HAVE EROSION CONTROL WATTLES INSTALLED AROUND THE PERIMETER OF THE PILE.

THE CONTRACTOR IS RESPONSIBLE FOR IMPLEMENTING THIS EROSION CONTROL PLAN. IF EXISTING SITE CONDITIONS, CONSTRUCTION OR PHASING ISSUES CAUSE THIS PLAN TO BE ALTERED OR AMENDED THE CONTRACTOR SHALL MAKE APPROPRIATE MODIFICATIONS. THE CONTRACTOR SHALL TRACK ALL CHANGES AND NOTE THEM ON THEIR COPY OF THE EROSION CONTROL PLAN ON SITE.

- 9" COMPOST FILTER SOCK OR SILT FENCE
- [Hatched Box] STABILIZED CONSTRUCTION ENTRANCE
- [Circle with Dots] 9" COMPOST FILTER SOCK OR SILT FENCE TO BE PLACED AROUND INLETS
- [Square with Dots] 8' X 8' CONCRETE WASH OUT AREA
- [Hatched Box] HANDICAP UNITS

**CITY OF RAPID CITY
GROWTH MANAGEMENT DEPT.
DEVELOPMENT SERVICES**

Plans are reviewed for general conformance with applicable governmental regulations, stipulations, design criteria and engineering standards. The City of Rapid City does not certify the suitability, adequacy or completeness of the plans or design, which are the responsibility of the engineer of record. All necessary permits shall be obtained prior to construction of the proposed public improvements.

Engineering Review: M.B. [Signature] 4-1-10 Date
COMMENTS: DEV 08-940

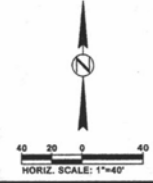

**EAGLE RIDGE PRD AMENDMENT
PHASE 2**

REVISIONS

NO.	DATE	DESCRIPTION

TITLE
EROSION CONTROL PLAN AND HANDICAP UNIT LOCATION SHEET

517 7th street rapid city sd 57701
ph: 605-342-9470 fax: 605-342-2377
www.4front.biz
ARCHITECTURE | ENGINEERING
DESIGN | SURVEYING



NEIL C. AIGANDARY
Professional Engineer
No. 8667
State of South Dakota
Expires 12/31/10

RAPID CITY, SOUTH DAKOTA
JOB NUMBER: 07-1386-001
DATE: 03/28/10

Copyright 2007. All rights reserved. No part of this document may be reproduced in any form or by any means without permission from 4front Design, Inc.