

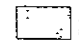

PAVEMENT LEGEND

-  4" STANDARD DUTY ASPHALT WITH 8" AGGREGATE BASE COURSE
-  6" HEAVY DUTY ASPHALT WITH 8" AGGREGATE BASE COURSE
-  6" HEAVY DUTY CONCRETE WITH 6" AGGREGATE BASE COURSE

NO.	DATE	REVISIONS
1		
2		
3		
4		
5		
6		
7		
8		
9		
10		

PREPARED BY: **BFA**
 CONSULTING ENGINEERS
 11105 WEST
 11105 WEST

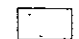
PRELIMINARY DRAWING
 FOR REVIEW PURPOSES ONLY
 NOT TO BE USED FOR CONSTRUCTION

SAM'S CLUB #6565-09
 RAPID CITY, PENNINGTON COUNTY, SD
 SAM'S WEST, INC. 2001 SE 10TH ST.
 BENTONVILLE, AR 72716

DRAWN BY	CHECKED BY

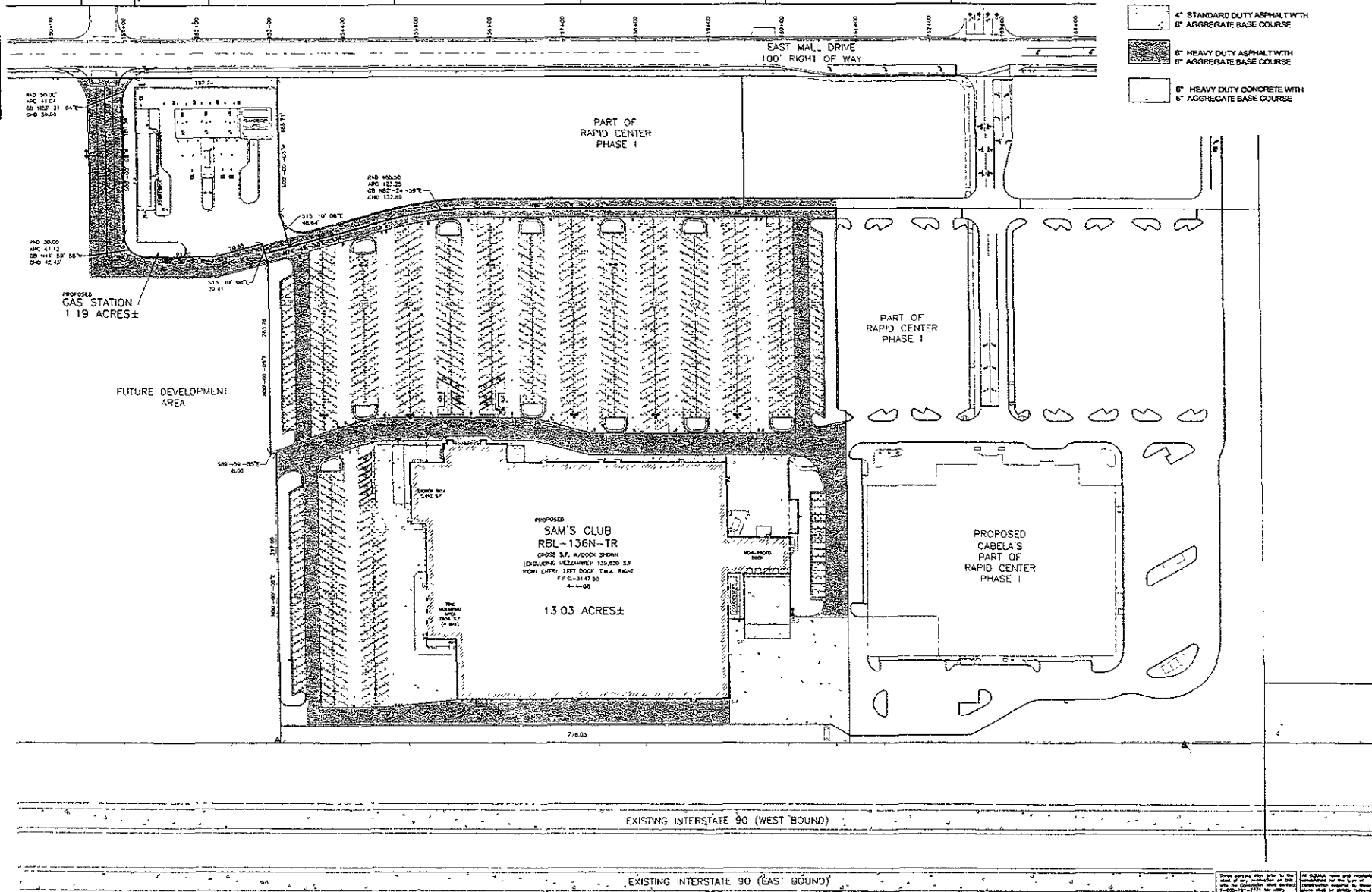

These drawings were prepared by the undersigned for the use of the client and are not to be used for any other purpose without the written consent of the undersigned.