

LANDSCAPE REQUIREMENTS:

- 1) MAINTAIN EXISTING LANDSCAPING AND PLANTINGS
- 2) NEW ADDITION TAKES UP 1,012 S.F. OF SITE
- 3) 1,012 LESS LANDSCAPING POINTS REQUIRED, BUT EXISTING WILL BE MAINTAINED

PARKING REQUIREMENTS:

ORIGINAL REQUIRED = 12 SPACES
OFFICE ADDITION = 5 SPACES
TOTAL REQUIRED = 17 SPACES

SPACES PROVIDED
1 EXISTING
10 NEW SPACES
17 SPACES PROVIDED

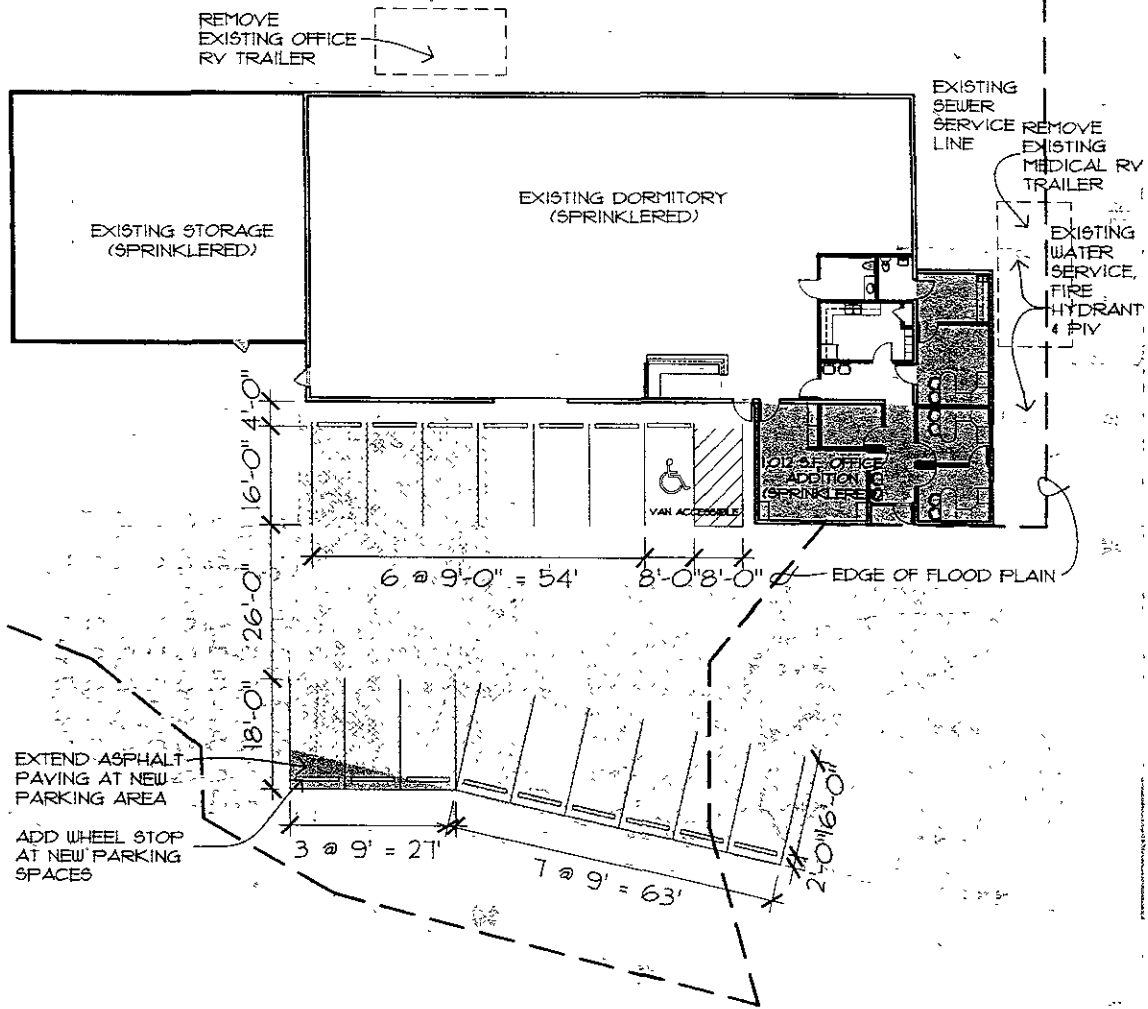

1 SITE PLAN
ALL 1"=20'-0"
NORTH

LOT 1
SOUTH CREEK
INDUSTRIAL PARK

DATE	APR. 25 2008
PROJECT MANAGER	DONOVAN BROBERG
PROJECT NUMBER	2007-028
REVISIONS	

SD DOC TRUSTEE
RAPID CITY, SOUTH DAKOTA

SITE PLAN

A1.1