

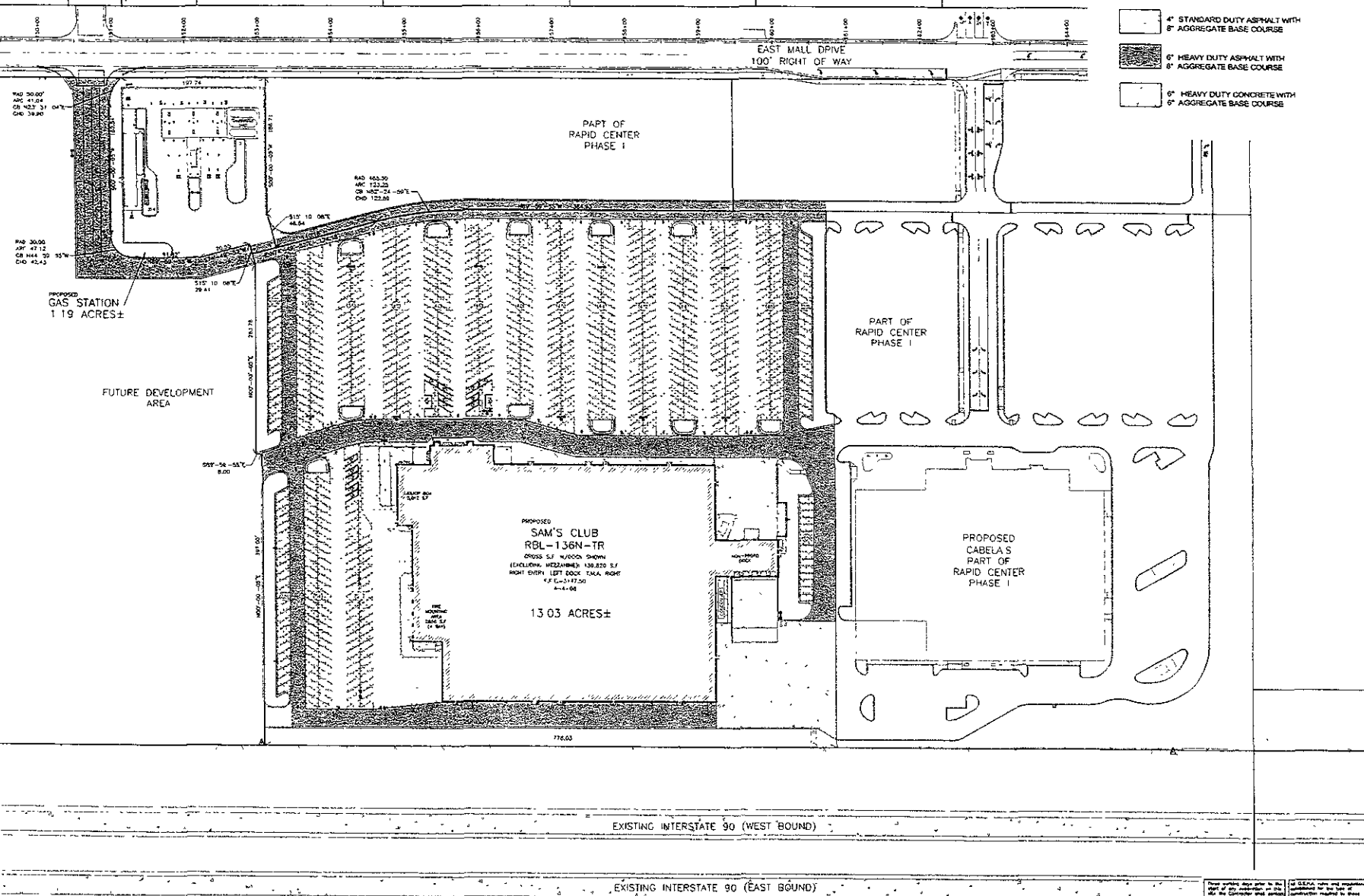

PAVEMENT LEGEND

- 4" STANDARD DUTY ASPHALT WITH 8" AGGREGATE BASE COURSE
- 6" HEAVY DUTY ASPHALT WITH 8" AGGREGATE BASE COURSE
- 6" HEAVY DUTY CONCRETE WITH 8" AGGREGATE BASE COURSE

REVISIONS	
1	DATE
2	DATE
3	DATE
4	DATE
5	DATE



BFA
CONSULTING ENGINEERS ARCHITECTS
1015 W. STATE STREET
BENTONVILLE, AR 72716

PRELIMINARY DRAWING
FOR REVIEW PURPOSES ONLY
NOT TO BE USED FOR CONSTRUCTION

SAM'S CLUB #6565-09
RAPID CITY, PENNINGTON COUNTY, SD
SAM'S WEST, INC. 2001 SE 10TH ST.
BENTONVILLE, AR 72716

DATE	BY	REVISION

PROJECT NAME: PA-6565-09 PLAN

These drawings were prepared by the staff of the engineering firm of BFA Consulting Engineers, Inc. and are not to be used for construction without the approval of the engineer of record, BFA Consulting Engineers, Inc., Bentonville, Arkansas.