

EXISTING EAST MAIN DRIVE (DD ROW)

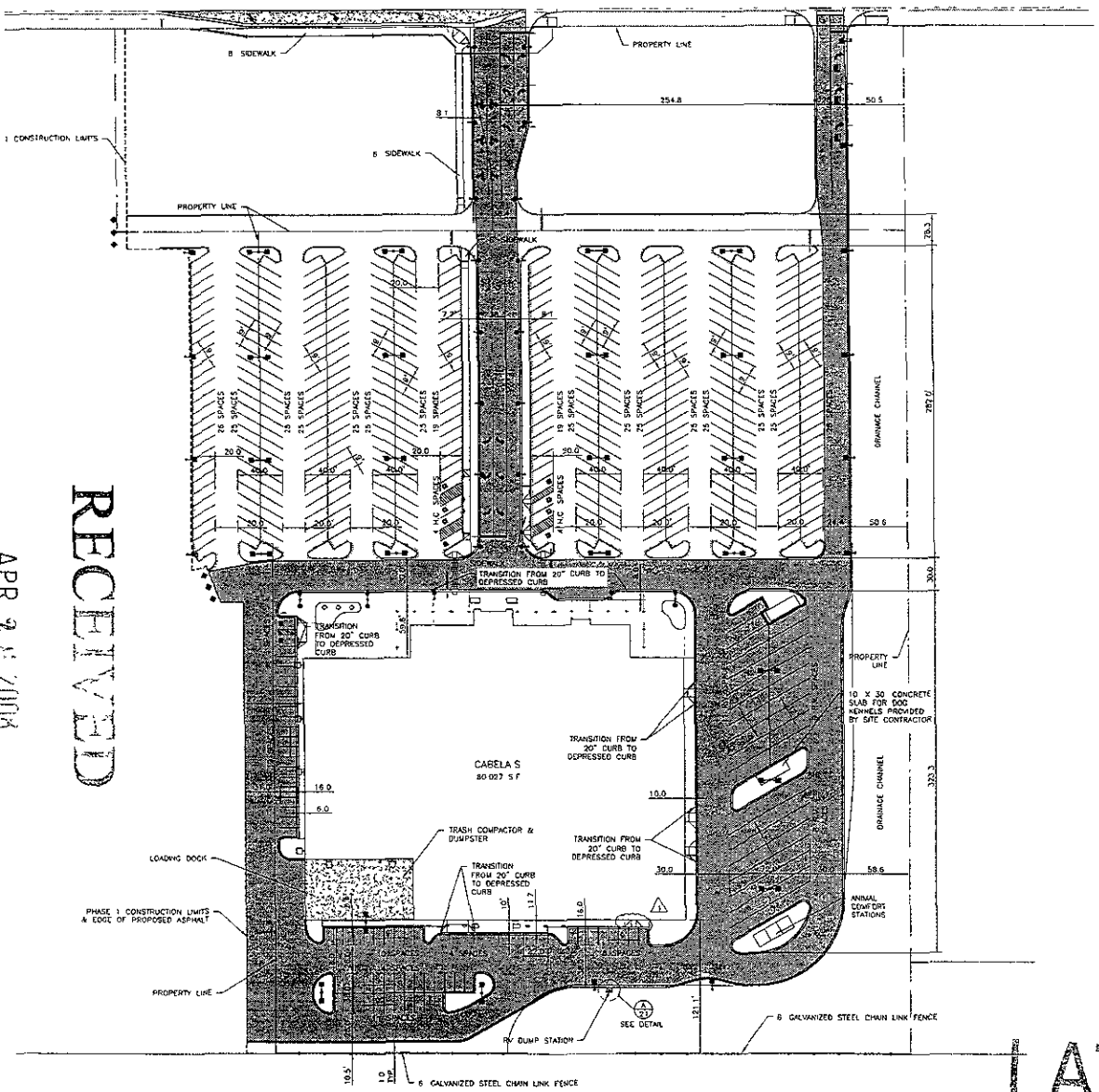

CITY OF RAPID CITY
GROWTH MANAGEMENT DEPT
DEVELOPMENT SERVICES

Plans are prepared for general compliance with applicable governmental regulations. No warranty, express or implied, is made by the City of Rapid City. The City of Rapid City does not carry the liability of design or construction of the project or any part thereof. All necessary permits shall be obtained prior to construction per project's public approvals.

Engineering: [Signature] Date: [Blank]

DREAM DESIGN INTERNATIONAL, INC.
CIVIL ENGINEERING, LANDSCAPE ARCHITECTURE
LAND DEVELOPMENT, CONSTRUCTION ADMINISTRATION



PRELIMINARY FOR REVIEW ONLY

LEGEND

- HEAVY-DUTY PAVEMENTS - 6" ASPHALT WITH 6" AGGREGATE BASE COURSE
- LIGHT-DUTY PAVEMENTS - 5" ASPHALT WITH 6" AGGREGATE BASE COURSE
- LOADING DOCK PAVEMENT - BY BLDG CONTRACTOR REFER TO ARCHITECTURAL DRAWINGS
- LIGHT POLE - BY OTHERS

NOTES

- ALL SIDEWALKS ON THIS PROJECT SHALL BE 4" THICK WITH 2" GRAVEL CUSHION
- ALL DIMENSIONS ARE TO FACE OF CURB OR TO EDGE OF STRIPING
- FOR CURB RADI INFORMATION SEE THE SITE LAYOUT & STRIPING PLAN
- PARKING SUMMARY:**
 - TOTAL PARKING REQUIRED = 400 (5 SPACES/1000 SF)
 - TOTAL PARKING PROVIDED = 485 SPACES
 - 28 S.W. SPACES
 - 10 H.C. SPACES
 - H.C. PARKING REQUIRED = 10 (2% OF 504 SPACES)
 - H.C. PARKING PROVIDED = 10 SPACES

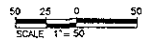
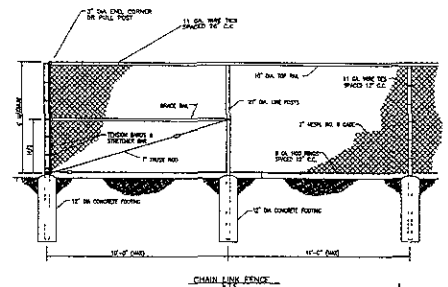

RECEIVED

APR 23 2008

LATE SUBMITTA

EXISTING PCD #1

| FROM | AS NOTED |
|-------------------------|------------------|
| Dimension by TC | Dimension by DM |
| Change by 1802 | Print by 1002 |
| Internal job No 07-0451 | Sheet Date 05-07 |
| Reviewed by ARLETH | Sheet Date 05-07 |
| Drawn by | |

RAPID CENTER PHASE I

Sheet Title: SITE PLAN EXISTING PCD
Date: 1 of 1