

SITE PLAN

SCALE: 1" = 50'
SEPTEMBER, 2000

- NOTES:
- The Contractor is specifically cautioned that the location of all structures, including the proposed expansion, shall be based on the location of the proposed utility lines and shall be set back from the utility lines as shown on this plan. The Contractor is to be responsible for the location of all utility lines and shall be responsible for the location of all utility lines and shall be responsible for the location of all utility lines.
 - All structures under proposed expansion shall be installed with granite masonry and conform to the most current requirements for the concrete to be used.
 - All unshaded areas are to remain the same as shown. Contractor to seal, repair, and finish of areas within of shaded areas that were disturbed during construction and an appropriate repair of same is indicated.
 - Contractor shall refer to architectural plans for exact locations and dimensions of verticals, signs, posts, curbs, ramps, stairs, etc. and shall be responsible for the installation and the setting of all utility lines and shall be responsible for the location of all utility lines.
 - Formwork shall be placed perpendicular to the finished columns on parking lot.
 - Formwork shall be placed in concrete slabs with the top surface to be the finished surface as shown on this plan.
 - The scope for this project shall include the installation of the proposed expansion and the proposed expansion.
 - Special Note: Dimensions are based on the City of Rapid City Benchmark Monument No. 133, located at the northeast corner of the intersection of Broadway Street and La Crosse Street with a published elevation of 3275.57.
 - Attention to building convention. The water pressure and flow collected on the sprinkler riser pipe is on footcandle. Minimum Static Pressure 8.5 psi. Minimum Pressure = 23 psi @ 150 gpm flow.
 - The areas shaded shown on this set of plans shall be considered the minimum excavation for the project. There may be additional areas shaded shown on the actual construction drawings which shall be used by the Contractor as reference for excavation and maintaining of all of the man-holes from this site. In a manner which shall be approved by the City of Rapid City.
 - Sanitary basins shall be constructed of Polypropylene (PP) Pipe. ASTM D 3034, 18" dia. 36".
 - All existing parking shall be shown with white paint and shall be to be marked yellow with orange cones.
 - Refer to architectural plans for site lighting electrical plan.
 - Contractor to coordinate installation of conduit into existing man-holes in the local installation for the service shown.
 - Contractor to make sure station open for business during all phases of construction.

PARKING SPACES

WAL-MART EXISTING - 886 SPACES = 2.68 SPACES / 1000 SQ. FT.
WAL-MART PROPOSED - 1129 SPACES = 3.1 SPACES / 1000 SQ. FT.
GOLDEN CORRAL PROPOSED - 115 SPACES = 3.28 SPACES / 1000 SQ. FT.



Raymond H. Frantzenberg, P.E. #5688
Registered Professional Engineer
for Bluestar Frantzenberg Associates, Inc.

SITE PLAN
PROPOSED WAL-MART EXPANSION
RAPID CITY, PENNINGTON CO., S.D.
BLUESTAR FRANTZENBERG ASSOCIATES, INC.

ALL DIMENSIONS AND LOCATIONS SHOWN ON THIS PLAN ARE TO BE USED BY THE CONTRACTOR FOR THE PROPOSED EXPANSION AND SHALL BE RESPONSIBLE FOR THE LOCATION OF ALL UTILITY LINES AND SHALL BE RESPONSIBLE FOR THE LOCATION OF ALL UTILITY LINES.

DATE	10-11-00	NO.	05-2147A
BY		DATE	
APPROVED BY		DATE	

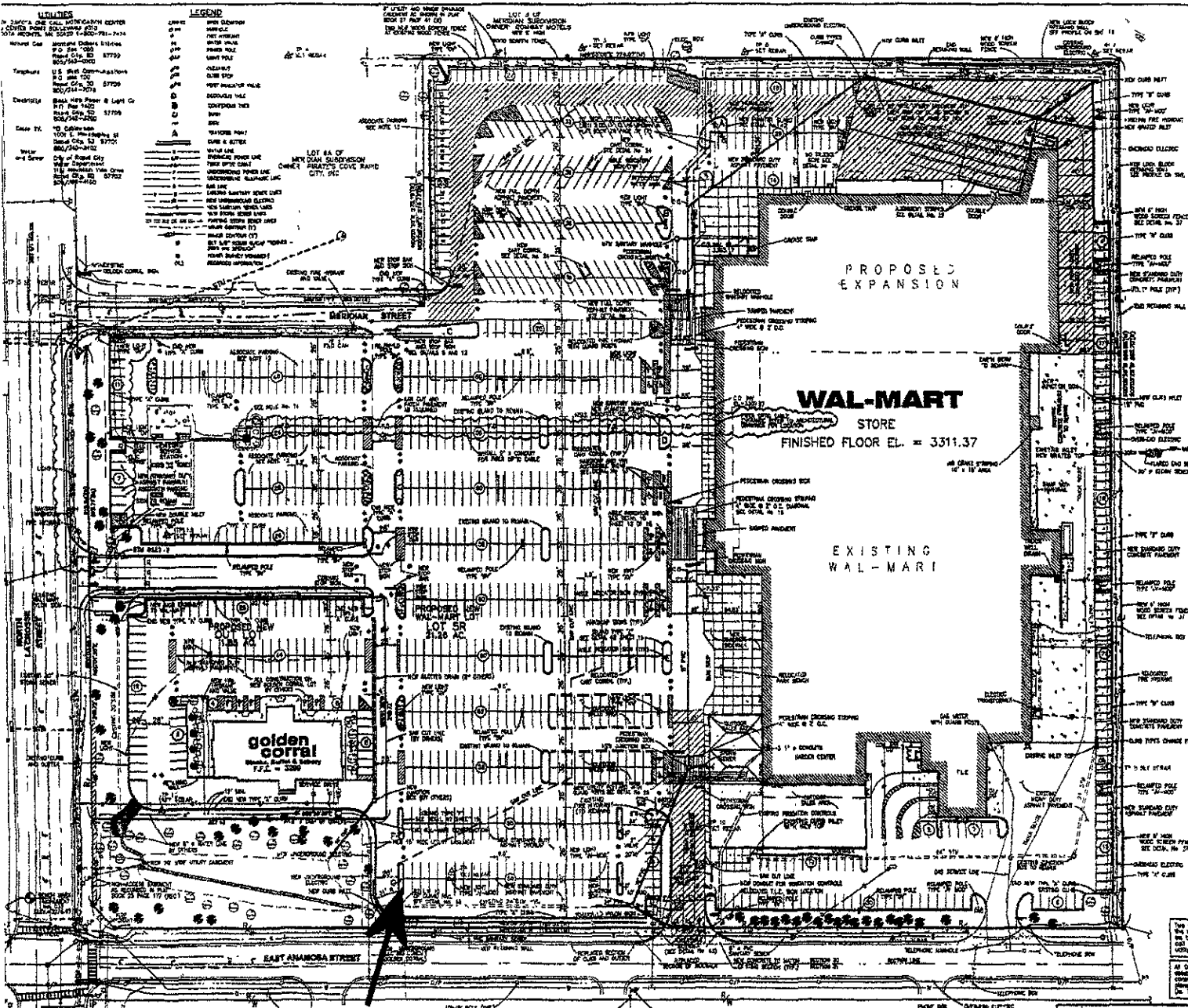

Island G

CURRENT SITE PLAN