

POLENZ LAND SURVEYING

3412 MEADOWBROOK DRIVE, RAPID CITY, SD 57702

PHONE: 605-342-6155 FAX: 605-348-1621



SCALE 1"=20'

FRANKLIN STREET

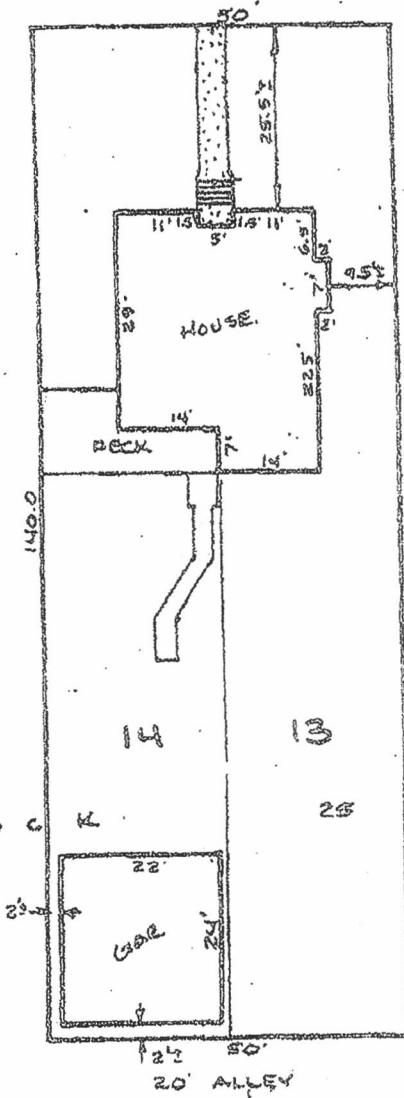

IMPROVEMENT LOCATION EXHIBIT

The purpose of this exhibit is to provide a representation of the information gathered at the time of the inspection for the interested parties. This exhibit is based on existing but not confirmed boundary evidence and is subject to any inaccuracies that a boundary survey might reveal. No property corners will be set and no warranty as to the location of the true boundary of the subject property is extended herein to the present or future owners or occupants.

LEGAL DESCRIPTION

Lots 13 and 14 in Block 25 of Flormann Addition to the City of Rapid City, Pennington County, South Dakota.

Erika Randall-727 Franklin

SURVEYOR'S CERTIFICATE

I, the undersigned, do hereby certify that I have surveyed the above described property and that the information shown hereon is an accurate representation of the information gathered at the time of inspection of the subject property.



Mark J. Polenz
Mark J. Polenz, S.D. Reg. No. 4208

Project # 98-386 Date: 7/20/98 Surveyed by: SEV Drawn by MJP

Title work | | was was not provided at time of survey order.

(4)