

STRUCTURAL EXHIBIT

LOT 1 OF JOSEPH'S SUBDIVISION

LOCATED IN NW1/4 OF NW1/4,
SECTION 13, T1N, R6E, BHM
PENNINGTON COUNTY, SOUTH DAKOTA



JULY 23, 2015
0 50' 100'
SCALE: 1" = 100'

WEST HIGHWAY 44
RIGHT-OF-WAY OF RECORD

40'X40' COMMON
ACCESS EASEMENT
AS RECORDED IN
BOOK 34, PAGE 177

LOT A

66' WIDE
SECTION LINE
RIGHT-OF-WAY

N89°35'29"E 659.47'

SECTION LINE

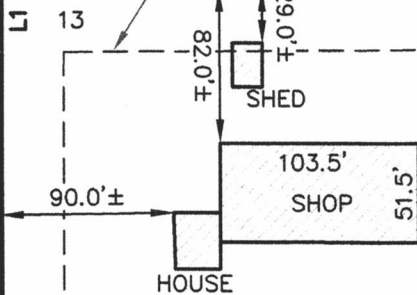

RECEIVED

JUL 31 2015

Rapid City Community Planning
& Development Services

LOT 1

10.081 Acres ±

SEPTIC

APPROXIMATE
DRAIN FIELD

WELL

N00°03'12"E 632.21'

S00°00'02"W 665.74'

LINE	BEARING	DISTANCE
L1	N00°06'05"W	33.33'



RENNER ASSOCIATES, LLC
CIVIL ENGINEERING · LAND SURVEYING

616 SIXTH STREET PH: 605. 721-7310
RENNERASSOC.COM RAPID CITY, SD 57701 FX: 605. 721-7313

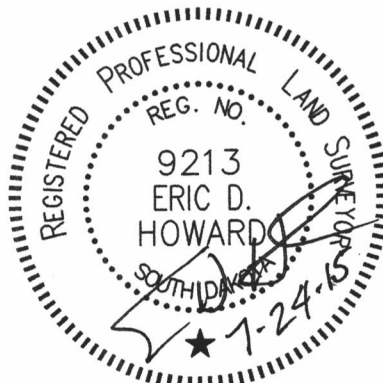

S:\2097.01 THEBERGE PLAT\STRUCTURE EXHIBIT.dwg, 7/24/2015 7:24:07 AM