



CITY OF RAPID CITY

RAPID CITY, SOUTH DAKOTA 57701

Public Works Department Engineering Services Division

300 Sixth Street
Telephone: (605) 394-4154 FAX: (605) 355-3083
Web: www.rcgov.org

Nicole Lecy, Project Engineer
Public Works Department
city web: www.rcgov.org

Phone: 605-394-4154
Fax: 605-355-3083
e-mail: nicole.lecy@rcgov.org

MEMORANDUM

TO: Terry Wolterstorff, Public Works Director and Public Works Committee

From: Nicole Lecy, Engineering Project Engineer

Date: September 14, 2012

Re: Infrastructure Acceptance
East Stumer Road Extension Phase 5B-1

City File #: 12PL002, 12PL055, DEV12-1075

This letter is to confirm that the East Stumer Road Extension Phase 5B-1 Infrastructure Improvements have been completed, tested, record drawings submitted and the warranty surety has been received and the project can be accepted.

Per Rapid City Ordinance 12.04.170(B)

"Infrastructure Acceptance – The Public Works Director shall place on the public Works Committee agenda an action item recommending acceptance of infrastructure when the project as a whole is ready for acceptance."

Please let me know if there are any questions or need for additional information.

Sincerely,

Nicole Lecy
Project Engineer



Legend

- Roads
 - Not classified
 - Interstate
 - US Highway
 - SD Highway
 - County Highway
 - Main Road
 - Minor Arterial
 - Collector
 - Ramp
 - Paved Road
 - Unpaved Road
 - FS Unpaved Road
 - Driveway
 - Paved Alley
 - Unpaved Alley
 - Unimproved Road
 - Trail
 - Not yet coded
- Township/Section Lines
 - 0
 - 7
- Tax Parcels
- Lot Lines
 - <all other values>
 - Lot Line
 - Parcel Line
- County Line

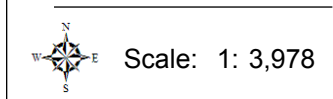
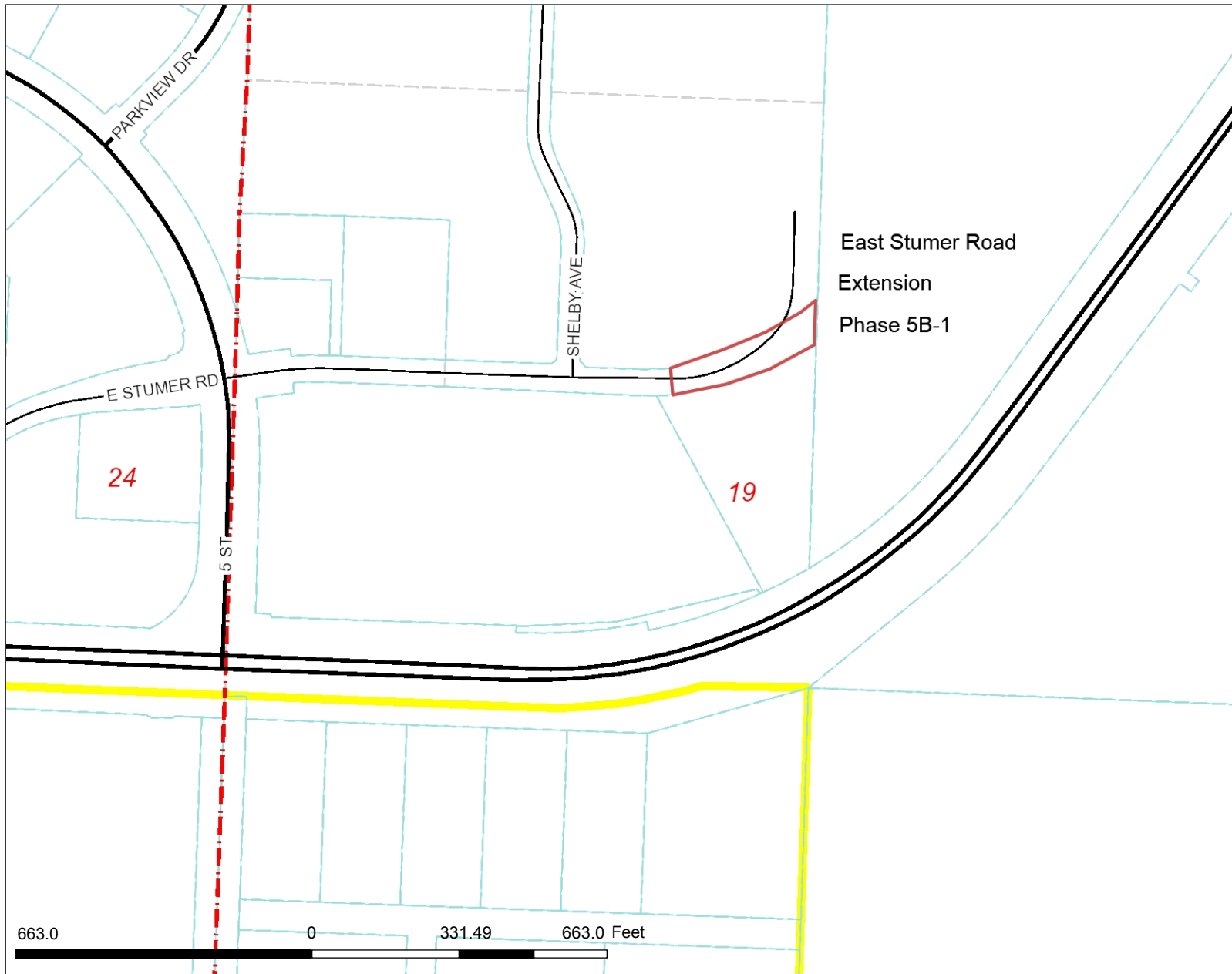

Map Notes:

DISCLAIMER: This map is provided 'as is' without warranty of any representation to accuracy, timeliness, or completeness. The burden for determining accuracy, completeness, timeliness, merchantability, and fitness for or the appropriateness for use rests solely on the user. Rapid City and Pennington County make no warranties, express or implied, as to the use of the map. There are no implied warranties of merchantability or fitness for a particular purpose. The user acknowledges and accepts the limitations of the map, including the fact that the data used to create the map is dynamic and is in the constant state of maintenance, correction, and update. This documents does not represent a legal survey of the land. There are no restrictions on the distribution of printed Rapid City/Pennington County maps, other than the City of Rapid City copyright/credit notice must be legible on the print. The user agrees to recognize and honor in perpetuity the copyrights and other proprietary claims for the map(s) established or produced by the City of Rapid City or the vendors furnishing said items to the City of Rapid City.