

# RECEIVED

SEP 07 2000

Rapid City  
Planning Department

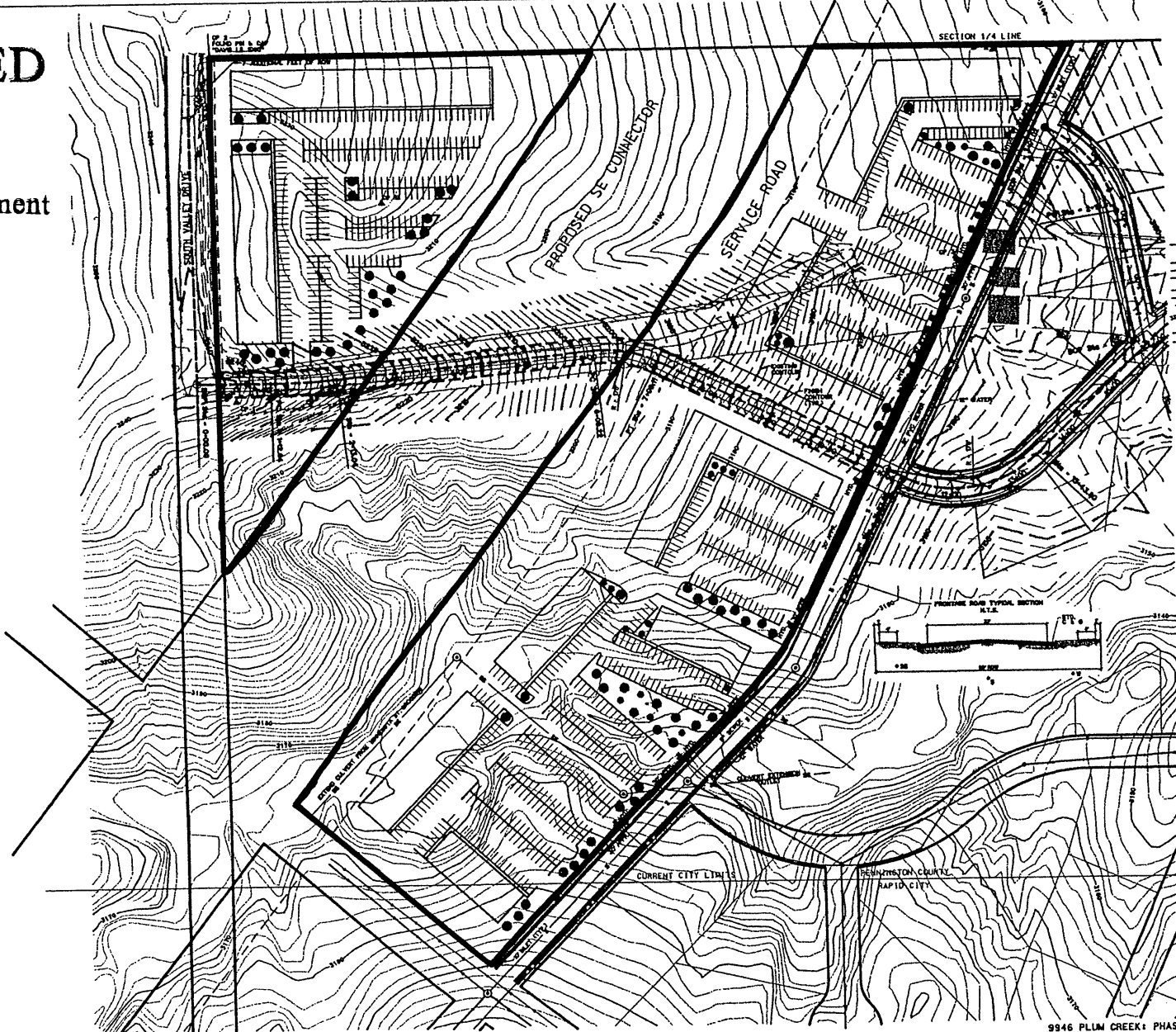

00PL095



### LEGEND

[Symbol]	Building Footprint
[Symbol]	Parking Space
[Symbol]	Carport
[Symbol]	Proposed SE Connector
[Symbol]	Service Road
[Symbol]	Section 1/4 Line
[Symbol]	Current City Limits
[Symbol]	Sioux County
[Symbol]	Rapid City
[Symbol]	Proposed SE Connector
[Symbol]	Service Road
[Symbol]	Section 1/4 Line
[Symbol]	Current City Limits
[Symbol]	Sioux County
[Symbol]	Rapid City

### NOTES:

Indicated the plan to meet requirements of Rapid City Planning and Landmarks Ordinance.

Coordinate layout location with Rapid City Fire Department.

24 foot setback subject to building.

9946 PLIM CREEK: PHASE C1 1:60 LAYOUT

	<b>CENTERLINE</b>	project no.: 9946C1
	220 W. 10th Street, Suite 100, Rapid City, SD 57701	date: 09-04-2000
	tel: 605.342.3333 fax: 605.342.3334	title: 1465PL03-00A
	www.centerline.com	sheet: 1 OF 1