

**LOCATION MAP**  
NOT TO SCALE  
THE SITE IS LOCATED IN THE SW/4 OF THE NE/4, OR AKA IN THE SW/4 OF THE NE/4 AND IN THE SE/4 OF THE NE/4, SECTION 24, T4N, R7E, B1W, RAPID CITY, PENNINGTON COUNTY, SOUTH DAKOTA.

**Wolverton & Associates**  
Consulting Engineers + Land Surveyors  
1015 S. Main Street, Suite 300R  
Rapid City, SD 57701-4470  
Phone: 605.373.4470  
Fax: 605.373.4470  
www.wolverton-associates.com

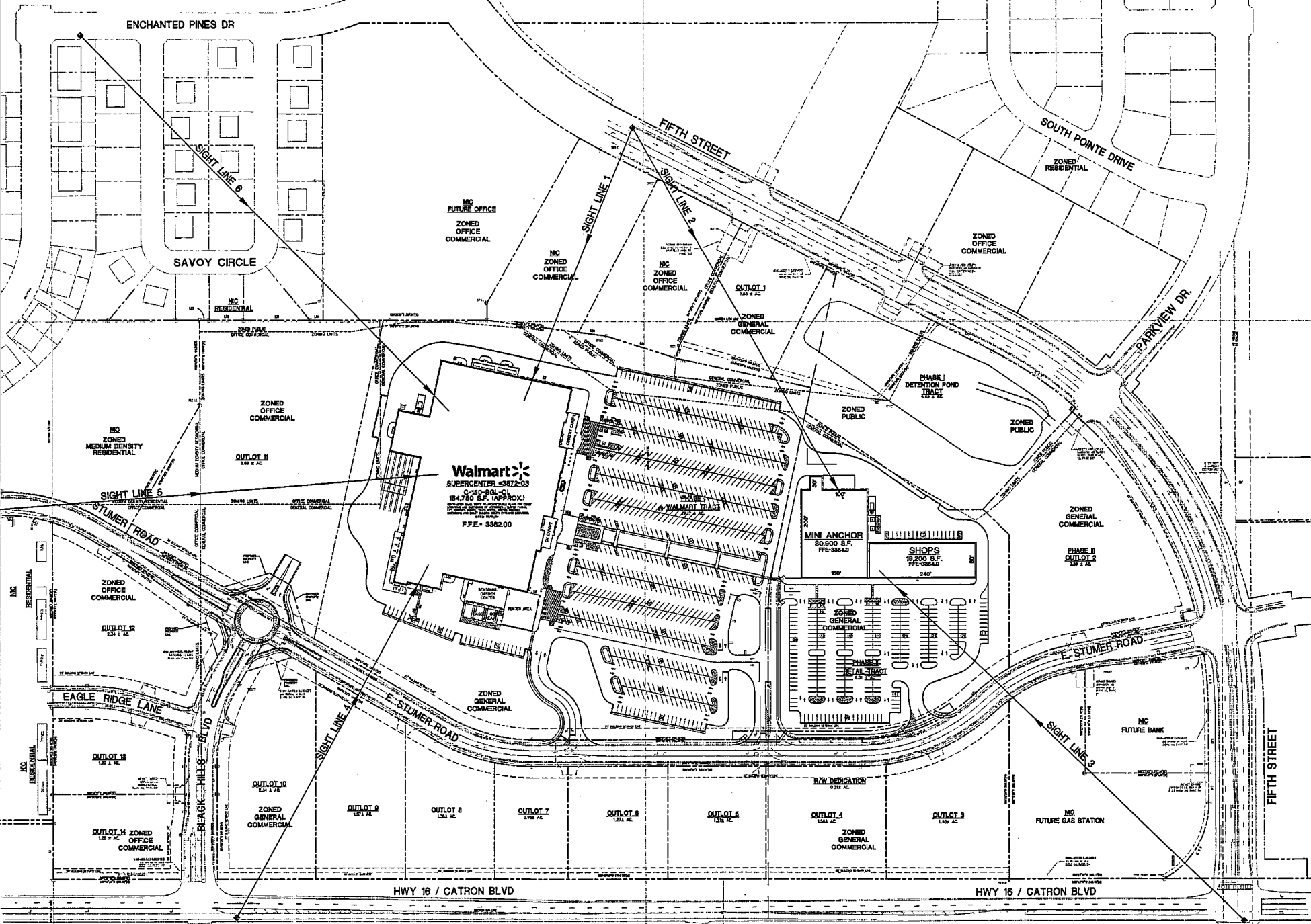

**PROPOSED BLACK HILLS CENTER**  
**Walmart Supercenter #3872-03**  
**RAPID CITY, PENNINGTON COUNTY, S.D.**  
**BY: THF. STONERIDGE DEVELOPMENT, LLC**  
**ST. LOUIS, MO**

| REVISIONS | BY |
|-----------|----|
|           |    |
|           |    |
|           |    |
|           |    |
|           |    |
|           |    |
|           |    |
|           |    |
|           |    |

DRAWN BY: DMN  
CHECKED BY: KJW  
DATE: 03/18/2019  
SCALE: 1" = 100'  
JOB NO.: 08-140  
SHEET NUMBER:

**SL-1**  
OF SHEETS

**SIGHT LINES PLAN**

