



Rapid City Girls Junior Olympic ASA Fastpitch Softball



RAPID CITY ASA NEW FIELDS

VISION 2012 UPDATE REPORT

March 20, 2013



Rapid City Girls Junior Olympic ASA Fastpitch Softball



GENERAL LEAGUE UPDATE

Rapid City ASA has been experiencing growth every year since its inception. The number of players registered in 2011 was 571. In 2012 it rose to 631. And this year, we have registered 700 girls, ages 4 to 19 on 60 teams. While this is a very nice gesture to the quality of our program, we don't have enough fields to fully accommodate field time for the numbers of girls we have.

This year, after years of effort, Rapid City will be hosting the State 'B' division ASA girls' fastpitch softball tournament for the first time. We expect approximately 30 out-of-town teams, or approximately 1,350 people to attend this three-day event in July.

We have received confirmation that, as long as we have six fields, our complex will host the Special Olympics State Softball Tournament in 2014, 2015 and 2016. Approximately 40 teams are expected to participate in this event.

And finally, we will be hosting the women's Senior Games softball tournament this year.

Our basic financials for 2012 were:

Income	\$147,387
Expenses	\$117,697

PROJECT STATUS

Since approval of our application for Vision 2012 funding, we have assisted the City with selecting the design team for the project. After review of qualification submissions and interviewing candidates, we selected the team of Designworks, Inc. (landscape architect), Ferber Engineering (civil engineer) and West Plains Engineering (electrical engineer).

We have been meeting on a regular basis to identify our needs and develop the design.

Not anticipated prior to this process was the need to mitigate Wetlands, which have been naturally established in the location of the new fields. The US Army Corps of Engineers requires the submittal of an application for mitigation, or relocation, of the Wetlands areas. This is a State and Federal review of the civil engineers "Wetland Delineation and Mitigation Report", which was submitted a couple of weeks ago.



Rapid City Girls Junior Olympic ASA Fastpitch Softball

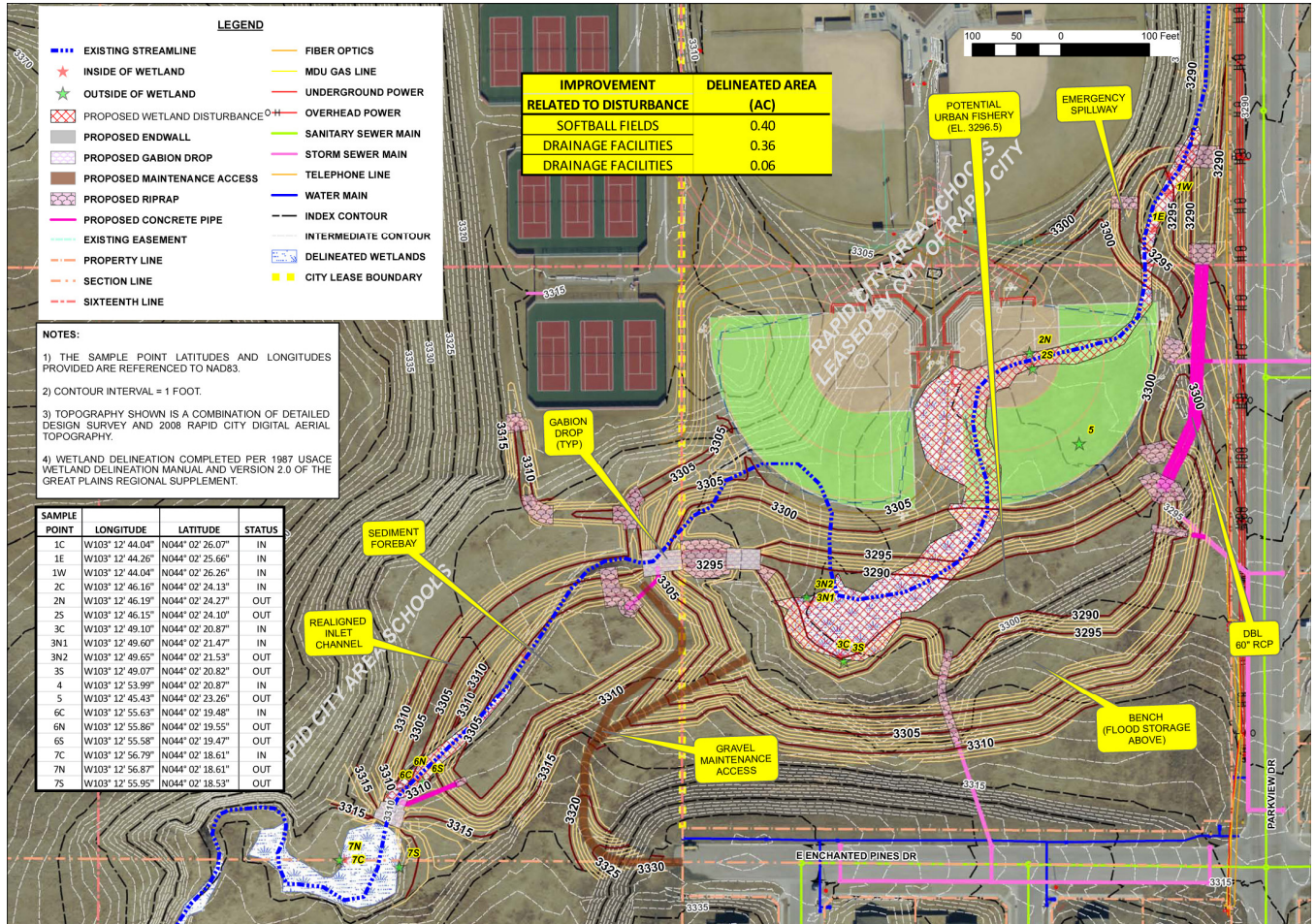

Wetlands Delineation Plan – Ferber Engineering

Schedule

The civil drawings and specifications for the project are essentially done, barring any changes that come out of the Corps review. The landscape and electrical drawings and specifications are 85% complete and have been submitted to the City for review. The designers expect the final Construction Documents could be completed and ready for bidding at the end of April. However, because of the 0.8 acres +/- of wetland disturbance, the USACE will have to issue an Individual Permit for this project. The IP process requires advertisement for 15 days and then a 30-day public comment period. They anticipate that the process will start on April 1, 2013. A conservative estimate for completion of this approval process is August 1st. This process must be completed before construction can start.



Rapid City Girls Junior Olympic ASA Fastpitch Softball



We expect the majority of the construction to take four months to complete. We may or may not be able to install sod in the fall. If not, we will have to wait until spring, which would mean that the fields would not be playable until June.

Budget

ASA Softball - Parkview Addition Opinion of Probable Construction Cost

ASA Softball Fields - Parkview Addition		
Item No.	Description	Preliminary Estimate
1 .	Parking Area Improvements	= \$ 180,000
2 .	Storm Detention Area	= \$ 652,000
3 .	Site Electrical & Field Lighting	= \$ 200,000
4 .	Site Pavement & Concrete Work	= \$ 64,000
5 .	Fencing & Backstops	= \$ 80,000
6 .	Infield Surface Material	= \$ 48,000
7 .	Irrigation System	= \$ 40,000
8 .	Field Soil Prep & Sod	= \$ 60,000
9 .	Stadium Area Landscaping	= \$ 48,000
10 .	Dugouts & Field Accessories	= \$ 32,000
11 .	Construction Services	= \$ 40,000
12 .	Contingency	= \$ 76,000

Opinion of Probable Construction Costs = \$ 1,520,000

Design Fees = \$ 120,000

Total = \$ 1,640,000



Rapid City Girls Junior Olympic ASA Fastpitch Softball



According to the latest Opinion of Probable Construction Cost prepared by the design team, our project is currently about \$440,000 over our \$1.2M Vision 2012 funding allocation. This overage also includes design fees, which were not accounted for in the original estimate.

While there are multiple contributing factors for the variance, we believe the largest to be that the original estimate was done with limited information and no design to estimate.

Some of the largest variations between the estimate in the original Vision 2012 proposal and the Designer's Opinion of Probable Construction Cost are as follows:

	Current Estimate	Proposal Estimate	Add
Design fees	\$120,000	\$0	\$120,000
Parking:	\$180,000	\$150,000	\$30,000
Detention Pond	\$652,000	\$535,000	\$117,000
Lighting, electrical	\$200,000	\$90,000	<u>\$110,000</u>
			\$377,000

We have learned that the Game, Fish and Parks has funding available for wetlands recreation. They may contribute toward the drainage portion of the project if the design includes ponds that can be stocked with fish in order to create urban fishing areas. However, at this time, we have only been given a possible range of \$25,000 to over \$100,000, and the contribution would come in the form of a reimbursement in 2014 or 2015.

As part of this update, we would like to request an additional \$440,000 to complete the funding of this important project.

Rapid City Girls Junior Olympic ASA Fastpitch Softball thanks the Vision Fund Committee, City Council and Mayor Kooiker for their continued support.

File: PA12-13A(S)MMD11X17 proposed wetlands disturbance EXHIBIT.mxd Date: 3/4/2013

LEGEND

EXISTING STREAMLINE

INSIDE OF WETLAND

OUTSIDE OF WETLAND

PROPOSED WETLAND DISTURBANCE

PROPOSED ENDWALL

PROPOSED GABION DROP

PROPOSED MAINTENANCE ACCESS

PROPOSED RIPRAP

PROPOSED CONCRETE PIPE

EXISTING EASEMENT

PROPERTY LINE

SECTION LINE

SIXTEENTH LINE

FIBER OPTICS

MDU GAS LINE

UNDERGROUND POWER

OVERHEAD POWER

SANITARY SEWER MAIN

STORM SEWER MAIN

TELEPHONE LINE

WATER MAIN

INDEX CONTOUR

INTERMEDIATE CONTOUR

DELINEATED WETLANDS

CITY LEASE BOUNDARY

NOTES:

1) THE SAMPLE POINT LATITUDES AND LONGITUDES PROVIDED ARE REFERENCED TO NAD83.

2) CONTOUR INTERVAL = 1 FOOT.

3) TOPOGRAPHY SHOWN IS A COMBINATION OF DETAILED DESIGN SURVEY AND 2008 RAPID CITY DIGITAL AERIAL TOPOGRAPHY.

4) WETLAND DELINEATION COMPLETED PER 1987 USACE WETLAND DELINEATION MANUAL AND VERSION 2.0 OF THE GREAT PLAINS REGIONAL SUPPLEMENT.

SAMPLE POINT	LONGITUDE	LATITUDE	STATUS
1C	W103° 12' 44.04"	N044° 02' 26.07"	IN
1E	W103° 12' 44.26"	N044° 02' 25.66"	IN
1W	W103° 12' 44.04"	N044° 02' 26.26"	IN
2C	W103° 12' 46.16"	N044° 02' 24.13"	IN
2N	W103° 12' 46.19"	N044° 02' 24.27"	OUT
2S	W103° 12' 46.15"	N044° 02' 24.10"	OUT
3C	W103° 12' 49.10"	N044° 02' 20.87"	IN
3N1	W103° 12' 49.60"	N044° 02' 21.47"	IN
3N2	W103° 12' 49.65"	N044° 02' 21.53"	OUT
3S	W103° 12' 49.07"	N044° 02' 20.82"	OUT
4	W103° 12' 53.99"	N044° 02' 20.87"	IN
5	W103° 12' 45.43"	N044° 02' 23.26"	OUT
6C	W103° 12' 55.63"	N044° 02' 19.48"	IN
6N	W103° 12' 55.86"	N044° 02' 19.55"	OUT
6S	W103° 12' 55.58"	N044° 02' 19.47"	OUT
7C	W103° 12' 56.79"	N044° 02' 18.61"	IN
7N	W103° 12' 56.87"	N044° 02' 18.61"	OUT
7S	W103° 12' 55.95"	N044° 02' 18.53"	OUT

IMPROVEMENT RELATED TO DISTURBANCE	DELINEATED AREA (AC)
SOFTBALL FIELDS	0.40
DRAINAGE FACILITIES	0.36
DRAINAGE FACILITIES	0.06

The map shows a topographic area with contour lines ranging from 3290 to 3335 feet. Key features include:

- Wetland Delineation:** Areas marked as 'INSIDE OF WETLAND' (red stars) and 'OUTSIDE OF WETLAND' (green stars). A large area is marked 'DELINEATED WETLANDS' with a blue hatched pattern.
- Engineering Features:** Includes 'PROPOSED CONCRETE PIPE' (thick pink line), 'PROPOSED GABION DROP' (pink hatched area), 'PROPOSED RIPRAP' (pink dotted area), 'PROPOSED MAINTENANCE ACCESS' (brown area), 'PROPOSED ENDWALL' (grey area), 'PROPOSED WETLAND DISTURBANCE' (red hatched area), 'PROPOSED EASEMENT' (green dashed line), 'PROPERTY LINE' (orange dashed line), 'SECTION LINE' (orange dotted line), and 'SIXTEENTH LINE' (red dashed line).
- Infrastructure:** Shows 'FIBER OPTICS' (orange line), 'MDU GAS LINE' (yellow line), 'UNDERGROUND POWER' (red line), 'OVERHEAD POWER' (red line), 'SANITARY SEWER MAIN' (green line), 'STORM SEWER MAIN' (pink line), 'TELEPHONE LINE' (orange line), and 'WATER MAIN' (blue line).
- Other Features:** Includes 'INDEX CONTOUR' (black line), 'INTERMEDIATE CONTOUR' (grey line), 'DELINEATED WETLANDS' (blue hatched area), 'CITY LEASE BOUNDARY' (yellow dashed line), 'POTENTIAL URBAN FISHERY (EL. 3296.5)' (yellow callout), 'EMERGENCY SPILLWAY' (yellow callout), 'GABION DROP (TYP)' (yellow callout), 'SEDIMENT FOREBAY' (yellow callout), 'REALIGNED INLET CHANNEL' (yellow callout), 'GRAVEL MAINTENANCE ACCESS' (yellow callout), 'BENCH (FLOOD STORAGE ABOVE)' (yellow callout), and 'DBL 60" RCP' (yellow callout).
- Scale and Orientation:** A scale bar shows 100, 50, 0, and 100 feet. A north arrow is located in the bottom right corner.
- Text Labels:** 'RAPID CITY AREA SCHOOLS LEASED BY CITY OF RAPID CITY' is written diagonally across the map.

Prepared For:



Prepared By:



Ferber Engineering Company, Inc.

Civil Engineering • Water Resources • Transportation • Land Surveying • GIS

779 East Wauwatosa St., Rapid City, SD 57701 • Phone: (605) 343-3311

W

N

E

S

ASA SOFTBALL - PARKVIEW ADDITION

CITY OF RAPID CITY PROJECT 12-2043 / CIP 50937

RAPID CITY, SD

PROPOSED WETLAND DISTURBANCE

FIGURE 3.1

03-4-4-13 P:\12-134\AutoCAD\PlanSheets\C2\ESC.dwg

LEGEND

	EXISTING FLOW DIRECTION
	SEDIMENT CONTROL WATTLE
	INLET PROTECTION DEVICE
	INLET PROTECTION
	TEMPORARY SEDIMENT TRAP
	VEHICLE TRACKING CONTROL
	CONCRETE WASHOUT AREA
	EROSION CONTROL BLANKET

NOTE:

THE INTENT OF THIS EROSION CONTROL LAYOUT IS TO PROVIDE GUIDANCE FOR SWPPP PREPARATION AND TO AID IN THE PROCESS OF OBTAINING THE NECESSARY CONSTRUCTION PERMITS. THE CONTRACTOR IS RESPONSIBLE FOR THE MEANS AND METHODS REQUIRED FOR IMPLEMENTING ANY AND ALL CONSTRUCTION ACTIVITIES TO BE IN COMPLIANCE WITH THE SWPPP AND ASSOCIATED PERMITS.

415 PARKVIEW DR
2 LESS LOT H1, LOT H2,
H3 & ROW, BLOCK 11,
ROBBINSDALE #10,
SECTION 13, T1N, R7E
(LOCAL AREA - SCHOOL)

4311 PARKVIEW DR
LOT 1 & LESS ROW, BLOCK 11,
ROBBINSDALE #10,
SECTION 13, T1N, R7E
JOHN D ENGER

4414 PARKVIEW DR
LOT 1R, CRAIG ESTATES,
SECTION 18, T1N, R8E
CHRISTOPH MALENIUS

4420 PARKVIEW DR
LOT 2R, CRAIG ESTATES,
SECTION 18, T1N, R8E
RICHIE C ANTONIO

4426 PARKVIEW DR
LOT 3R, CRAIG ESTATES,
SECTION 18, T1N, R8E
CORRIE WEISSER

40 20 0 40

CONTOUR INTERVAL = 1'

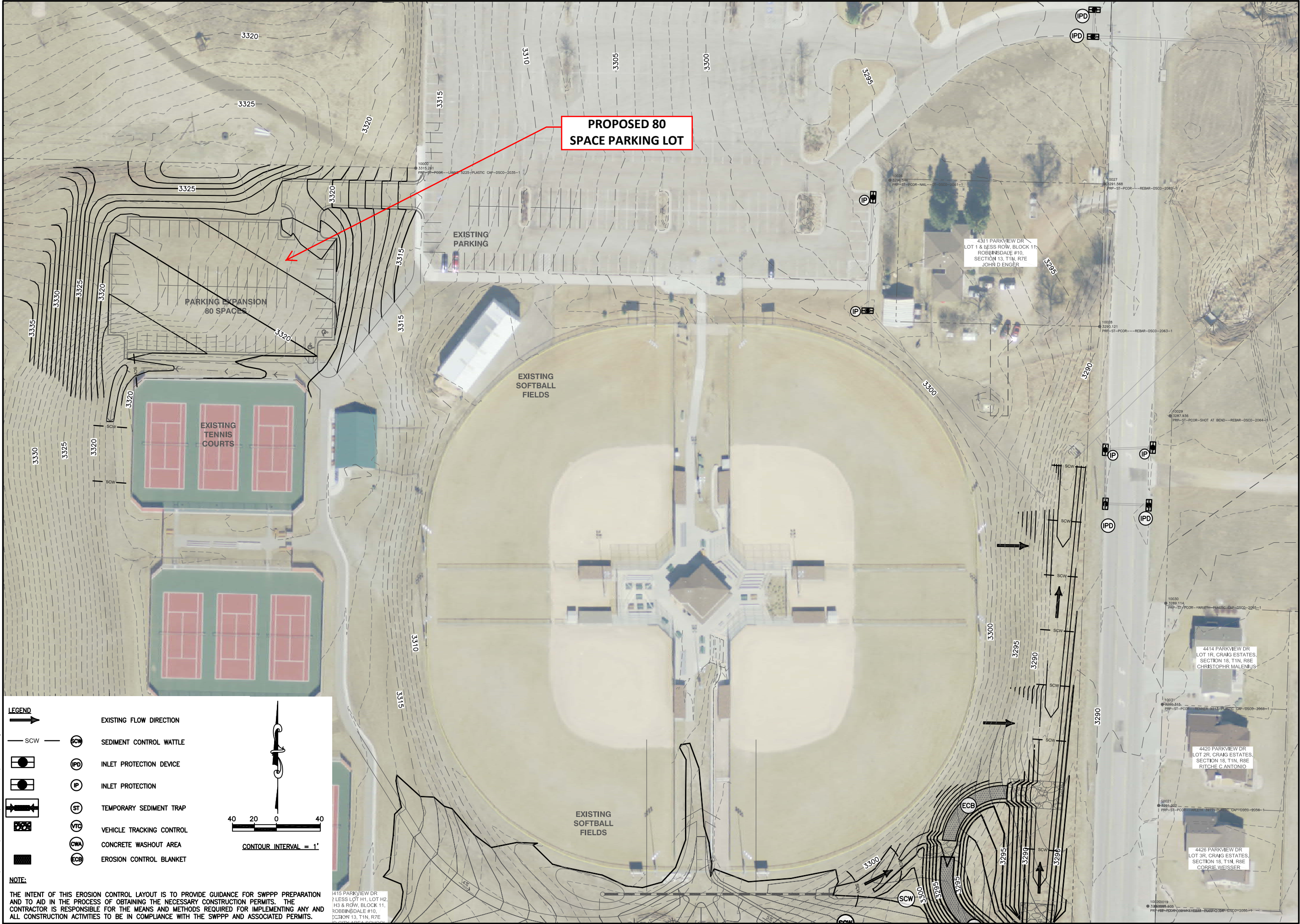

526 Saint Joseph St.
Suite B
Rapid City, SD 57701
Tele: 605/394-0394
Fax: 605/394-9588

NOT FOR CONSTRUCTION

EROSION AND SEDIMENT CONTROL LAYOUT
ASA SOFTBALL - PARKVIEW ADDITION
RAPID CITY, SOUTH DAKOTA

Project No.:
R12-386

Drawn By:
JDM/BDH

Checked By:
DMM

Date:
03/04/13

Revisions:

This drawing is provided as an instrument of service by Designworks, Inc. and is intended for use on this project only. Any reproduction, use, or disclosure of information contained herein without the prior written consent of Designworks, Inc. is strictly prohibited. (c) copyright 2013 by Designworks, Incorporated.

C2.3

LEGEND

 EXISTING FLOW DIRECTION

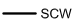
 SEDIMENT CONTROL WATTLE

 INLET PROTECTION DEVICE

 INLET PROTECTION

 TEMPORARY SEDIMENT TRAP

 VEHICLE TRACKING CONTROL

 CONCRETE WASHOUT AREA

 EROSION CONTROL BLANKET

NOTE:

THE INTENT OF THIS EROSION CONTROL LAYOUT IS TO PROVIDE GUIDANCE FOR SWPPP PREPARATION AND TO AID IN THE PROCESS OF OBTAINING THE NECESSARY CONSTRUCTION PERMITS. THE CONTRACTOR IS RESPONSIBLE FOR THE MEANS AND METHODS REQUIRED FOR IMPLEMENTING ANY AND ALL CONSTRUCTION ACTIVITIES TO BE IN COMPLIANCE WITH THE SWPPP AND ASSOCIATED PERMITS.

CONTRACTOR MAY USE PROPOSED DETENTION FACILITY AS TEMPORARY SEDIMENT TRAP DURING CONSTRUCTION. IF THE POND IS UTILIZED AS A TEMPORARY SEDIMENT TRAP THE CONTRACTOR SHALL REMOVE ALL SEDIMENTS AND RETURN THE SURFACE TO PROPOSED GRADE PRIOR TO ACCEPTANCE BY THE CITY.

4415 PARKVIEW DR
LOT 2 LESS LOT H1, LOT H2,
LOT H3 & ROW, BLOCK 11,
ROBBINSDALE #10,
SECTION 13, T1N, R7E
RAPID CITY AREA SCHOOL
DISTRICT 51-4

EXISTING
TENNIS
COURTS

PROPOSED SOFTBALL
FIELDS

PROPOSED 20 AC-FT
DETENTION CELL

INLET
CHANNEL

SEDIMENT FOREBAY

WETLANDS
DELINEATION

TEMPORARY SEDIMENT TRAP

EAST ENCHANTED PINES DRIVE

POTENTIAL UPSTREAM INFLOWS
TO SEDIMENT TRAP

Q2 = 73 CFS

Q10 = 236 CFS

Q100 = 538 CFS

4604 SOUTH POINTE DR
LOT 18, BLOCK 1,
SECTION 24, T1N, R7E
JAMES D CULPS

4604 SOUTH POINTE DR
LOT 10, BLOCK 2, SOUTH POINTE,
SECTION 24, T1N, R7E
EDWARD J BOYLE

4603 MANDALAY LN
LOT 11, BLOCK 2, SOUTH POINTE,
SECTION 24, T1N, R7E
ROBERT DICKER

4602 MANDALAY LN
LOT 8, BLOCK 3, SOUTH POINTE,
SECTION 24, T1N, R7E

LOT 9R, BLOCK 3, SOUTH POINTE,
SECTION 24, T1N, R7E
MANDALAY MOBILE H.C.

40 20 0 40

CONTOUR INTERVAL = 1'

 DESIGNWORKS, INC.

526 Saint Joseph St.
Suite B
Rapid City, SD 57701
Tele: 605/394-0394
Fax: 605/394-9588

 FEC Engineering Company, Inc.

NOT FOR CONSTRUCTION

EROSION AND SEDIMENT CONTROL LAYOUT
ASA SOFTBALL - PARKVIEW ADDITION
RAPID CITY, SOUTH DAKOTA

Project No.:
R12-386

Drawn By:
JDM/BDH

Checked By:
DMM

Date:
03/04/13

Revisions:

This drawing is provided as an instrument of service by Designworks, Inc. and is intended for use on this project only. Any reproduction, use, or disclosure of information contained herein without the prior written consent of Designworks, Inc. is strictly prohibited. © copyright 2013 by Designworks, Incorporated.

C2.4