

DETAILS - PANEL & CAP

SCALE 1/2" = 1'-0"

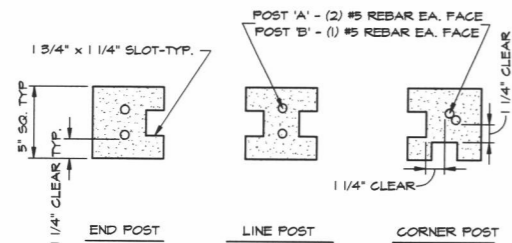

SECTIONS 5" x 5" POST

SCALE 2" = 1'-0"

PIER SCHEDULE			
PIER	PIER DIA.	PIER DIA. MIN.	VERTICAL REINF. HORIZONTAL TIES PIER DIA. MIN. SIZE/SPACING
1			
2			
3			
4			
5			
6 AND BEYOND			

NOTE: PIER SCHEDULE AND POST SIZE ARE TYP. FOR EACH WALL END

SPECIFICATIONS AND NOTES:

General

1. Project has been designed in accordance with the International Building Code, 2006 Edition.

2. Wind Loads:

Basic Wind Speed:
Exposure Category:
Category:
Importance Factor:

3. Product to be manufactured by a NPCA Certified Plant.

Manufacturer: Superior Concrete Products
Contact: Calvin Clarke
1203 Raider Drive
Euless, Texas 76040
Phone No.: (817) 277-9255
Fax No.: (817) 261-0194

4. Screening Wall is to be constructed entirely on the project property.

5. Should drainage be required, the bottom panel shall be raised 2"-4" above grade by means of a concrete filled "Schedule 80 PVC Pipe" placed in the groove of the respective posts.

6. Color to be job specific.

Concrete

1. Concrete Materials:

a. Concrete shall be normal weight concrete having sand and gravel or crushed stone aggregates, mixed with ASTM-C150, Type I or Type III Portland Cement to meet the minimum compressive strengths as follows:

- panels & posts: 5000 psi @ 28 days
- footings & piers: 2500 psi at 28 days
- sidewalks & non-structural: 2500 psi at 28 days

b. Water used for concrete shall be clean water and free from injurious amounts of oils, acids, alkalies, organic or other deleterious substances.

c. All concrete permanently exposed to the weather shall contain an air-entraining admixture resulting in 3 to 6% entrained air or as recommended by the manufacturer.

2. Concrete Workmanship:

- Fresh poured concrete shall be tamped into place by steel rammer, slicing tools or mechanical vibrator, until concrete is thoroughly compact and without void.
- Make excavations for footings to undisturbed soil or to the depth noted on the drawings. Leave the bottom bearing surface clean and smooth. If footing excavations are made deeper than intended, only concrete shall be used for fill. Remove all loose material from excavations prior to concrete pour.

Reinforcements

1. Reinforcing Materials:

- Deformed type bars shall conform to ASTM-A 615, Grade 60, placed as shown on the drawings.
- Steel Reinforcing wire shall meet U.S. Steel wire gage, ASTM-A 62, fy = 70,000 psi min. Galvanized.
- All ties and stirrups shall conform to the requirements of ASTM-A 615, grade 40.

2. Reinforcing Workmanship:

- Reinforcement steel shall be fabricated in accordance with the CRSI Standard Details. Reinforcing bars shall be cold-bent only. Use of heat to bend reinforcement steel shall be cause for rejection.
- Reinforcement steel, bars and wire fabric shall be thoroughly cleaned before placing and again before the concrete is placed, shall be accurately positioned and secured in place. Provide standard bar chairs for all beam steel. No brick or porous materials may be used to support the steel off the ground.

c. Install all reinforcement with the following clearances between reinforcing steel and face of concrete:

- Footing, pier, or beam bottom: 3"
- Earth-formed pier or beam sides: 2"
- Formed footing, pier or beam sides, exposed: 1"
- Precast exposed to weather: panels 3/4"; posts 1 1/4"

d. Splices within continuous unscheduled reinforcing steel shall have a minimum lap of 30 bar diameters.

Soils

a. Footing size is based on the following minimum soil properties:

- Soil Compaction:
- Bearing Capacity:
- Frictional Resistance:
- Lateral Bearing:

RECEIVED

FEB 14 2011

Rapid City Growth Management Department

EXAMPLE SHOP DRAWINGS

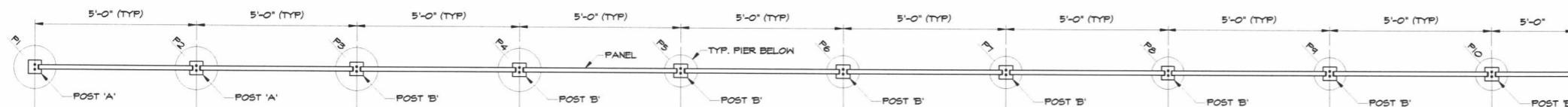

PLAN - SCREENING WALL

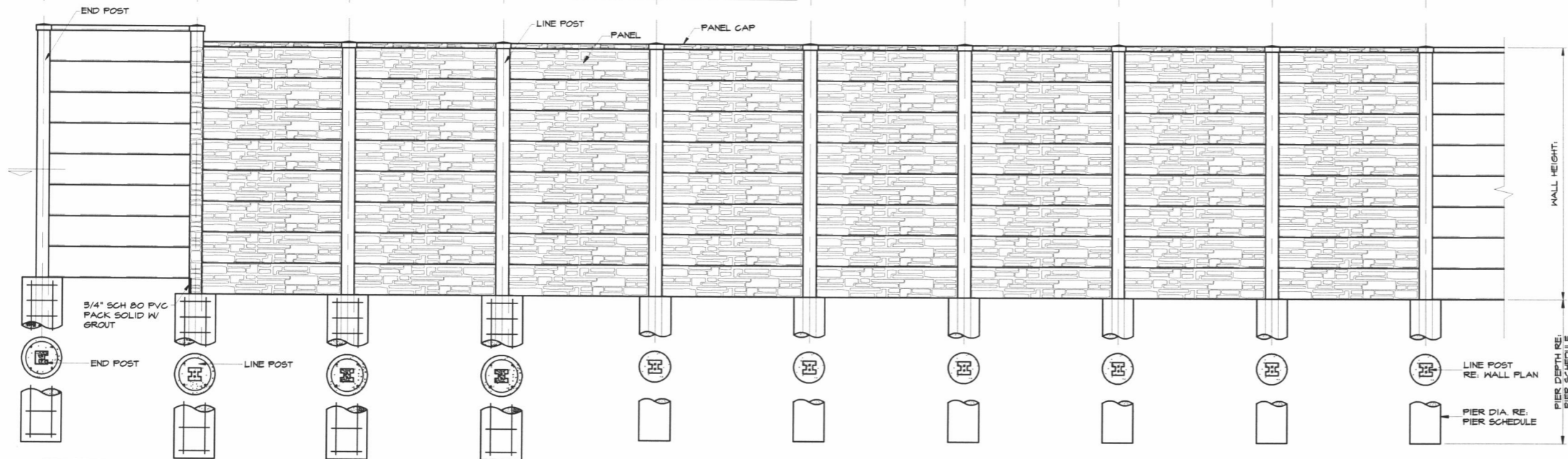

ELEVATION - SCREENING WALL

SCALE 1/2" = 1'-0"

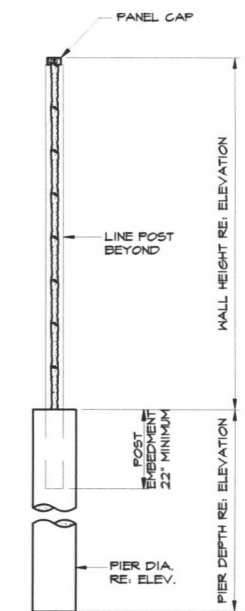

SECTION - SCREENING WALL

SCALE 1/2" = 1'-0"

REVISIONS

PRECAST SCREENING WALL

SUPERIOR-LEDGESTONE

Manufactured By
SUPERIOR CONCRETE PRODUCTS
1203 RAIDER DRIVE EULESS, TX 76040
1 (800) 942-9255 (817) 277-9255

DATE:
DRAWN:

SHEET

OF SHEET(S)