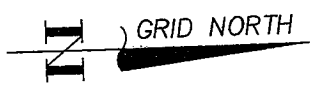
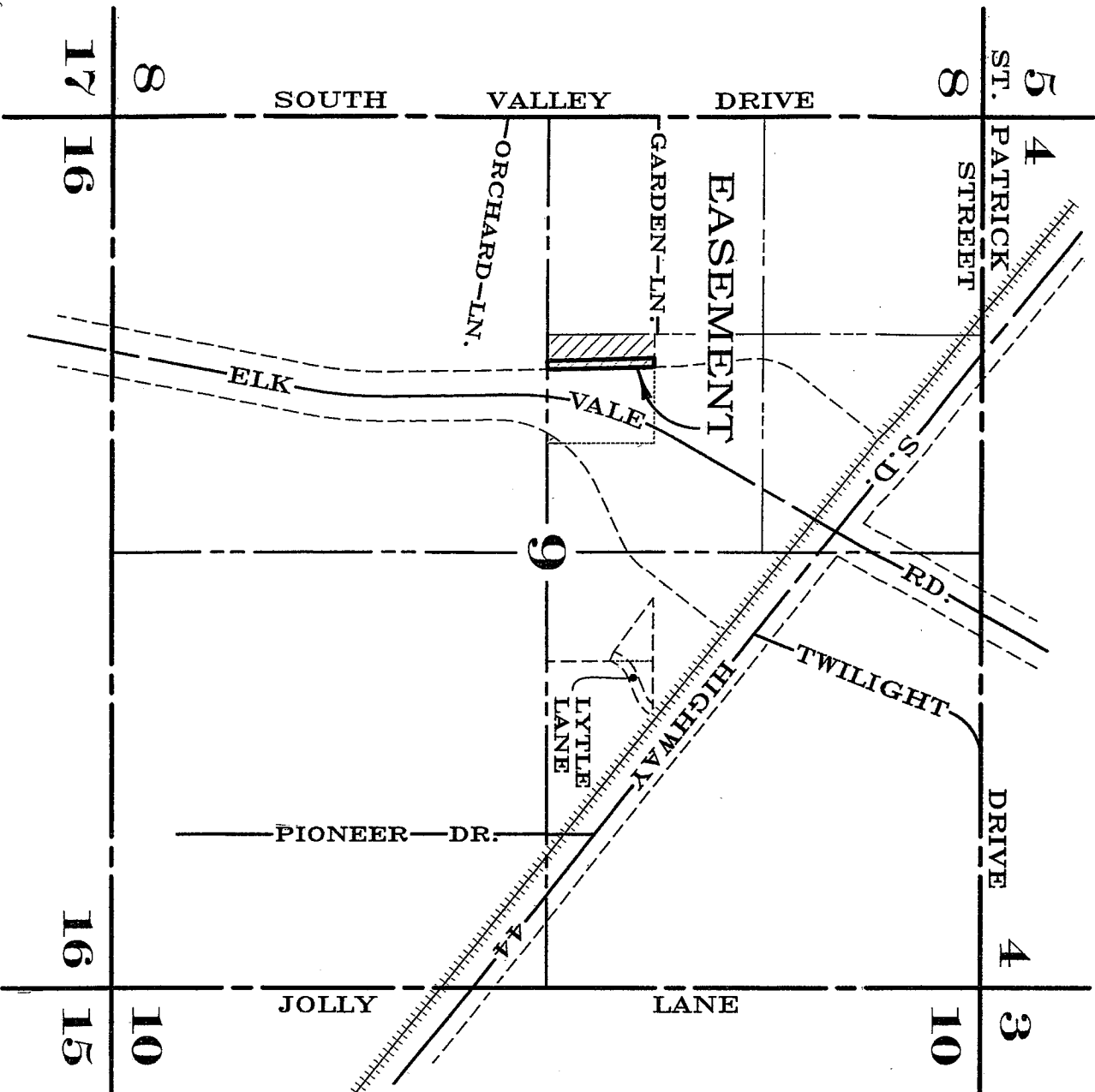

EXHIBIT A

PERMANENT UTILITY EASEMENT RESERVED WITHIN THE
 SW1/4 SE1/4 NW1/4 OF SECTION 9,
 TOWNSHIP 1 NORTH, RANGE 8 EAST OF THE BLACK HILLS MERIDIAN
 RAPID CITY, PENNINGTON COUNTY, SOUTH DAKOTA.

SHEET 1 of 2



SCALE: 1" = 1000'
 0 500 1000
 JUNE, 2009

VICINITY MAP

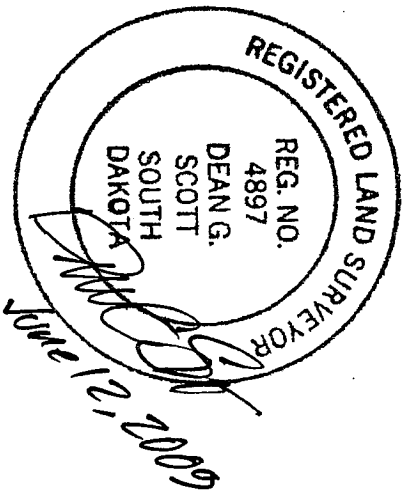

NOTES

1. BEARING ORIENTATION IS BASED ON THE CITY OF RAPID CITY SURVEY CONTROL NETWORK. DISTANCES ARE BASED ON THE SAME NETWORK AND THE SCALE FACTOR DETERMINED THIS SURVEY IS 0.99979 (VALUES SHOWN ARE SHORTER THAN SURFACE).
2. DISTANCES SHOWN IN PARENTHESIS ARE OF RECORD.

PREPARED BY:
D.C. Scott
 SURVEYORS, INC.
 3153 ANDERSON ROAD
 RAPID CITY, SD 57703
 (605) 393-2400

S 88°03'58" E
8.00'

DOT CAP BEARS
N57°57'E 147.85'

CENTER OF
SE1/4 NW1/4

DETAIL

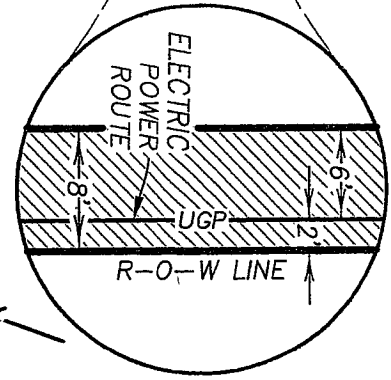

VALE RD.

1/16 LINE

N 00°57'57" E 662.21'
S 00°57'57" W 662.21'

R-O-W LINE

DOT CAP BEARS
S57°57'W 4.73'

N 88°05'07" W
8.00'

S 88°05'07" E 382.27'

1/4 LINE

S W 1/4
S E 1/4
T 1 N W 1/4

LEGEND

- FOUND IRON ROD WITH ALUM-
INUM CAP MARKED 'SD DOT'.
- R-O-W RIGHT-OF-WAY.
- UGP— UNDERGROUND POWER LINE.
- SECTION LINE.
- 1/4 SECTION LINE.
- 1/16 SECTION LINE.
- 1/64 SECTION LINE.
- OTHER PROPERTY LINE.



SCALE: 1" = 100'
0 50 100
S.F. = 0.99979

S E 1/4
S E 1/4
T 1 N W 1/4

PREPARED BY:
D.C. Scott
SURVEYORS, INC.
3153 ANDERSON ROAD
RAPID CITY, SD 57703
(605) 393-2400

