

# VACATION OF A PORTION OF 66' WIDE ACCESS AND UTILITY EASEMENT THE NE<sup>1</sup>/<sub>4</sub> OF THE NE<sup>1</sup>/<sub>4</sub> OF SECTION 23

LOCATED IN THE NE<sup>1</sup>/<sub>4</sub> OF THE NE<sup>1</sup>/<sub>4</sub>  
SECTION 23, T1N, R7E, B.H.M.,  
RAPID CITY, PENNINGTON COUNTY, SOUTH DAKOTA

NE<sup>1</sup>/<sub>4</sub> OF THE NE<sup>1</sup>/<sub>4</sub> OF THE NE<sup>1</sup>/<sub>4</sub> OF SECTION 23

RECEIVED

JAN 25 2007

Rapid City Growth  
Management Department

40' WIDE ACCESS AND  
UTILITY EASEMENT AS  
SHOWN IN MISC. BOOK 19  
PAGE 5526

40' WIDE ACCESS AND  
UTILITY EASEMENT AS  
SHOWN IN MISC. BOOK  
23 PAGE 2061.

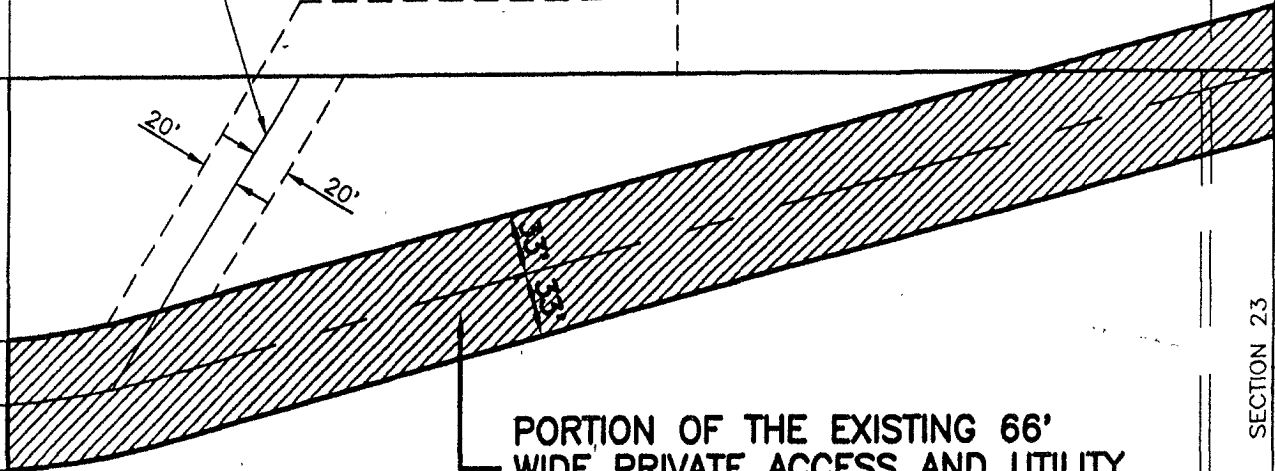

PORTION OF THE EXISTING 66'  
WIDE PRIVATE ACCESS AND UTILITY  
EASEMENT AS SHOWN IN MISC.  
BOOK 9 PAGE 4407 TO BE  
VACATED THIS DOCUMENT.

SECTION 23  
SECTION 24

SE<sup>1</sup>/<sub>4</sub> OF THE NE<sup>1</sup>/<sub>4</sub> OF THE NE<sup>1</sup>/<sub>4</sub> OF SECTION 23



JANUARY 8, 2007



SCALE: 1" = 100'

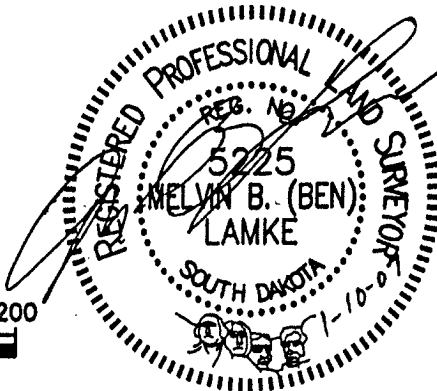

EXISTING 38' WIDE  
POWERLINE EASEMENT AS  
SHOWN IN MISC. BOOK  
31 PAGE 2072.

STATUTORY 66' WIDE  
SECTION LINE  
RIGHT-OF-WAY

