

# EXHIBIT A

06VE018

VACATION OF PLATTED BUILDING SETBACK LINE  
NORTH 318.90' OF LOT 16, REPLAT OF BLOCK 31, NOWLIN AND WOOD ADDITION  
LOCATED IN SECTION 31, T2N R8E, BHM  
RAPID CITY, PENNINGTON COUNTY, SOUTH DAKOTA

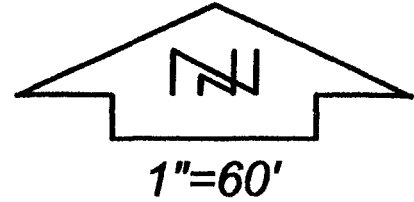

Anamosa St

RECEIVED

NOV 23 2004

Rapid City Growth  
Management Department

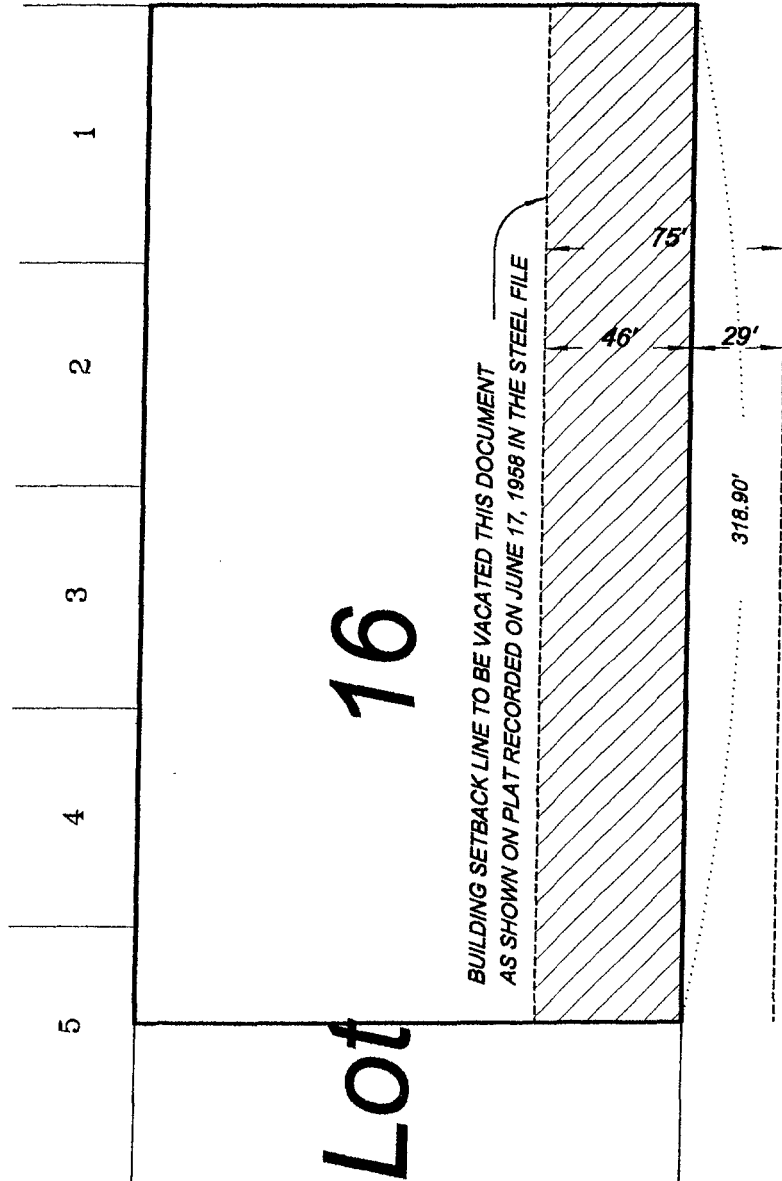

LaCrosse St

