



POLENZ LAND SURVEYING

00FV001

1104 Jackson Blvd., Rapid City, SD 57702
Phone: 605-342-6155 Fax: 605-348-1621

SCALE: 1" = 20'

8
2
FULTON STREET

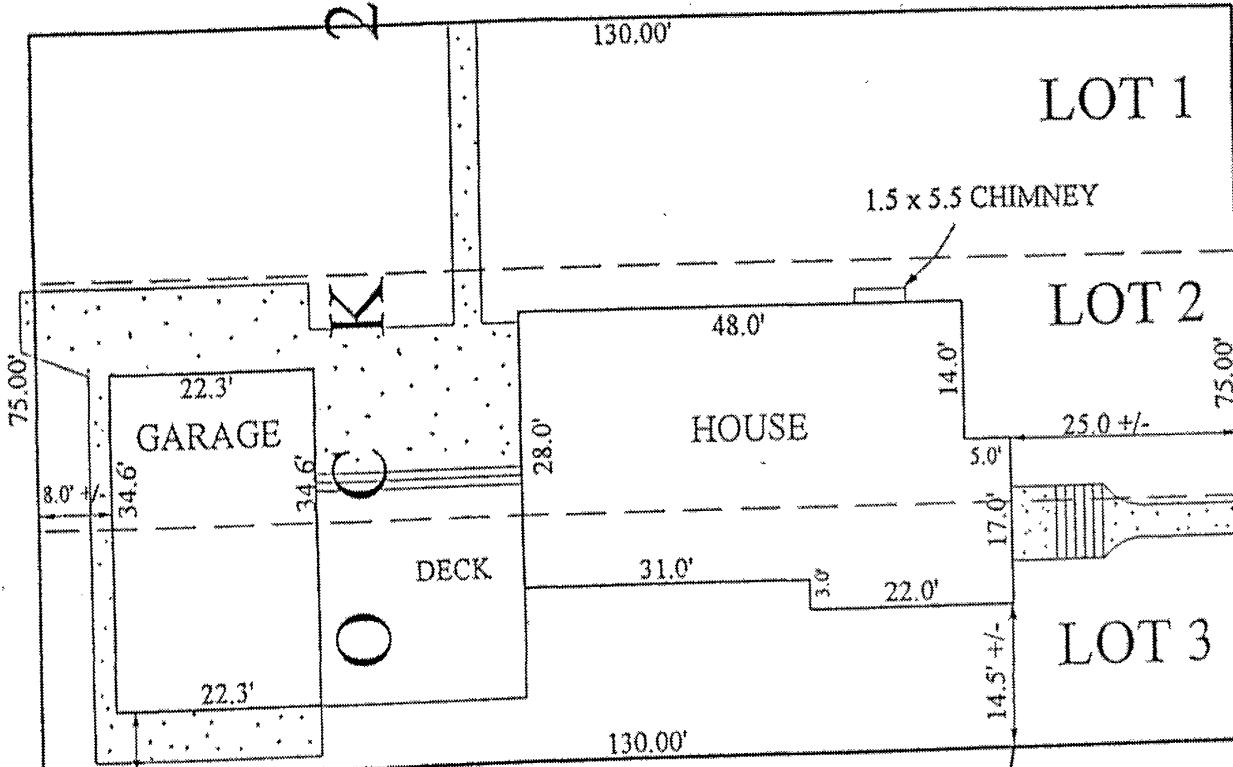

WEST BOULEVARD

B L
LOT 4

1001
Fence &
to be
built

REVIEWED & ACCEPTED

Signature: *[Signature]* Date: 11-22-99
 Signature: *[Signature]* Date: 11-22-99

IMPROVEMENT LOCATION EXHIBIT

The purpose of this exhibit is to provide a representation of the information gathered at the time of the inspection for the interested parties. This exhibit is based on existing but not confirmed boundary information and is subject to any inaccuracies that a boundary survey might reveal. No property corners

SURVEYOR'S CERTIFICATE

I, the undersigned, do hereby certify that I have surveyed the above described property and that the information shown hereon is an accurate representation of the information gathered at the time of inspection of the subject property.