

01UR007

BACKFILL WITH BEST UNCLASSIFIED EXCAVATION MATERIAL AVAILABLE.

THE PARKING LOTS SHALL BE CONSTRUCTED WITH
6" OF RECYCLED ASPHALT BASE COURSE APPROX. 1000 TONS
2" OF CLASS 0, TYPE 2 ASPHALT SURFACE COURSE APPROX. 500 TONS

STRIP PARKING LOTS ACCORDING TO LAYOUT AND INSTALL A
HANDICAP PARKING SIGN AT EACH HANDICAP STALL.

INCORPORATE 2" COMPOST, SEED, FERTILIZE AND MULCH ALL DISTURBED AREAS.

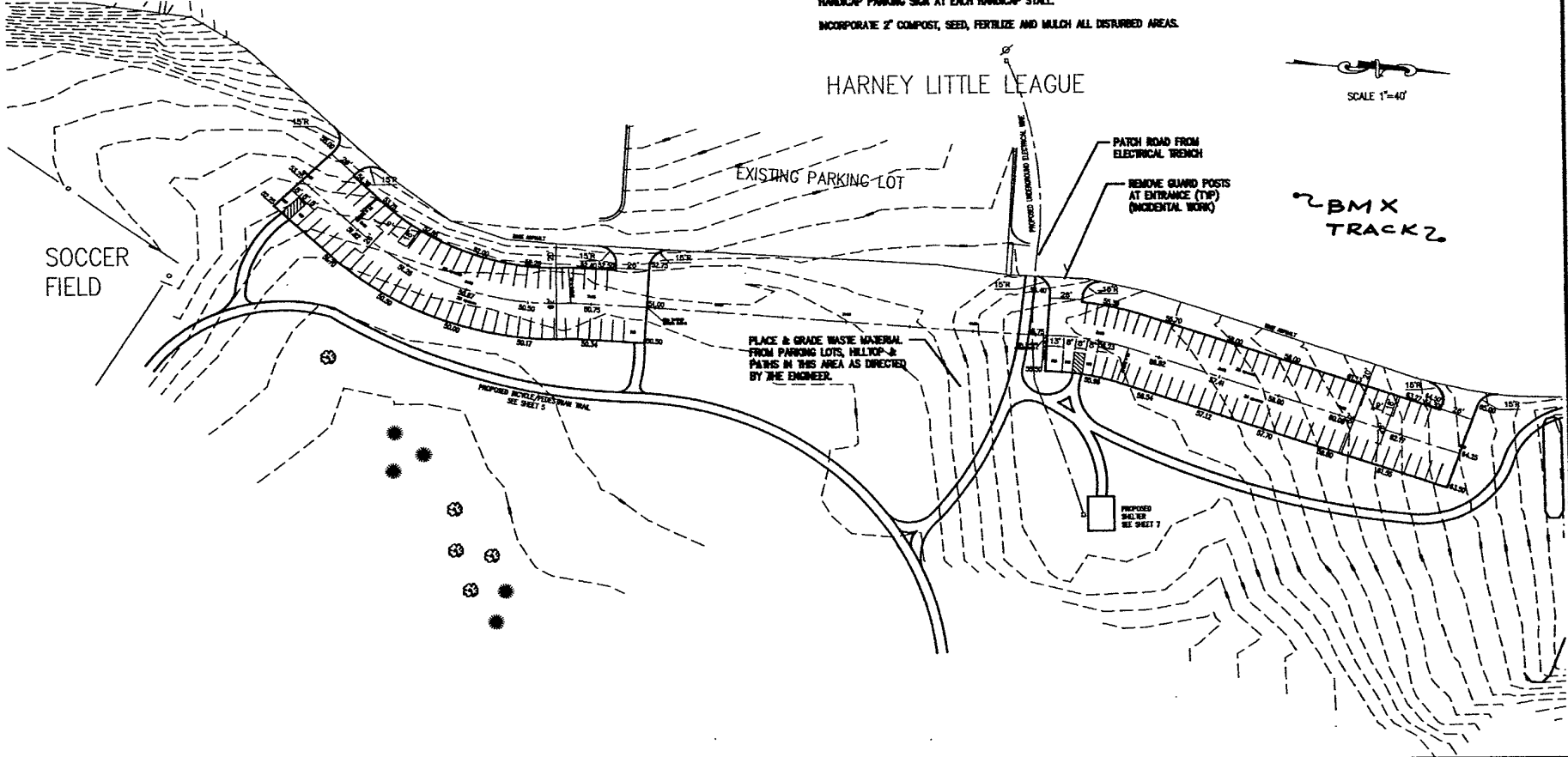

HARNEY LITTLE LEAGUE

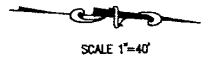

CITY of RAPID CITY

PUBLIC WORKS DEPARTMENT ENGINEERING DIVISION

SCALE:	AS SHOWN
DATE:	6/16
DESIGNER:	K.J.
DRAWN:	K.J.
REVISIONS:	
DATE:	



**ROBBINSDALE PARK
PARKING LOTS**
PROJECT PR01-1010

SHEET
3
OF
7