

PLANT SCHEDULE - ENTIRE SITE

SYM	QUANT	COMMON NAME	BOTANICAL NAME	SIZE	ROOT	COMMENTS
DEC	1	DECIDUOUS TREES				
SHL	2	SHRUBS - HOKEY COULT	<i>Shepherdia sp. var. holocarpa</i>	2' P. CAL	BAIS	STRAIGHT LEADER, FULL FORM
SHL	3	SHRUBS - CONDENSUS & EVERGREEN				
MS	1	MEDICAL JUNBER	<i>Juniperus horizontalis</i> 'Moorei'	30" HT	CONT	
AC	1	ALPINE CLOVERANT	<i>Woodsia glabella</i>	24" HT	CONT	
		PERENNIALS & GRASSES				
PG	4	SAVEL FORESTER GRASS	<i>Calamagrostis x acutiflora</i> 'Fast Forward'	8"	CONT	
PRG	27	PARCHING VE. CAVEALLY	<i>Veronicastrum virginicum</i>	8"	CONT	

LANDSCAPE NOTES:

- WHERE SHOWN, SPHERE BEES SHALL BE ALLICATED WITH 4" DEPTH 3/8" AFTER INSTALLATION AND/OR TOPDRESSING OPERATIONS OF 1-1/2" BFT LIMESTONE ROCK MULCH OVER VIBRIB MEMBER. OWNER TO APPROVE ROCK SAMPLE PRIOR TO INSTALLATION. POLY-EDGE TO BE VALLEY VIEW BLACK OR APPROVED EQUAL.
- RANDOM 3/8" LIMESTONE BOLLIDERS COLOR AND SIZE TO COMPLEMENT NEW LANDSCAPING. OWNER TO APPROVE BOLLIDER SAMPLE PRIOR TO INSTALLATION.
- PLANT MATERIALS SHALL CONFORM WITH THE AMERICAN ASSOCIATION OF NURSERYMEN STANDARDS AND SHALL BE OF VARY STOCK FREE FROM DISEASE, DAMAGE AND DISFIGURATION. CONTRACTOR IS RESPONSIBLE FOR MAINTAINING PLAINNESS OF PLANT MATERIAL FOR DURING OF ACCEPTANCE PERIOD.
- UPON DISCOVERY OF A DISCREPANCY BETWEEN THE QUANTITY OF PLANTS SHOWN ON THE SCHEDULE AND THE QUANTITY SHOWN ON THE PLAN, THE PLAN SHALL GOVERN.
- CONDITION OF INSTALLATION SHALL BE MONITORED BY THE LANDSCAPE ARCHITECT THROUGHOUT THE DURATION OF THE CONTRACT. LANDSCAPE MATERIALS PART OF THE CONTRACT SHALL BE SUBMITTED FOR TWO (2) FULL GROUND READINGS FROM SUBSTANTIAL COMPLETION DATE.
- MEALS DISTURBED BY CONSTRUCTION ACTIVITIES SHALL BE REPLACED IF APPLICABLE AND SO AS SPECIFIED BY FIELD OTHERS/NOTES ON THE DRAWINGS.
- COORDINATE LOCATION OF INSTALLATION WITH UNDERGROUND AND OVERHEAD UTILITIES. LOCATIONS FOR UTILITY, SPORES AND HAZARDOUS CONTRACTOR SHALL STAKE IN THE PUBLIC RIGHT OF WAY TO THE ROOF OF PARADEAD BACK OF CURB.
- ALL PLANT MATERIALS SHALL BE WATERED AND MAINTAINED UNTIL ACCEPTANCE.
- REPAIR AT NO COST TO OWNER ALL DAMAGE RESULTING FROM LANDSCAPE CONTRACTORS ACTIVITIES.
- WEED AND MAINTAIN ALL PAVED SURFACES FREE OF DEBRIS GENERATED FROM LANDSCAPE CONTRACTORS ACTIVITIES.
- PROVIDE WITH IRRIGATION SYSTEM DESIGN AND INSTALLATION. SYSTEM SHALL BE A FULL-PROGRAMMABLE SYSTEM CAPABLE OF ALTERNATE DATE WATERING. THE SYSTEM SHALL PROVIDE HEAD TO HEAD OR DWP COVERAGE AND BE CAPABLE OF DELIVERING ONE INCH OF PRECIPITATION PER WEEK. SYSTEM SHALL EXTEND INTO THE PUBLIC RIGHT OF WAY TO THE ROOF OF PARADEAD BACK OF CURB.
- CONTRACTOR SHALL SECURE APPROVAL OF PROPOSED IRRIGATION SYSTEM INCLUDING FRODO FROM OWNER PRIOR TO INSTALLATION.

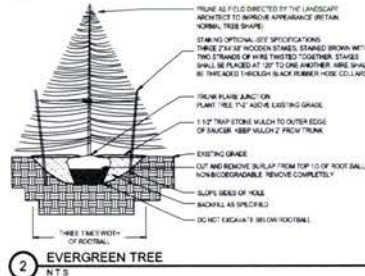
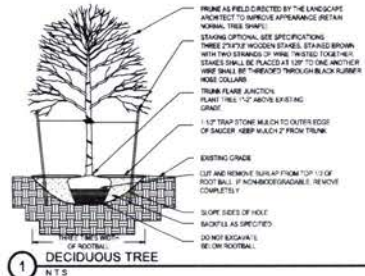
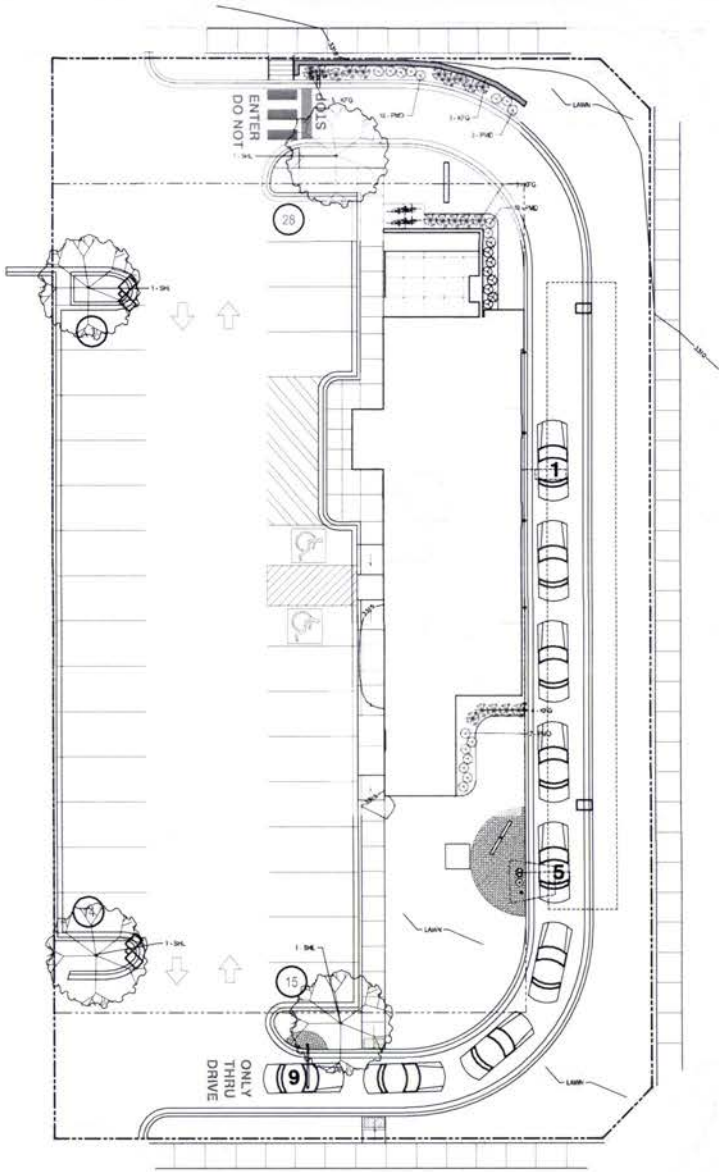

- LEGEND
- SHRUBS - IMPROVED MULCH OVER 1/2\"/>

RYAN A. SCHROEDER
ARCHITECT
4811 West 29th Street
Suite 200
St. Louis Park, Minnesota
952.942.9999

Taco Bell
E. STUMER ROAD & SHELBY BL
RAPID CITY, SD 57701

PRELIMINARY
NOT FOR
CONSTRUCTION

Border Foods
5425 Boone Ave. N.
New Hope, MN 55428

CivilSite
11111 13th Ave S, Suite 100
Edina, MN 55425
612.426.1111
www.civilsite.com

Project: 16PD013
Client: Taco Bell
Project Manager: Ryan Schroeder
Date: 08/20/2015
Phone: 612.426.1111

EXPLORER LITE
40 Seals - 2,455 S.F.
LANDSCAPE PLAN

Sheet: 0015
Date: 08/20/15
Checked: RAS
Scale: 1/8\"/>

L1.0

TACO BELL
RAPID CITY, SD (MELBY)