

15PL105

South of existing intersection of Homestead Street and Timmons Boulevard

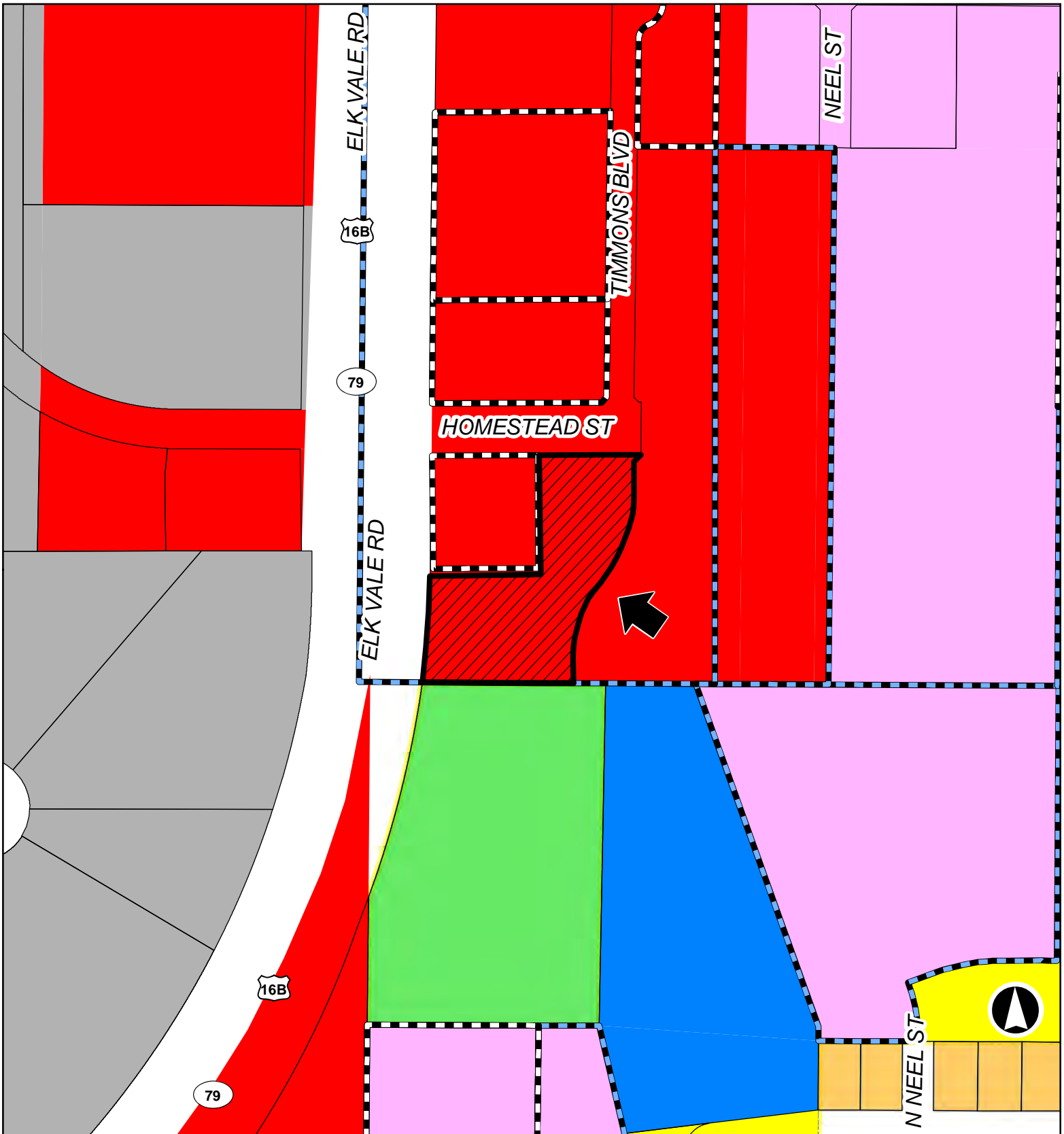

### Rapid City/Pennington County Zoning

- |                   |                                 |                           |                            |                          |
|-------------------|---------------------------------|---------------------------|----------------------------|--------------------------|
| Subject Property  | Planned Development             | General Commercial        | Medium Density Residential | Limited Ag., PC          |
| Rapid City Limits | Planned Development Designation | Low Density Residential-1 | Office Commercial          | Suburban Residential, PC |
| Light Industrial  |                                 | Public                    |                            |                          |