

GENERAL NOTES

1. THE CONTRACTOR SHALL BE RESPONSIBLE FOR OBTAINING ALL NECESSARY PERMITS AND APPROVALS FROM THE LOCAL JURISDICTION AND SHALL BE RESPONSIBLE FOR OBTAINING ALL NECESSARY PERMITS AND APPROVALS FROM THE LOCAL JURISDICTION.
2. THE CONTRACTOR SHALL BE RESPONSIBLE FOR OBTAINING ALL NECESSARY PERMITS AND APPROVALS FROM THE LOCAL JURISDICTION AND SHALL BE RESPONSIBLE FOR OBTAINING ALL NECESSARY PERMITS AND APPROVALS FROM THE LOCAL JURISDICTION.
3. THE CONTRACTOR SHALL BE RESPONSIBLE FOR OBTAINING ALL NECESSARY PERMITS AND APPROVALS FROM THE LOCAL JURISDICTION AND SHALL BE RESPONSIBLE FOR OBTAINING ALL NECESSARY PERMITS AND APPROVALS FROM THE LOCAL JURISDICTION.
4. THE CONTRACTOR SHALL BE RESPONSIBLE FOR OBTAINING ALL NECESSARY PERMITS AND APPROVALS FROM THE LOCAL JURISDICTION AND SHALL BE RESPONSIBLE FOR OBTAINING ALL NECESSARY PERMITS AND APPROVALS FROM THE LOCAL JURISDICTION.
5. THE CONTRACTOR SHALL BE RESPONSIBLE FOR OBTAINING ALL NECESSARY PERMITS AND APPROVALS FROM THE LOCAL JURISDICTION AND SHALL BE RESPONSIBLE FOR OBTAINING ALL NECESSARY PERMITS AND APPROVALS FROM THE LOCAL JURISDICTION.

PROPOSED FEATURES! REFER TO SURVEY FOR EXISTING FEATURES!

GENERAL FEATURES

- PROPERTY LINE
- SUBDIVISION / OUTPARCEL PROPERTY LINE
- EDGE OF ASPHALT
- EDGE OF CONCRETE PAVEMENT
- LIMITS OF CONCRETE TYPE
- EDGE OF GRAVEL
- CONCRETE CURB AND GUTTER (REFER TO PLAN FOR USE)
- FENCING (REFER TO SCHEDULE FOR THE TYPE AND HEIGHT)
- DRAINAGE STRUCTURES (REFER TO DRAINAGE PLAN FOR USE)
- UTILITY STRUCTURES (REFER TO UTILITY PLAN FOR USE)
- SITE LIGHTING (REFER TO ELECTRICAL PLAN FOR THE USE AND DETAILS)

PAVEMENT FEATURES

INDICATE THE PAVEMENT TYPE TO BE USED ON THIS PLAN AND SPECIFICALLY CLARIFY LOCATIONS OF PAVEMENT TYPE CHANGES. THE CONTRACTOR SHALL SUBMIT A BID FOR BOTH ASPHALT AND CONCRETE MATERIAL.

CONCRETE PAVEMENT (REFER TO DETAIL D04 FOR PAVEMENT SECTION DETAIL)

- LIGHT DUTY / SIDEWALK CONCRETE
- STANDARD DUTY CONCRETE
- HEAVY DUTY CONCRETE

ASPHALT PAVEMENT (REFER TO DETAIL D04 FOR PAVEMENT SECTION DETAIL)

- STANDARD DUTY ASPHALT
- HEAVY DUTY ASPHALT

ASPHALT OVERLAY (REFER TO DETAIL D04 FOR PAVEMENT OVERLAY DETAIL)

- ASPHALT OVERLAY
- ASPHALT SLURRY

OFF-SITE PAVEMENT (REFER TO OFF-SITE PLANS AND SPECIFICATIONS FOR PAVEMENT DETAIL)

- OFF-SITE PAVEMENT

GENERAL NOTES

1. THE CONTRACTOR SHALL BE RESPONSIBLE FOR OBTAINING ALL NECESSARY PERMITS AND APPROVALS FROM THE LOCAL JURISDICTION AND SHALL BE RESPONSIBLE FOR OBTAINING ALL NECESSARY PERMITS AND APPROVALS FROM THE LOCAL JURISDICTION.
2. THE CONTRACTOR SHALL BE RESPONSIBLE FOR OBTAINING ALL NECESSARY PERMITS AND APPROVALS FROM THE LOCAL JURISDICTION AND SHALL BE RESPONSIBLE FOR OBTAINING ALL NECESSARY PERMITS AND APPROVALS FROM THE LOCAL JURISDICTION.
3. THE CONTRACTOR SHALL BE RESPONSIBLE FOR OBTAINING ALL NECESSARY PERMITS AND APPROVALS FROM THE LOCAL JURISDICTION AND SHALL BE RESPONSIBLE FOR OBTAINING ALL NECESSARY PERMITS AND APPROVALS FROM THE LOCAL JURISDICTION.
4. THE CONTRACTOR SHALL BE RESPONSIBLE FOR OBTAINING ALL NECESSARY PERMITS AND APPROVALS FROM THE LOCAL JURISDICTION AND SHALL BE RESPONSIBLE FOR OBTAINING ALL NECESSARY PERMITS AND APPROVALS FROM THE LOCAL JURISDICTION.
5. THE CONTRACTOR SHALL BE RESPONSIBLE FOR OBTAINING ALL NECESSARY PERMITS AND APPROVALS FROM THE LOCAL JURISDICTION AND SHALL BE RESPONSIBLE FOR OBTAINING ALL NECESSARY PERMITS AND APPROVALS FROM THE LOCAL JURISDICTION.

PROPOSED FEATURES! REFER TO SURVEY FOR EXISTING FEATURES!

GENERAL FEATURES

- PROPERTY LINE
- SUBDIVISION / OUTPARCEL PROPERTY LINE
- CONCRETE CURB AND GUTTER (REFER TO PLAN FOR USE)
- FENCING (REFER TO SCHEDULE FOR THE TYPE AND HEIGHT)
- PROPOSED PARKING SPACE CENTER
- DRAINAGE STRUCTURES (REFER TO DRAINAGE PLAN FOR USE)
- UTILITY STRUCTURES (REFER TO UTILITY PLAN FOR USE)
- SITE LIGHTING (REFER TO ELECTRICAL PLAN FOR THE USE AND DETAILS)

STRIPING FEATURES

ALL ON-SITE STOPPING AND PAVEMENT MARKINGS SHALL BE PAINTED ON LORING WHITE FOR ASPHALT PAVED AREAS AND YELLOW ON CONCRETE PAVED AREAS UNLESS OTHERWISE NOTED.

4" (85%)
4" (85%)
4" (85%)
4" (85%)

3/4" SINGLE SOLID - LINE 3/4" SINGLE BROKEN - LINE
3/4" DOUBLE SOLID - LINE 3/4" SINGLE DASHED - LINE

INDICATES SPECIFIED COLOR OF STRIPE. Y = YELLOW W = WHITE

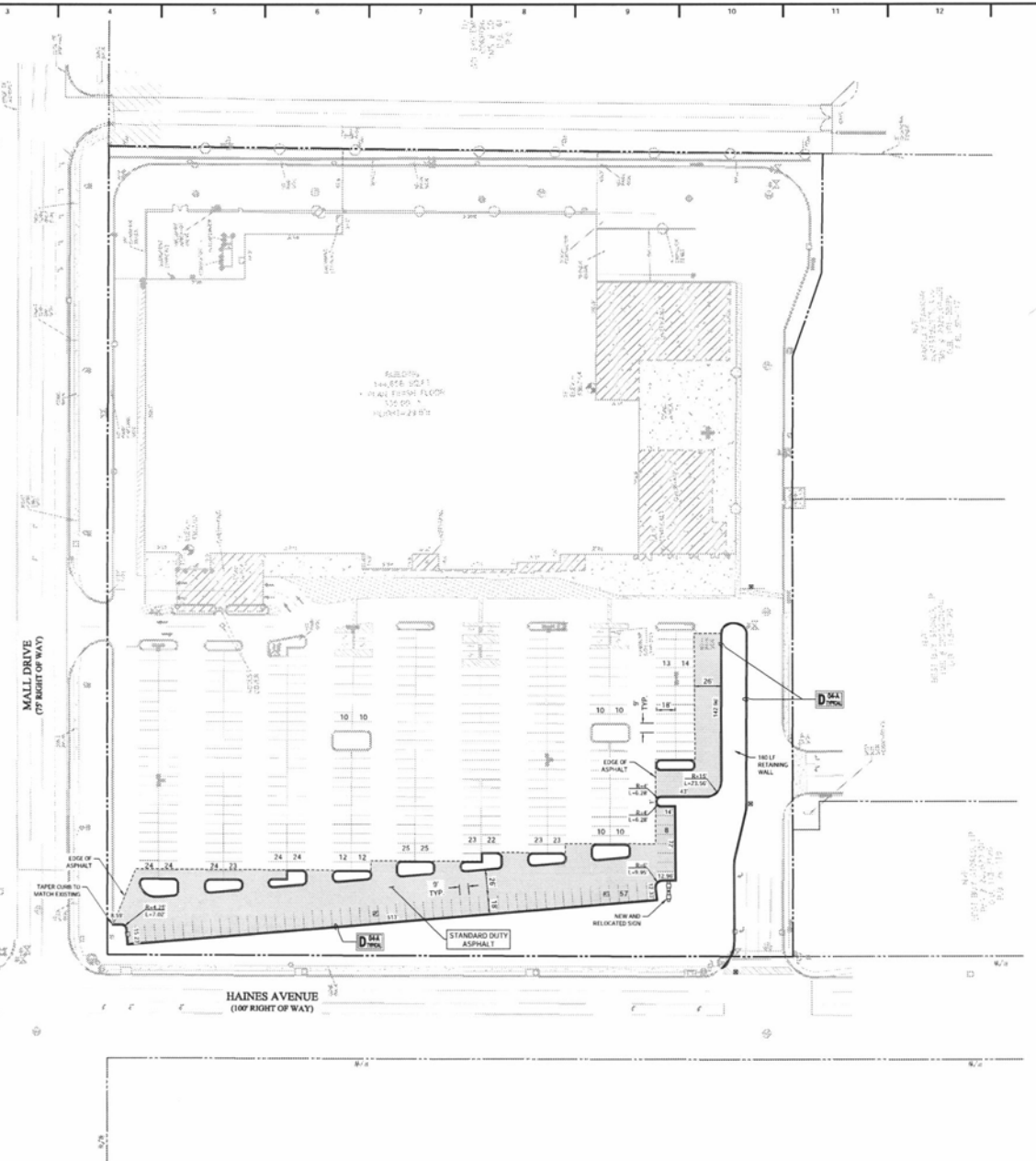

PROPOSED FEATURES! REFER TO SURVEY FOR EXISTING FEATURES!

GENERAL FEATURES

- PROPERTY LINE
- SUBDIVISION / OUTPARCEL PROPERTY LINE
- EDGE OF ASPHALT
- EDGE OF CONCRETE
- EDGE OF GRAVEL
- CONCRETE CURB AND GUTTER (REFER TO PLAN FOR USE)
- FENCING (REFER TO SCHEDULE FOR THE TYPE AND HEIGHT)
- PROPOSED PARKING SPACE CENTER
- DRAINAGE STRUCTURES (REFER TO DRAINAGE PLAN FOR USE)
- UTILITY STRUCTURES (REFER TO UTILITY PLAN FOR USE)
- SITE LIGHTING (REFER TO ELECTRICAL PLAN FOR THE USE AND DETAILS)

GENERAL NOTES

1. THE CONTRACTOR SHALL BE RESPONSIBLE FOR OBTAINING ALL NECESSARY PERMITS AND APPROVALS FROM THE LOCAL JURISDICTION AND SHALL BE RESPONSIBLE FOR OBTAINING ALL NECESSARY PERMITS AND APPROVALS FROM THE LOCAL JURISDICTION.
2. THE CONTRACTOR SHALL BE RESPONSIBLE FOR OBTAINING ALL NECESSARY PERMITS AND APPROVALS FROM THE LOCAL JURISDICTION AND SHALL BE RESPONSIBLE FOR OBTAINING ALL NECESSARY PERMITS AND APPROVALS FROM THE LOCAL JURISDICTION.
3. THE CONTRACTOR SHALL BE RESPONSIBLE FOR OBTAINING ALL NECESSARY PERMITS AND APPROVALS FROM THE LOCAL JURISDICTION AND SHALL BE RESPONSIBLE FOR OBTAINING ALL NECESSARY PERMITS AND APPROVALS FROM THE LOCAL JURISDICTION.
4. THE CONTRACTOR SHALL BE RESPONSIBLE FOR OBTAINING ALL NECESSARY PERMITS AND APPROVALS FROM THE LOCAL JURISDICTION AND SHALL BE RESPONSIBLE FOR OBTAINING ALL NECESSARY PERMITS AND APPROVALS FROM THE LOCAL JURISDICTION.
5. THE CONTRACTOR SHALL BE RESPONSIBLE FOR OBTAINING ALL NECESSARY PERMITS AND APPROVALS FROM THE LOCAL JURISDICTION AND SHALL BE RESPONSIBLE FOR OBTAINING ALL NECESSARY PERMITS AND APPROVALS FROM THE LOCAL JURISDICTION.

PROJECT INFORMATION

BUILDING INFORMATION

MAIN BUILDING	121,190 SF
SALES & C/O	4,212 SF
OFFICE	16,276 SF
RECEIVING / INVENTORY	147,034 SF
TOTAL	398,712 SF

GARAGE CENTER

SHARV STRUCTURES	5,841 SF
COVERED AREA	11,682 SF
OPEN AREA	11,111 SF
TOTAL	28,634 SF

VESTIBULES

MAIN ENTRANCE	606 SF
MARKET	646 SF
LOBBY	204 SF
TOTAL	1,456 SF

TOTAL BUILDING AREA 177,997 SF

EXISTING PARKING

RAVINE FRONT TOTAL ASPHALT	3.32 SF PER 1,000 SF
STANDARD PARKING STALLS	637 SPACES
ACCESSIBLE PARKING STALLS	14 SPACES
TOTAL PARKING STALLS	651 SPACES

UPDATED PARKING

RAVINE FRONT BUILDING AREA	2.87 SF PER 1,000 SF
STANDARD PARKING STALLS	440 SPACES
ACCESSIBLE PARKING STALLS	14 SPACES
TOTAL PARKING STALLS	454 SPACES

D 04-A CONCRETE CURB & GUTTER DETAIL

3'-0" MIN. SHOULDER @ 1.0% MIN. SLOPE

7'-0" RADIUS

"GUTTER SLOPE" TO MATCH ADJACENT PAVEMENT SLOPE, TRANSVERSE AND LONGITUDINAL

FINISHED GRADE

FINISHED GRADE OF PAVEMENT (REF. TO PAVING PLAN FOR TYPED) 4.000 S.L.

CONCRETE EXTENSION OF PAVEMENT BASE (IF APPLICABLE)

REFER TO SITE GENERAL NOTES FOR USE

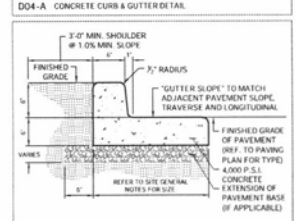

NOTES

1. CONTRACTION JOINTS SPACING 10 FEET O/C
2. EXPANSION JOINTS SPACING 100 FEET O/C
3. EXPANSION MATERIAL SHALL BE PERFORMED AS APHSTH M313 OR APPROVED EQUAL.
4. ALL JOINTS TO BE SEALED.

CONCRETE CURB AND GUTTER DETAIL

D04-A



REVISIONS

NO.	DATE	DESCRIPTION



Czark
Civil Engineering Inc.
3721 W. BROADWAY, SUITE 4
BISMARCK, ND 58102
479.664.8500 (OFFICE) 479.664.9640 (FAX)

SITE LAYOUT, PAVEMENT, AND STRIPING PLAN - PHASE 2

LOWE'S HOME CENTERS

HAINES AVENUE AND MALL DRIVE
RAPID CITY, SOUTH DAKOTA

DRAWN BY: ZDW
JOB NO: 15-1167
ORIGINAL ISSUE DATE: 12/09/2015
DESCRIPTION: PRELIMINARY
SHEET NO:

C2.1