

14PD034

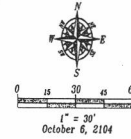
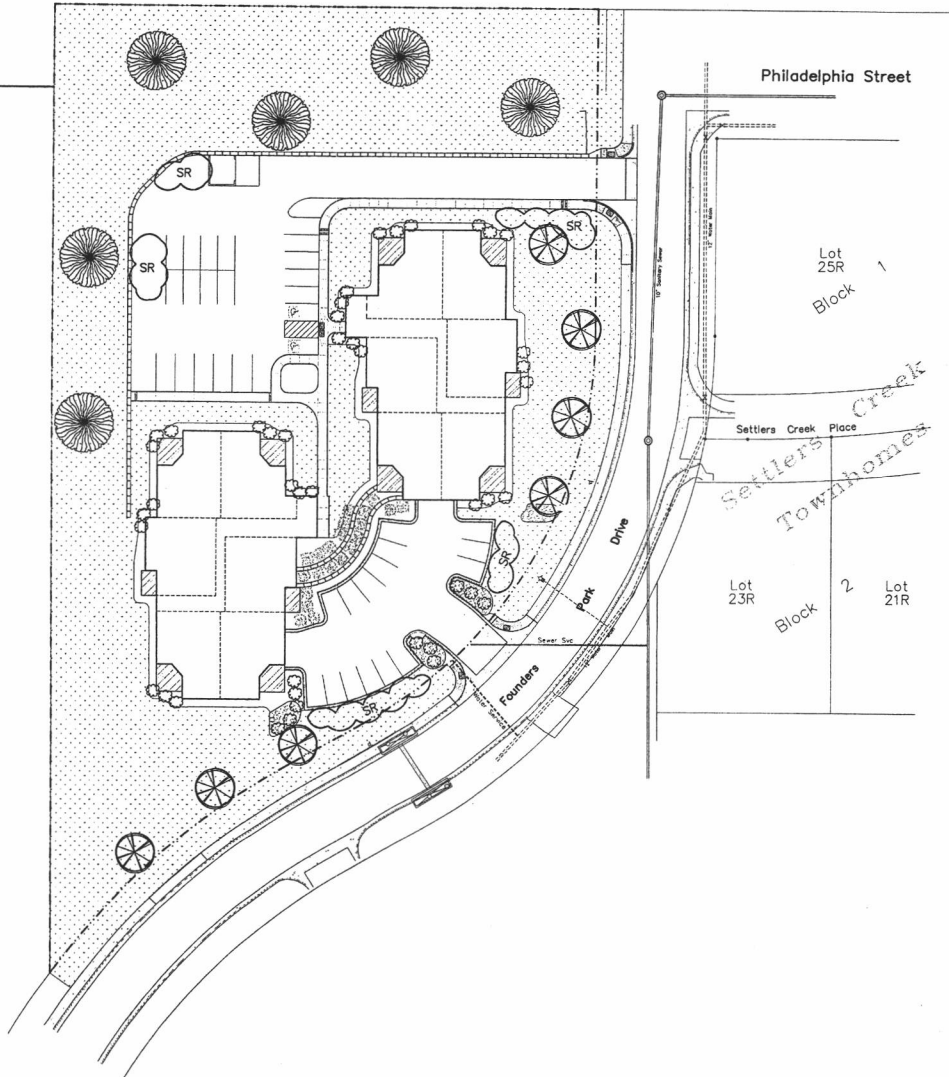

**SURVEYOR'S NOTES**

Utilities shown are from visual inspection, sketches provided by individual service providers and Utility Locates performed by South Dakota One Call. The actual location of utilities and service lines may vary from the information shown hereon. We assume no liability for utilities and services that are not marked or are incorrectly defined by utility locators.

Bench Mark: Master Bench - City BM 1019 (NAVD88 Datum)  
 Site Bench: CP 3257.03 (NAVD88 Datum) as shown.

**LEGEND**

- ⊙ = Sanitary Sewer Manhole (Unless noted)
- ⊕ = Fire Hydrant
- ⊖ = Water Valve
- ⊞ = Electric Transformer
- ⊠ = Telecommunications Pedestal
- ⊡ = Natural Gas Meter
- ⊘ = Sign
- = Barbed Wire Fence Line
- f— = Underground Electric
- T— = Underground Telephone
- G— = Natural Gas Line
- = Found Survey Monument as noted
- △ = Control Point

**Landscape Calculations**

Lot Area 109,640 SF  
 Building Area 18,588 SF  
 Required Landscape Pts 91,052 Pts

**Proposed Planting Key**

- (with point totals)
- Grass/Turf (10 pts/SY)  
 7,274 SY  
 72,740 Pts
  - Medium Deciduous Tree (1,000 pts)  
 Cutleaf Birch  
 or American Linden  
 or Hackberry  
 7 @ 1,000  
 7,000 Pts
  - Medium Coniferous Tree (1,000 pts)  
 Ponderosa Pine or  
 Colorado Blue Spruce  
 6 @ 1,000  
 6,000 Pts
  - Shrub (250 pts)  
 Buffalo Juniper or  
 Dakota Sunspot Potentilla  
 44 @ 250  
 11,000 Pts
  - Ground Cover (100 pts/SY)  
 60 SY  
 6,000 Pts

Proposed Landscape Pts 102,740 Pts  
 Surplus Landscape Pts 11,688 Pts

**Landscape Planting Note**

Plantings and placement reflect the ability of the site to sustain compliance with the landscape ordinance. This plan shall not however, constrain the owner from exercising personal discretion for individual landscape items based on seasonal availability and preference - provided that conformance to the ordinance is continually met.

**Snow Removal Note**

SR  
 Areas indicated by the above symbol shall be reserved for snow removal (stockpiles).

**Fisk Land Surveying & Consulting Engineers, Inc.**  
 1022 Main Street - P.O. Box 8154  
 Rapid City, South Dakota 57702  
 (605) 343-0338 (Cell) (605) 341-1112 (Fax)  
 info@fisklandsurveying.com



The information herein is copyrighted material, and specific to the site, client and purpose as stated.  
 No warranty or guarantee is expressed or implied to any party, for any other purpose at any time except as stated.

**Proposed Site Improvements**  
**Founders Park Village II**  
 W 1/2 NW 1/4 SE 1/4 (less planting and ROW)  
 Section 35, T2N, R7E, B.H.M.  
 Rapid City, Pennington County, South Dakota

Surveyed by: ML  
 Date: 8/05/14  
 Drawn by: RWF  
 Date: 8/19/14  
 Checked by: JF  
 Revisions

Project No.  
 14-08-03  
**Landscape Plan**

