

x = existing hooded light
 x = proposed historic hooded light [ground level]
 x = proposed hooded light [upper level]
 x = proposed flood lights [to light upper level]
 y = existing lights under walkway

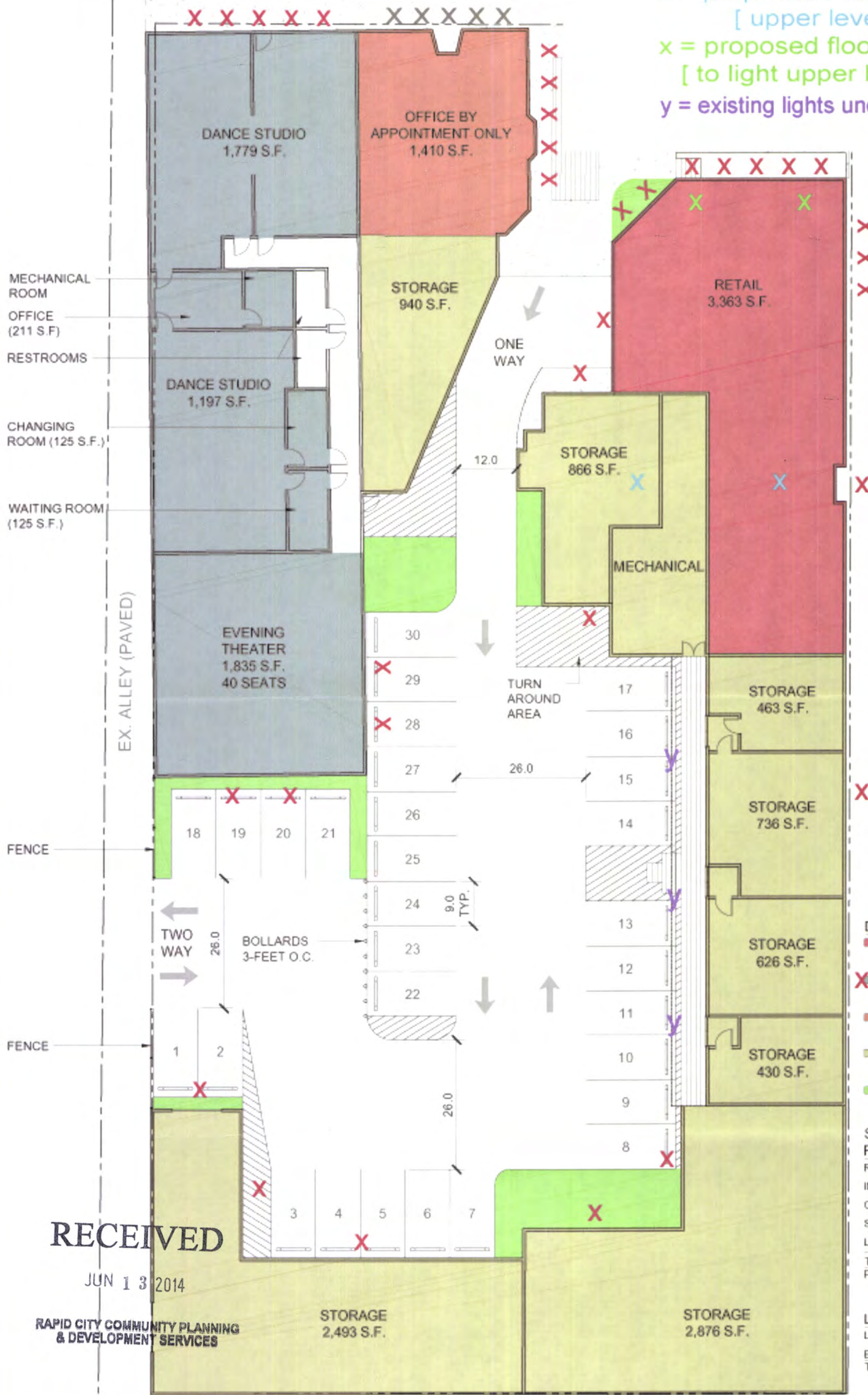

RAILROAD TRACKS

DEVELOPMENT SUMMARY

RETAIL	3,363 S.F.
(5 @ 1,000 S.F.)	
INDOOR REC.	5,668 S.F.
(4/7,000 S.F.)	
OFFICE	940 S.F.
(5 @ 1,000 S.F.)	
STORAGE	10,851 S.F.
(25 @ 1,000 S.F.)	
LANDSCAPING	1,235 S.F.

SITE USE/ PARKING REQUIRED

RETAIL	16.8
INDOOR REC.	22.7
OFFICE	4.7
STORAGE	2.7
LANDSCAPING	0
TOTAL	46.9
PARKING PROVIDE	30

LANDSCAPE POINTS

LOT SIZE	38,500 S.F.
BUILDINGS	22,000 S.F.
TOTAL POINTS	16,500

RECEIVED

JUN 13 2014

RAPID CITY COMMUNITY PLANNING & DEVELOPMENT SERVICES

MARCH 28, 2014

SHEET TITLE:
PROPOSED USAGE
 PROJECT:
ABY'S FEED AND SEED REDEVELOPMENT

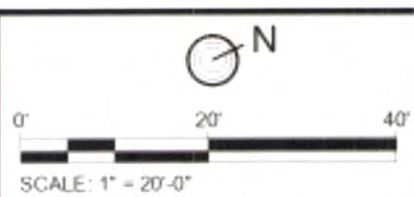

42 ND
 STREET
 DESIGN
 STUDIO
 42ND STREET DESIGN STUDIO
 522 7TH STREET SUITE 214
 RAPID CITY, SOUTH DAKOTA 57701
 PH: 605.303.5491