

MAY 27 2014

RAPID CITY COMMUNITY PLANNING
& DEVELOPMENT SERVICES

KEY NOTES	GENERAL NOTES
<ol style="list-style-type: none"> 1. EXISTING SIDEWALK. 2. EXISTING PARKING STRIPING. 3. EXISTING ACCESSIBLE PARKING. 4. EXISTING ACCESSIBLE RAMP. 5. ACCESSIBLE PATH OF TRAVEL. 6. EXISTING GAS METER LOCATION. 7. EXISTING WATER METER LOCATION. 8. EXISTING ELECTRICAL METERS & DISCONNECT. 9. FIRE SPRINKLER RISE. 10. EXISTING HOOR ACCESS LADDER. 11. EXISTING TRASH ENCLOSURE. 12. EXISTING ELECTRICAL TRANSFORMER. 13. EXISTING CONCRETE SLAB WITH 400 SF DESIGNATED FOR BLAZE PATIO. 14. EXISTING MONUMENT SIGN. 15. PATIO RAILING BY TENANT. 16. SELF-CLOSING, NON-LATCHING, NON-LOCKING PATIO GATE. 	<p>A. ALL SITE WORK INCLUDING PARKING, CURBING, PARKING, PARKING LOT LIGHTING, SIDEWALKS, LANDSCAPING, AND DUMPSTER ENCLOSURE ARE EXISTING UNLESS NOTED OTHERWISE.</p>

COPYRIGHT

This document and the information contained on it may not be reproduced or excerpted from without the express permission of the Architect. Unauthorized copying, disclosure or construction use are prohibited by the copyright law.

HARLAN R. FAUST ARCHITECT

1414 1/2 STREET, SUITE 204
OMAHA, NE 68177-3805
402.915.0878
402.915.7543 FAX
www.faustarch.com



04/28/14

CONSULTANTS

ISSUE RECORD

DATE	DESCRIPTION
02/24/2014	BLDG/HEALTH LANDLOAD
04/28/2014	CONSTRUCTION ISSUE

REVISIONS

NO.	DESCRIPTION

PROJECT

BLAZE PIZZA
FAST-FIRE'D

ALGONQUERE CROSSING
1725 EGLIN STREET
RAPID CITY, SOUTH DAKOTA 57701

PROJECT NUMBER:
090113

DRAWN BY: PROJECT MANAGER: CHECKED:
JF KB HW

SHEET

SITE PLAN

A1.00

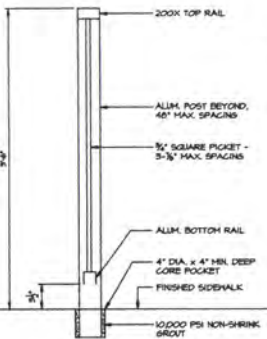

PATIO RAILING DETAIL
SCALE = 1/2" = 1'-0"

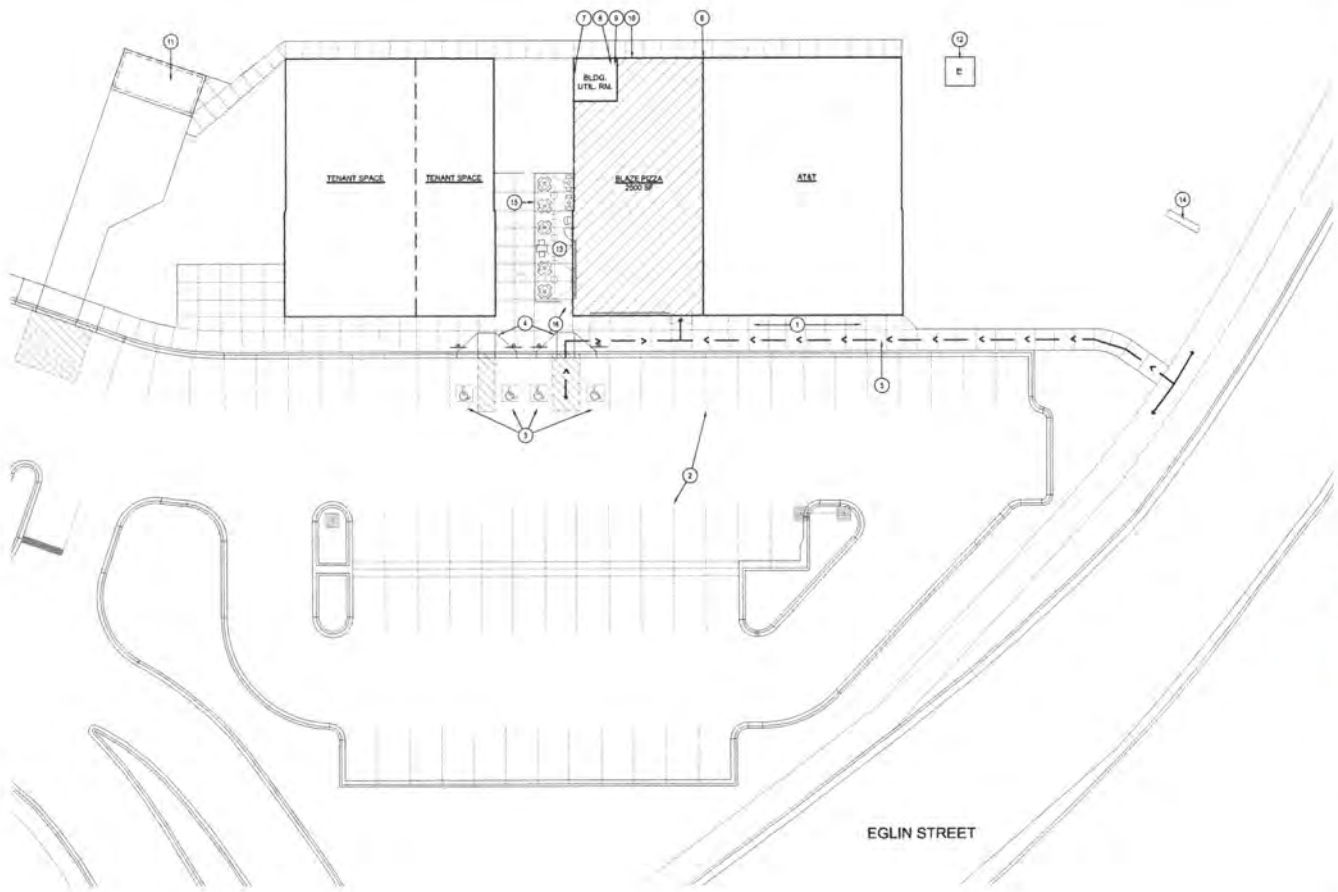

SITE PLAN
SCALE = 1/8" = 1'-0"