

NOTE: PROPOSED LANDSCAPING & EXISTING FOLIAGE NOT SHOWN FOR CLARITY. SEE A-2.1 FOR LANDSCAPING & EXISTING FOLIAGE.

PROPOSED RETAINING WALLS TO BE PAINTED COLOR #SW 2807 "ROOKWOOD MEDIUM BROWN" (TYP.) AS MANUFACTURED BY SHERWIN-WILLIAMS

PROPOSED VERSA-LOK RETAINING WALL (SEE CIVIL & STRUCTURAL)

PROPOSED WROUGHT-IRON NORTH FENCE LINE (APPROX. 72')(SEE A-5)

LIMIT OF CLEAN ROCK OVER GEOTEXTILE

PROPOSED CLEAN ROCK OVER GEOTEXTILE

PROPOSED H.C. RAMP LANDING EL. 3452.0'

PROPOSED CONCRETE STOOP EL. 3452.50' (SEE A-4)

PROPOSED H.C. ACCESSIBLE 1 IN 20 RAMP

PROPOSED BITUMINOUS PAVING

UNIVERSAL VAN ACCESS 16' X 18'

PROPOSED WROUGHT-IRON FENCE (SEE A-5)

GENERATOR ROOM

EQUIPMENT ROOM F.F.E. = 3452.50' AMSL

GATE

PROPOSED CABLE BRIDGE (SEE A-5)

PROPOSED 60' TALL FLAGPOLE TOWER (SEE A-3)

EXISTING TEE-BOXES

EQUIPMENT SHELTER

EQUIPMENT SHELTER

STANDARD PARKING 9' X 18'

PROPOSED WROUGHT-IRON EAST FENCE LINE (APPROX. 78')(SEE A-5)

PROPOSED WROUGHT-IRON SOUTH FENCE LINE (APPROX. 125')(SEE A-5)

PROPOSED BITUMINOUS PAVING

PROPOSED TRANSFORMER & METER PEDESTAL

PROPOSED VERSA-LOK RETAINING WALL (SEE CIVIL & STRUCTURAL)

PROPOSED 10' WIDE UTILITY RIGHT OF WAY

PROPOSED 7000 S.F. LAND SPACE

NOTE: ALL WALL DIMENSIONS TO EXPOSED BASE OF WALL.

NOT FOR CONSTRUCTION

DESIGN 1

ROBERT J DAVIS, AIA ARCHITECT 9973 VALLEY VIEW RD. EDEN PRAIRIE, MN 55344 (952) 903-9299

VERIZON WIRELESS

10801 BUSH LAKE ROAD BLOOMINGTON, MN 55438 (612) 720-0030

PROJECT

2005125051

RCYC SW RAPID CITY

TOMAHAWK DRIVE RAPID CITY, SD 57702

SHEET CONTENTS: ENLARGED SITE PLAN

DRAWN BY: A. STANLEY

DATE: 05-06-13

CHECKED BY: TAB/DRT

REV. A 09-13-13

REV. B 11-26-13

1 ENLARGED SITE PLAN SCALE: 3/32" = 1'-0"

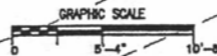

NORTH



PROPOSED 14' WIDE BITUMINOUS ACCESS

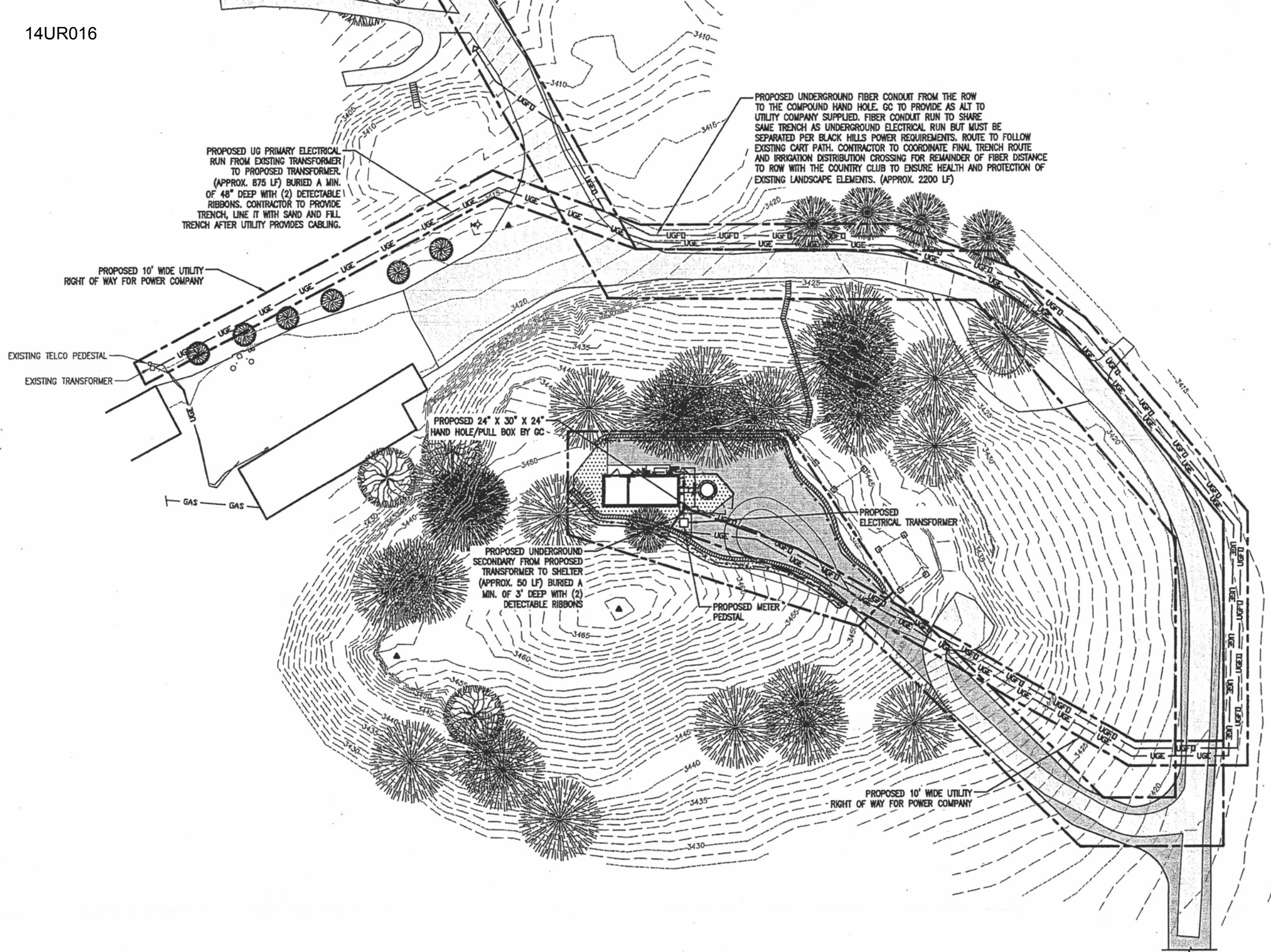

PROPOSED UG PRIMARY ELECTRICAL RUN FROM EXISTING TRANSFORMER TO PROPOSED TRANSFORMER. (APPROX. 675 LF) BURIED A MIN. OF 48" DEEP WITH (2) DETECTABLE RIBBONS. CONTRACTOR TO PROVIDE TRENCH, LINE IT WITH SAND AND FILL TRENCH AFTER UTILITY PROVIDES CABLING.

PROPOSED UNDERGROUND FIBER CONDUIT FROM THE ROW TO THE COMPOUND HAND HOLE. GC TO PROVIDE AS ALT TO UTILITY COMPANY SUPPLIED. FIBER CONDUIT RUN TO SHARE SAME TRENCH AS UNDERGROUND ELECTRICAL RUN BUT MUST BE SEPARATED PER BLACK HILLS POWER REQUIREMENTS. ROUTE TO FOLLOW EXISTING CART PATH. CONTRACTOR TO COORDINATE FINAL TRENCH ROUTE AND IRRIGATION DISTRIBUTION CROSSING FOR REMAINDER OF FIBER DISTANCE TO ROW WITH THE COUNTRY CLUB TO ENSURE HEALTH AND PROTECTION OF EXISTING LANDSCAPE ELEMENTS. (APPROX. 2200 LF)

PROPOSED 10' WIDE UTILITY RIGHT OF WAY FOR POWER COMPANY

EXISTING TELCO PEDESTAL
EXISTING TRANSFORMER

PROPOSED 24" X 30" X 24" HAND HOLE/PULL BOX BY GC

PROPOSED UNDERGROUND SECONDARY FROM PROPOSED TRANSFORMER TO SHELTER (APPROX. 50 LF) BURIED A MIN. OF 3' DEEP WITH (2) DETECTABLE RIBBONS

PROPOSED METER PEDSTAL

PROPOSED ELECTRICAL TRANSFORMER

PROPOSED 10' WIDE UTILITY RIGHT OF WAY FOR POWER COMPANY

DESIGN 1

ROBERT J DAVIS, AIA
ARCHITECT
9873 VALLEY VIEW RD.
EDEN PRAIRIE, MN 55344
(952) 903-9299

VERIZON WIRELESS

10801 BUSH LAKE ROAD
BLOOMINGTON, MN 55438
(612) 720-0030

PROJECT

2005125051

**RCYC
SW RAPID CITY**

TOMAHAWK DRIVE
RAPID CITY, SD 57702

**SHEET CONTENTS:
SITE UTILITY PLAN**

DRAWN BY:	A. STANLEY
DATE:	05-06-13
CHECKED BY:	TAB/DR
REV. A	09-13-13
REV. B	11-26-13

