



File Number: 13325
 Location: SW 1/4, SW 1/4, SECTION 35, T2N, R7E, B9W
 Surveyed By: HANSON SURVEYING & MAPPING
 Designed By: JSC
 Drawn By: JSC
 Checked By: JSC

RECEIVED
 FEB 6 2 2014
 RAPID CITY COMMUNITY PLANNING & DEVELOPMENT SERVICES
 JUNE 2013

MOUNTAIN VIEW CAR WASH REDEVELOPMENT PROJECT
 502 MOUNTAIN VIEW ROAD
 RAPID CITY, SOUTH DAKOTA

8/22/2013
 Revised / Date

LAYOUT PLAN

Sheet Name:
C2 of C10

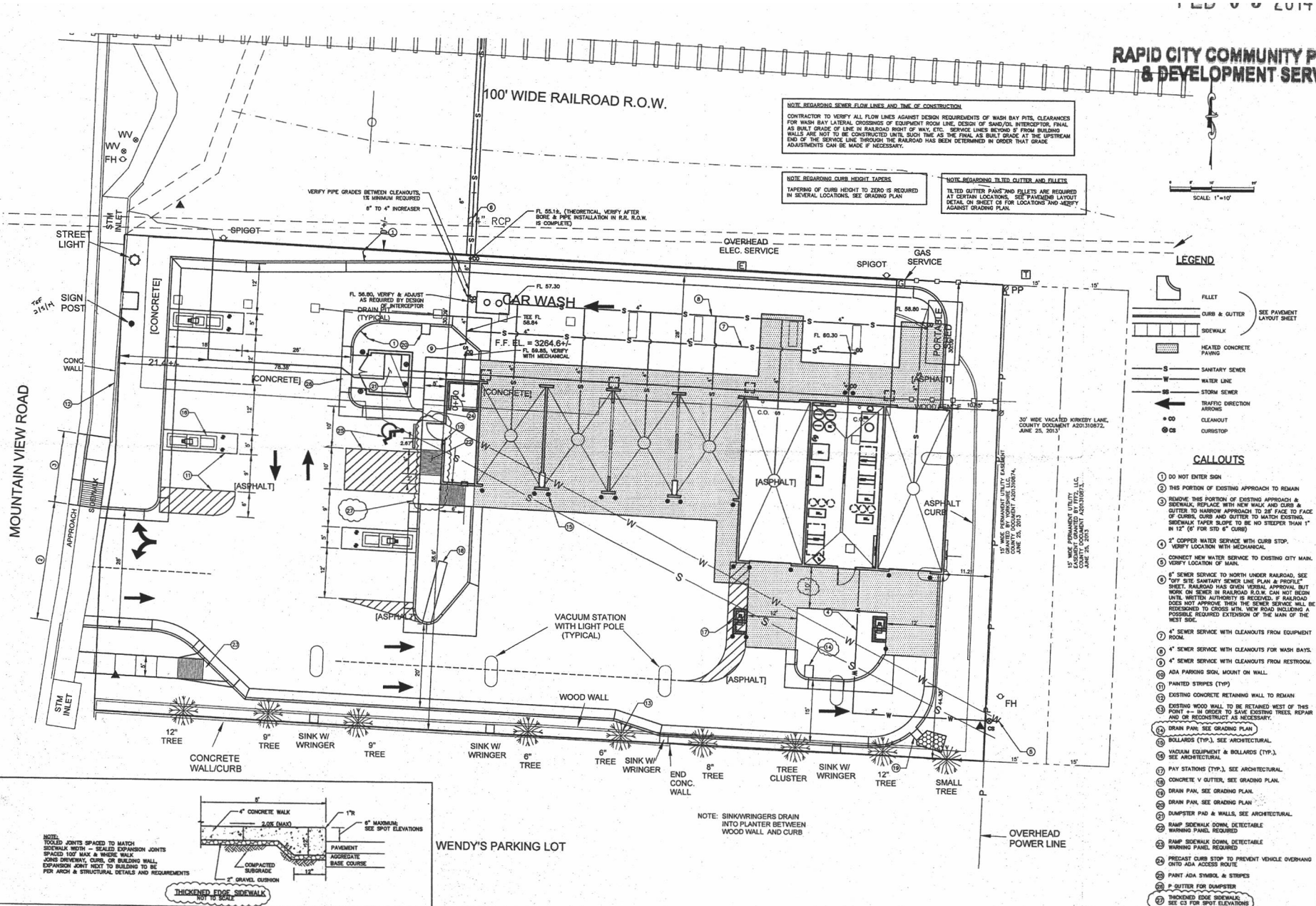

NOTE REGARDING SEWER FLOW LINES AND TIME OF CONSTRUCTION
 CONTRACTOR TO VERIFY ALL FLOW LINES AGAINST DESIGN REQUIREMENTS OF WASH BAY PITS, CLEARANCES FOR WASH BAY LATERAL CROSSINGS OF EQUIPMENT ROOM LINE, DESIGN OF SAND/OIL INTERCEPTOR, FINAL AS BUILT GRADE OF LINE IN RAILROAD RIGHT OF WAY, ETC. SERVICE LINES BEYOND 8' FROM BUILDING WALLS ARE NOT TO BE CONSTRUCTED UNTIL SUCH TIME AS THE FINAL AS BUILT GRADE AT THE UPSTREAM END OF THE SERVICE LINE THROUGH THE RAILROAD HAS BEEN DETERMINED IN ORDER THAT GRADE ADJUSTMENTS CAN BE MADE IF NECESSARY.

NOTE REGARDING CURB HEIGHT TAPERS
 TAPERING OF CURB HEIGHT TO ZERO IS REQUIRED IN SEVERAL LOCATIONS. SEE GRADING PLAN.

NOTE REGARDING TILTED CUTTER AND FILLETS
 TILTED CUTTER PANS AND FILLETS ARE REQUIRED AT CERTAIN LOCATIONS. SEE PARKING LAYOUT DETAIL ON SHEET C3 FOR LOCATIONS AND VERIFY AGAINST GRADING PLAN.

SCALE: 1"=10'

LEGEND

- FILLET
- CURB & GUTTER SEE PAVEMENT LAYOUT SHEET
- SIDEWALK
- HEATED CONCRETE PAVING
- SANITARY SEWER
- WATER LINE
- STORM SEWER
- TRAFFIC DIRECTION ARROWS
- CLEANOUT
- CURBSTOP

CALLOUTS

- 1 DO NOT ENTER SIGN
- 2 THIS PORTION OF EXISTING APPROACH TO REMAIN
- 3 REMOVE THIS PORTION OF EXISTING APPROACH & SIDEWALK, REPLACE WITH NEW WALK AND CURB & GUTTER TO NARROW APPROACH TO 2' FACE TO FACE OF CURBS, CURB AND GUTTER TO MATCH EXISTING. SIDEWALK TAPER SLOPE TO BE NO STEEPER THAN 1" IN 12" (2" FOR STD 6" CURB)
- 4 2" COPPER WATER SERVICE WITH CURB STOP. VERIFY LOCATION WITH MECHANICAL.
- 5 CONNECT NEW WATER SERVICE TO EXISTING CITY MAIN. VERIFY LOCATION OF MAIN.
- 6 4" SEWER SERVICE TO NORTH UNDER RAILROAD. SEE "01" SITE SANITARY SEWER LINE PLAN & PROFILE SHEET. RAILROAD HAS GIVEN VERBAL APPROVAL BUT WORK ON SITES IN RAILROAD R.O.W. CAN NOT BEGIN UNTIL WRITTEN AUTHORITY IS RECEIVED. IF RAILROAD DOES NOT APPROVE, THIS SEWER SERVICE WILL BE REDESIGNED TO CROSS Mtn. VIEW ROAD INCLUDING A POSSIBLE REQUIRED EXTENSION OF THE MAIN OF THE WEST SIDE.
- 7 4" SEWER SERVICE WITH CLEANOUTS FROM EQUIPMENT ROOM.
- 8 4" SEWER SERVICE WITH CLEANOUTS FOR WASH BAYS.
- 9 4" SEWER SERVICE WITH CLEANOUTS FROM RESTROOM.
- 10 ADA PARKING SIGN, MOUNT ON WALL.
- 11 PAINTED STRIPES (TYP)
- 12 EXISTING CONCRETE RETAINING WALL TO REMAIN
- 13 EXISTING WOOD WALL TO BE RETAINED WEST OF THIS POINT - IN ORDER TO SAVE EXISTING TREES. REPAIR AND/OR RECONSTRUCT AS NECESSARY.
- 14 DRAIN PAN SEE GRADING PLAN
- 15 BOLLARDS (TYP.) SEE ARCHITECTURAL
- 16 VACUUM EQUIPMENT & BOLLARDS (TYP.) SEE ARCHITECTURAL
- 17 PAY STATIONS (TYP.) SEE ARCHITECTURAL
- 18 CONCRETE V GUTTER, SEE GRADING PLAN.
- 19 DRAIN PAN, SEE GRADING PLAN.
- 20 DRAIN PAN, SEE GRADING PLAN
- 21 DUMPSTER PAD & WALLS, SEE ARCHITECTURAL.
- 22 RAMP SIDEWALK DOWN, DETECTABLE WARNING PANEL REQUIRED
- 23 RAMP SIDEWALK DOWN, DETECTABLE WARNING PANEL REQUIRED
- 24 PRECAST CURB STOP TO PREVENT VEHICLE OVERHANG ONTO ADA ACCESS ROUTE
- 25 PAINT ADA SYMBOL & STRIPES
- 26 P GUTTER FOR DUMPSTER
- 27 THICKENED EDGE SIDEWALK. SEE C3 FOR SPOT ELEVATIONS.

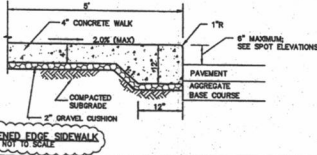

NOTE: SINKWRINGERS DRAIN INTO PLANTER BETWEEN WOOD WALL AND CURB

WENDY'S PARKING LOT

OVERHEAD POWER LINE

NOTE: TOOKED JOINTS SPACED TO MATCH SIDEWALK WIDTH - SEALED EXPANSION JOINTS SPACED 10' MAX & WALK WALK JOINTS DIRECTION, CURB OR BUILDING WALL EXPANSION JOINT NEXT TO BUILDING TO BE PER ARCH & STRUCTURAL DETAILS AND REQUIREMENTS

THICKENED EDGE SIDEWALK