

RECEIVED

13PD053

DEC 13 2013

RAPID CITY COMMUNITY PLANNING & DEVELOPMENT SERVICES

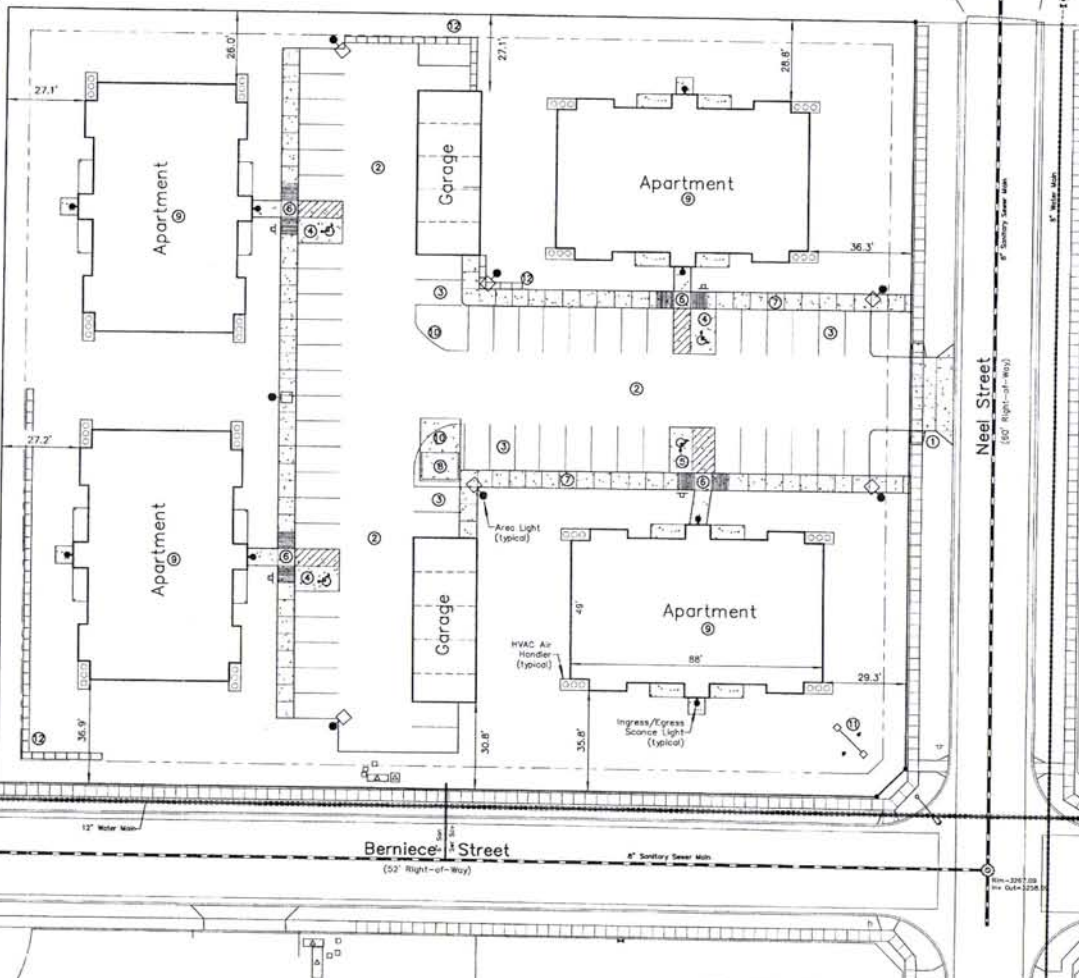

- ① Construct 26' Wide Reinforced Concrete Approach with 5' Tapers, and remove existing SW. Replace with Reinforced Concrete SW 6'7/8" - See Geotech Page 16
- ② Construct 26' Asphalt Circulation Lane 4.5'7/8" - See Geotech Page 17
- ③ Construct 9' x 16' Asphalt Parking Stalls 4.5'7/8" - See Geotech Page 17
- ④ Construct Concrete HC Parking Stal/Aisle 2.00% Max Grade (See Grading Plan) 6'7/8" - See Geotech Page 16
- ⑤ Construct Concrete HC Parking Stal/Aisle van Accessible (16' Wide) 2.00% Max Grade (See Grading Plan) 6'7/8" - See Geotech Page 16
- ⑥ Construct Concrete HC Ramps See Grading Plan Details
- ⑦ Construct 6' Wide Thickened Edge Concrete Sidewalk - 6" Reveal
- ⑧ Construct 10' x 14' CMU Release Enclosure with 12' x 14' Concrete Apron 6'7/8" - See Geotech Page 16
- ⑨ Construct building in accordance with architectural plans. Construct 6' x 6' concrete slopes and walkways at ingress/egress locations as shown. Construct concrete pads for air handlers as indicated in the architectural drawings.
- ⑩ Stripe Hazard and maintain barrier free access for IDDM compliant Emergency Vehicle Turnaround (Figure 2-8 - Tee Shape)
- ⑪ Construct Monument Signs with ground lights See approved sign details
- ⑫ Construct Red Brick Segmental Unit Retaining Wall. See Grading Plan for wall heights and profile details.

Fisk Land Surveying & Consulting Engineers, Inc.
 1022 Main Street - P.O. Box 8154
 Rapid City, South Dakota 57709
 (605) 346-1338 (ph) (605) 341-1112 (fx)
 www.fiskengineers.com



The information herein is unreviewed material, and specific to the data, client and purpose as stated. No warranty or guarantee is expressed or implied in any part, for any other purpose at any time, except as stated.

Proposed Site Plan - Pilot Properties
 Lot 4, Block 1, Big Sky
 Business Park
 Rapid City, Pennington County, South Dakota

Surveyed by:	GD
Date:	10/23/13
Drawn by:	RWF
Date:	12/6/13
Checked by:	WF

Revisions

Project No.
13-10-02

Site Plan

3 of 10

PRELIMINARY

ONE CALL
 800.FRS.DIGS
 1-800-761-7474