

	SQUARE FOOTAGE
UNIT 1	791
UNIT 2	1,036
UNIT 3	1,036
UNIT 4	1,277
HALLWAY	350
MAIN FLOOR	4,890
UNIT 5	791
UNIT 6	1,036
UNIT 7	1,036
UNIT 8	1,277
SECOND FLOOR	500
HALLWAY	4,890
UNIT 9	791
UNIT 10	1,036
UNIT 11	1,036
UNIT 12	1,277
HALLWAY	350
THIRD FLOOR	4,890
TOTAL	14,870

800 SOUTH STREET  
SUITE 101  
RAPID CITY, SD 57701  
PH: (605) 348-9971  
www.drawingboard.com

Computer Aided Design

THIS DOCUMENT IS (A) THE PROPERTY OF PILOT PROPERTIES, LLC AND SHALL NOT BE USED FOR ANY OTHER PROJECT FOR ANY REASON WITHOUT THE WRITTEN CONSENT OF PILOT PROPERTIES, LLC.

Project title:  
**PILOT PROPERTIES, LLC  
AARON CHRISTENSEN  
(605) 381-1674**  
arch@pilotproperties.com

Sheet title:  
**12 PLEX  
MAIN FLOOR PLAN  
RAPID CITY, SD**

Date: 10/22/13  
Designed: RJT  
Drawn:  
Checked:  
Project Number: 13013  
File Name: 13013a1.DWG

Sheet:  
**22**  
THIS IS SHEET 22 OF 23 SHEET OF A SET OF DRAWINGS AND CAN NOT BE USED ON ITS OWN. COORDINATE ALL SHEETS TOGETHER - 17X4

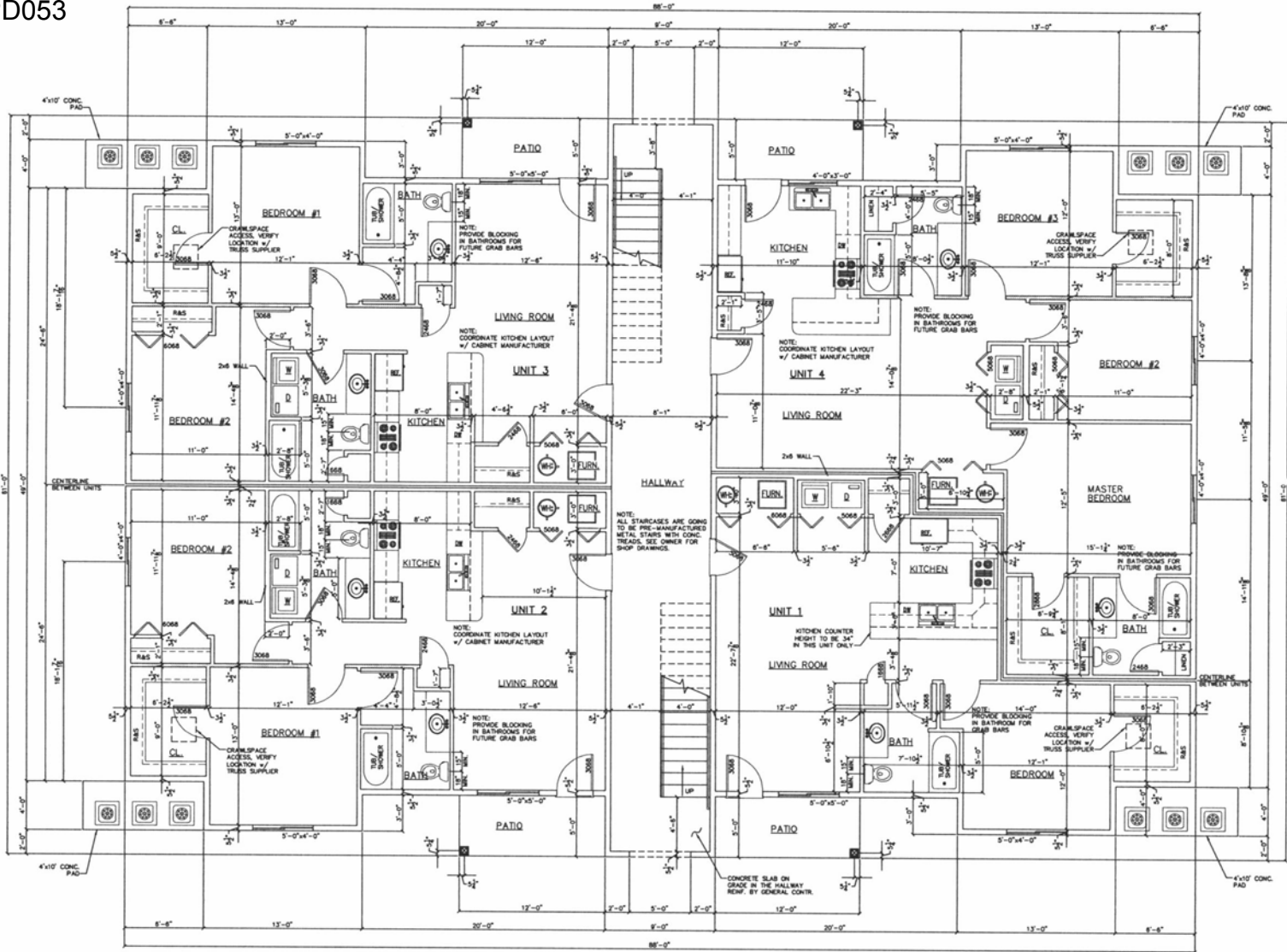

- WINDOW NOTES:**
- 1) PROVIDE SAFETY GLAZING AS REQUIRED BY LATEST EDITION OF THE IRC AND LOCAL REQUIREMENTS.
  - 2) SIZES GIVEN ON FLOOR PLANS ARE FOR BEDDING PURPOSES ONLY. ROUGH-OPENINGS MAY VARY FROM ONE WINDOW MANUFACTURER TO ANOTHER. COORDINATE SIZE, STYLE, LOCATION & MANUFACTURER w/ OWNER.
  - 3) WINDOW STYLE BY OWNER.
  - 4) GROSS WINDOWS SHALL HAVE A MINIMUM NET CLEAR OPERABLE AREA OF 5.7 SQUARE FEET. THE MINIMUM NET CLEAR OPERABLE HEIGHT SHALL BE 24". THE MINIMUM NET CLEAR OPERABLE WIDTH SHALL BE 20". THE SILL HEIGHT SHALL BE NO MORE THAN 44" (48" IN RAPID CITY) ABOVE FINISHED FLOOR. GROSS WINDOWS SHALL BE IN ALL ROOMS LABELED AS BEDROOMS (DINING, ETC.)
  - 5) FIRE ESCAPE & RESCUE WINDOWS REQUIRED PER IRC SECTION R310 AND LOCAL AMENDMENTS.

- PLAN NOTES:**
- 1) CONTRACTOR/SUBCONTRACTOR SHALL VERIFY ALL CONDITIONS AND DIMENSIONS PRIOR TO STARTING ANY WORK.
  - 2) ALL DIMENSIONS ARE FROM ROUGH FRAME FACE OF EXTERIOR WALLS TO ROUGH FRAME FACE OF INTERIOR WALLS.
  - 3) ALL INTERIOR WALLS ARE 2x4 CONSTRUCTION UNLESS NOTED OTHERWISE AND ALL EXTERIOR WALLS ON THE MAIN FLOOR ARE 2x6 AND ALL EXTERIOR WALLS ON SECOND AND THIRD FLOORS ARE 2x4 U.S.D. ALL FRAMING MEMBERS SHALL BE NO. 2 OR BETTER, AND SHALL COMPLY WITH THE IRC.
  - 4) ALL TRADES TO COMPLY TO ALL STATE, COUNTY, AND LOCAL CODES AND REGULATIONS, AND IRC CURRENT EDITION.
  - 5) ALL CONSTRUCTION, ETC. PER IRC - CURRENT EDITION.
  - 6) ALL ROOF TRUSSES TO BE PRE-ENGINEERED AND DESIGNED BY A TRUSS MANUFACTURER. VERIFY ALL DIMENSIONS PRIOR TO STARTING WORK.
  - 7) ALL WOOD IN CONTACT w/ GRADE OR CONCRETE SHALL BE TREATED OR DECAY-INHIBIT RESISTANT.
  - 8) INSTALL SMOKE ALARMS AS REQUIRED PER IRC.

**MAIN FLOOR PLAN**  
SCALE: 1/4" = 1'-0"

- PLAN LEGEND:**
- IRC - DENOTES INTERNATIONAL BUILDING CODE (CURRENT EDITION)
  - R/S - DENOTES RIGID AND SHELF IN CLOSET
  - F.D. - DENOTES FLOOR DRAIN
  - G.C. - DENOTES GENERAL CONTRACTOR

NOTE: WHILE EVERY ATTEMPT HAS BEEN MADE DURING THE PREPARATION OF THESE PLANS TO AVOID MISTAKES, THE MAKER CANNOT GUARANTEE AGAINST HUMAN ERROR. THE CONTRACTORS AND OWNER MUST CHECK AND VERIFY ALL DIMENSIONS AND OTHER DETAILS AND COORDINATE CONSTRUCTION PRICES TO MINIMIZE AND PREVENT CONFLICTS AND PROBLEMS. DO NOT SCALE THESE DRAWINGS.