

MAY 23 2013

RECEIVED

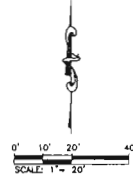

CONSTRUCTION LAYOUT NOTES:

CURB GEOMETRY:

EDGE OF PAVEMENT TO TOP-BACK-CURB = 0.34'
 EDGE OF PAVEMENT TO CURB = 0.13'
 OUTER TO TOP-BACK-CURB = 0.50'
 THERE ARE DETAILS ON THE DETAIL SHEETS.

ELEVATION INTERFERENCES:

ELEVATIONS TO ANYWHERE ALONG THE CURB SHALL BE DETERMINED BY CONTAINING THE CONCRETE SLOPE TO THE EDGE OF PAVEMENT, AND ADDING 0.34' TO OBTAIN TOP-BACK-CURB ELEVATION.

HANDICAP RAMP:

TOP OF RAMP IS 6.0' FROM OUTER FLOW LINE, UNLESS OTHERWISE CALLED OUT. THE RISE SHALL NOT EXCEED 0.50'. GROSS SLOPE ON THE RAMP MUST NOT EXCEED 2%. THERE ARE DETAILS ON THE DETAIL SHEETS - SEE ALSO THE LANDING AREA REQUIREMENTS AND HANDICAP CURB REQUIREMENTS. IMPROPERLY CONSTRUCTED HANDICAP RAMP WILL BE REJECTED.

VERTICAL CHANGES IN SLOPE:

WHERE CHANGES IN SLOPE OCCUR, CONSTRUCT THE NEW SURFACE WITHOUT SHARP VERTICAL BENDS IN THE CONCRETE/CURB/SIDEWALK. SMOOTH THE CONSTRUCTION TO PRODUCE A VERTICALLY CURVED SURFACE. SHARP CHANGES IN GRADE WILL BE REJECTED.

PAVEMENT MARKINGS:

NEW PAVEMENT MARKINGS, INCLUDING WHITE PARKING LOT STRIPES AND BLUE STRIPES AND LOGO IF HANDICAPPED PARKING, SHALL BE PROVIDED AND APPLIED BY THE CONTRACTOR AS SPECIFIED IN SECTION 93 OF THE CITY OF RAPID CITY STANDARD SPECIFICATIONS.

PARKING STALL DIMENSIONS:

PARKING STALLS ADJACENT TO CURB SHALL BE 9' WIDE AS MEASURED ON THE PAVEMENT. NO PART OF THE CURB MAY BE INCLUDED IN THE 9' DIMENSION STRIKE AS SHOWN.

THIS DRAWING IS SCALED; VERIFY YOUR LAYOUT BEFORE BEGINNING.

JOINT LAYOUT:

JOINT LAYOUT SHOWN ON PLANS MAY BE ADJUSTED. ENSURE CONCRETE PANELS DO NOT EXCEED 12' IN ANY DIRECTION.

SITE LIGHTING:

WALL MOUNTED LIGHTS TO BE USED. SEE ARCHITECTURAL.

SEE SHEET # FOR ALL UTILITY INSTALLATIONS.

FIRE TRUCK TURNING VEHICLE SIMULATED

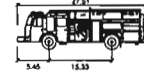

Engine 4 RC Fire

Wheel	8.17
Track	8.17
Steering Angle	22.5

PARKING CALCULATION:

APARTMENT COMPLEX

PHASE 1 ONLY

2 BUILDINGS @ 12 UNITS

24 UNITS TOTAL

TOTAL SPACES REQUIRED

TOTAL SPACES PROVIDED

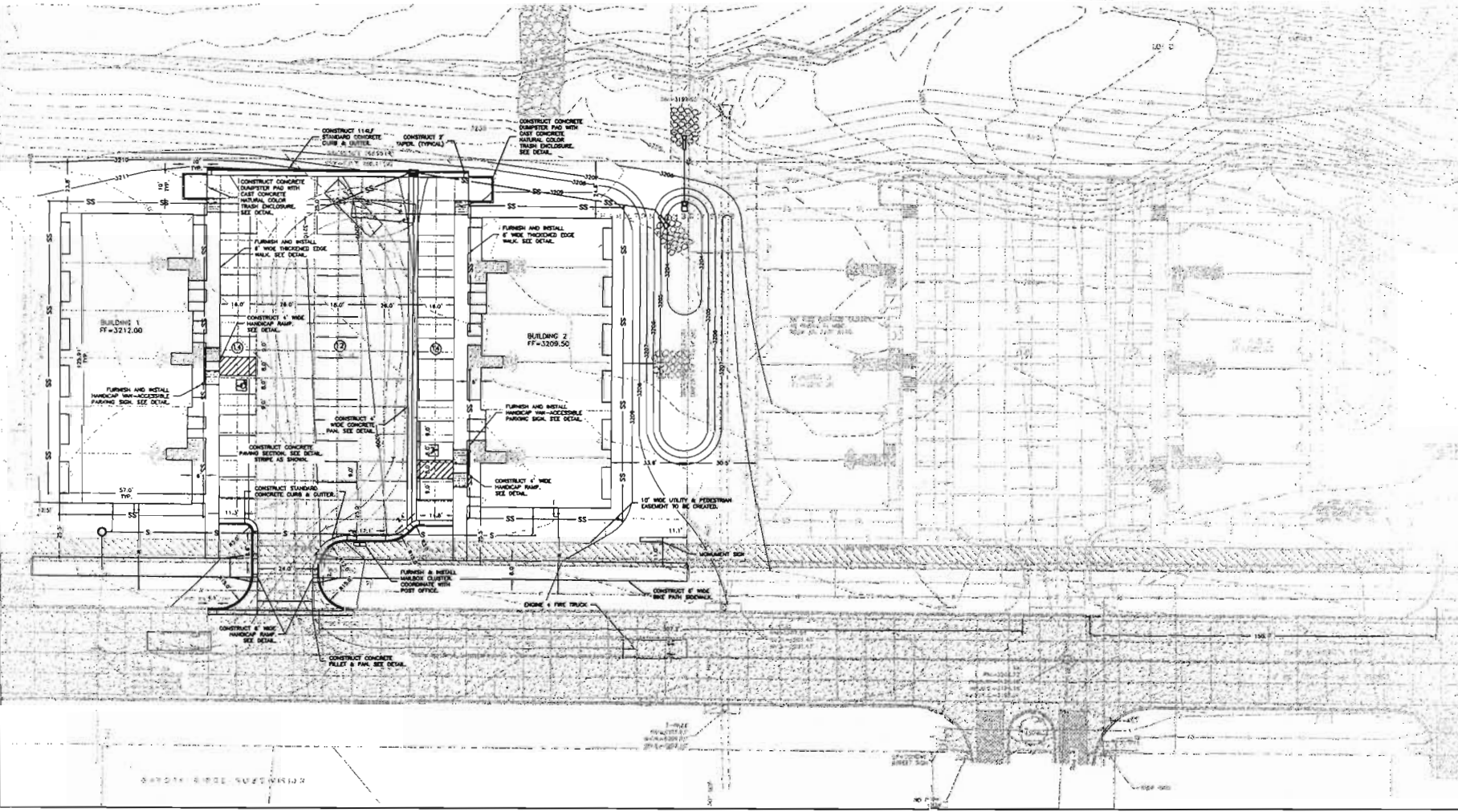

RENNERT & ASSOCIATES, LLC.
 1111 UNIVERSITY AVENUE, SUITE 200
 RAPID CITY, SD 57701-2000
 PHONE: 605.342.1234
 FAX: 605.342.1235
 WWW: RENNERT.COM



Scale	1" = 20'
Designed By	DRS
Checked By	DRS
Drawn By	DRS
Project No.	13PD017
Sheet No.	7

LOCATION:
MINNESOTA STREET APARTMENTS - PHASE I
 LOT B OF HAMILTON SUBDIVISION
 LOCATED IN THE SE1/4 OF THE NE1/4
 RAPID CITY, PENNINGTON COUNTY, SOUTH DAKOTA

PREPARED FOR:
 M&E HUNT TO LLP
 14TH & HAMILTON AVENUES
 2318 RAPID HILL ROAD
 RAPID CITY, SD 57703

DRAWING NO. #2522
 SHEET NO. SITE LAYOUT STRIPING PLAN

