

THIS DOCUMENT IS THE PROPERTY OF THE CITY OF LOS ANGELES. IT IS TO BE USED ONLY FOR THE PROJECT AND SITE SPECIFICALLY IDENTIFIED HEREIN. IT IS NOT TO BE REPRODUCED, COPIED, OR TRANSMITTED IN ANY FORM OR BY ANY MEANS, ELECTRONIC OR MECHANICAL, INCLUDING PHOTOCOPYING, RECORDING, OR BY ANY INFORMATION STORAGE AND RETRIEVAL SYSTEM, WITHOUT THE WRITTEN PERMISSION OF THE CITY OF LOS ANGELES. THE CITY OF LOS ANGELES DOES NOT WARRANT THE ACCURACY OR COMPLETENESS OF THE INFORMATION, AND THE CITY OF LOS ANGELES ACCEPTS NO LIABILITY FOR DAMAGES, INCLUDING CONSEQUENTIAL DAMAGES, ARISING FROM THE USE OF THIS DOCUMENT.

PREPARED FOR  
STILLWATER HOMES

APPROVED:  
REVISION:  
CATEGORY: 02/13

PROJECT: 10348 STILLWATER  
DRAWN BY: ZALYTH/HELL  
DATE: APR 10, 2013

303 WEST 10TH ST  
LOS ANGELES, CA 90057  
PH: (213) 475-1449  
F: (213) 475-1449  
www.lacounty.gov

**RECEIVED**  
 MAY 23 2013  
 RAPID CITY COMMUNITY PLANNING  
 & DEVELOPMENT SERVICES

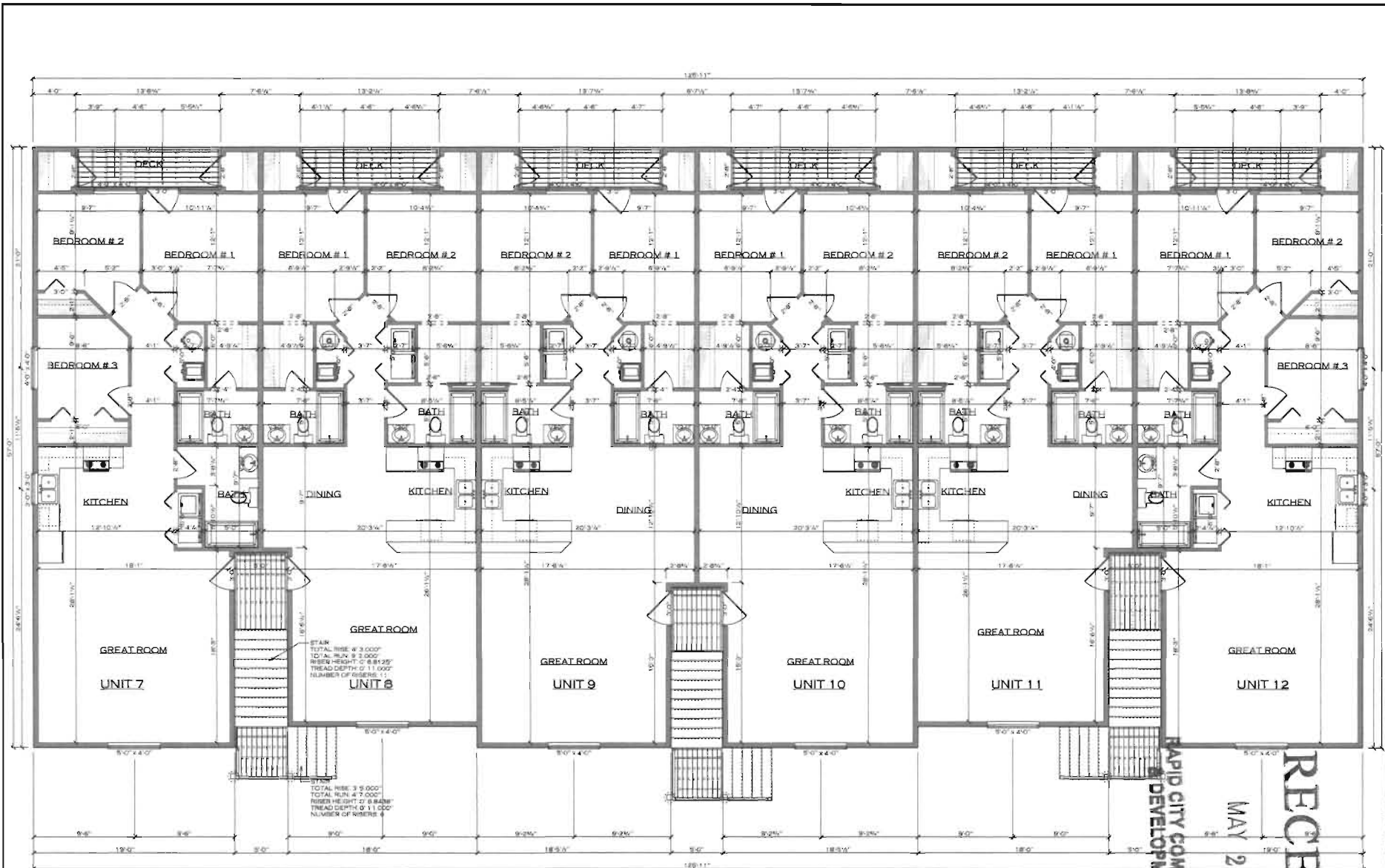

**2ND FLOOR LAYOUT**  
6048 - 11-110

NAME	AREA
UNIT 7 & 12	1133 sq. FT.
UNIT 8 & 11	1050 sq. FT.
UNIT 9 & 10	1086 sq. FT.

STAIR  
TOTAL RISE: 4' 3.000"  
TOTAL RUN: 8' 2.000"  
RISER HEIGHT: 0' 8.8125"  
TREAD DEPTH: 0' 11.000"  
NUMBER OF RISERS: 5

STAIR  
TOTAL RISE: 3' 9.000"  
TOTAL RUN: 7' 0.000"  
RISER HEIGHT: 0' 8.8125"  
TREAD DEPTH: 0' 11.000"  
NUMBER OF RISERS: 4

**RAPID CITY COMMUNITY PLANNING  
DEVELOPMENT SERVICES**

MAY 23 2013

**RECEIVED**

PROJECT: 15P41818 - WATER  
 DRAWN BY: ZACH BELL  
 DATE: APR. 10, 2013  
 APPROVED:  
 REVISION:  
 CATEGORY: FF/EX  
 PREPARED FOR:  
 STILLWATER HOMES  
 Home Center  
 1500 N. 15th St., Rapid City, SD 57701  
 605-791-1111  
 4 OF 5