

PROJECT LOCATION

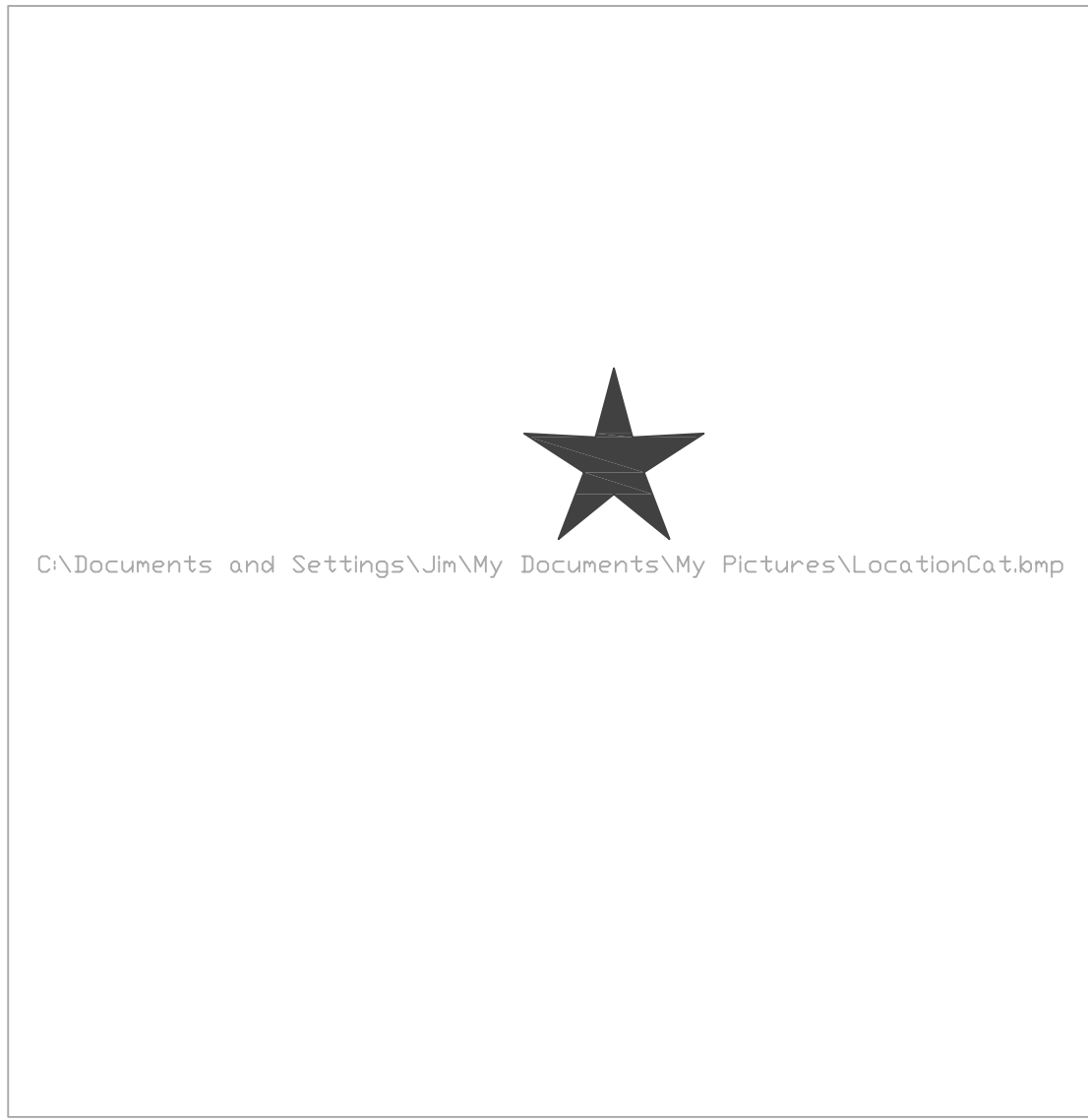

MINIMUM SETBACK FROM ALL LOT LINES: 50'
 MAXIMUM NUMBER OF STORIES: 4
 MAXIMUM BUILDING HEIGHT: 52'
 LIGHTING AT ALL ENTRANCES AND PARKING AREAS
 LANDSCAPING AND HANDICAP PARKING PER ORDINANCE

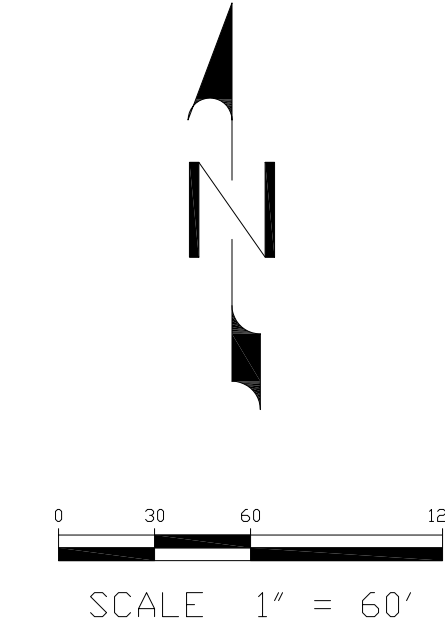
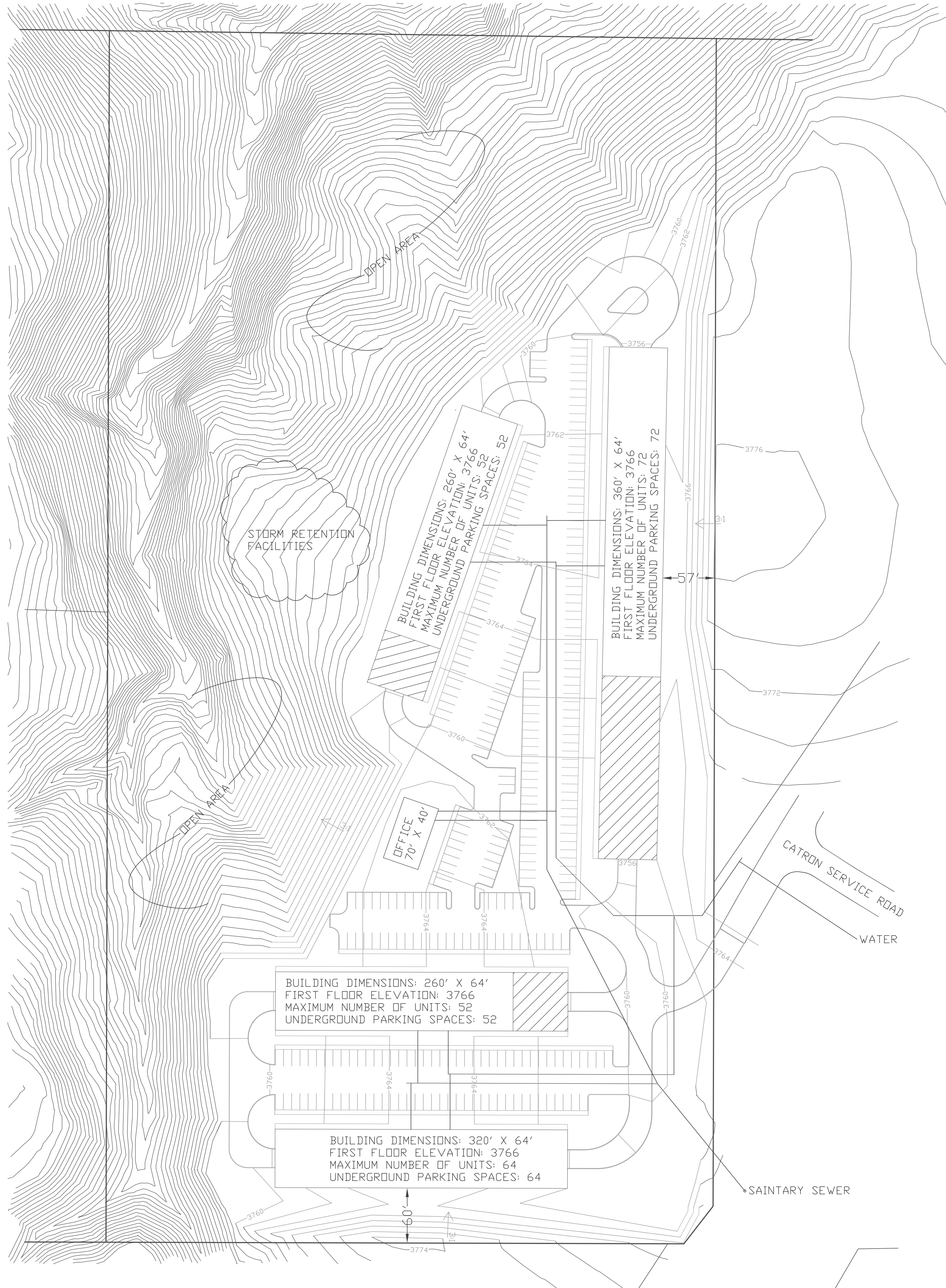

THE E1/2 OF W1/2 OF NE1/4 OF NW1/4; THE W/12 OF E1/2 OF NE1/4 OF NW1/4; EXCEPTING A PORTION OF LOT H1, HIGHWAY PLAT BOOK 6, PAGE 9 SECTION 26, T1N, R7E, B1M RAPID CITY, PENNINGTON COUNTY, SOUTH DAKOTA		SA Group Properties, Inc. 28 W. Madison Street Oak Park, IL 60302 Attn: Zenaida Maniates zenaida.maniates@usbank.com	Jim Letner jimletner@hotmail.com (605) 390-4805
DATE 10/26/2012	DESIGNED BY: TWL	DRAWN BY: JTL	OWNER DEVELOPER
SHEET: 1/1			