

MISCELLANEOUS ELECTRICAL NOTES:
 A. SPECIFIC ELECTRICAL NOTES: ①

ELECTRICAL SITE PLAN
 SCALE: 1" = 20'-0"



Wyss Associates, Inc.
 Landscape Architecture
 Parks & Recreation Design
 Civil/Coastal Architecture
 726 West Superior St., Ste. 1700
 Ft. Collins, CO 80521
 Phone: 970.226.2200 Fax: 970.226.2201
 www.wyssassociates.com

FMG, Inc.
 Structural Engineering
 1000 13th St., Suite 100
 Ft. Collins, CO 80521
 Phone: 970.226.2200 Fax: 970.226.2201
 www.fmginc.com

Albertson Engineering, Inc.
 Electrical & Mechanical Engineering
 1000 13th St., Suite 100
 Ft. Collins, CO 80521
 Phone: 970.226.2200 Fax: 970.226.2201
 www.albertsoneng.com

WPE CONSULTING ENGINEERS
 726 West Superior St., Ste. 1700
 Ft. Collins, CO 80521
 Phone: 970.226.2200 Fax: 970.226.2201
 www.wpe-engineers.com

**65% PRELIMINARY
 NOT FOR CONSTRUCTION**

Memorial Park Promenade
 Rapid City, South Dakota

ELECTRICAL SITE PLAN

DESIGNED BY: MKV
 DRAWN BY: VLS
 APPROVED BY: DWB
 PROJECT NO.: WPE48812021
 DATE: 07/13/22

| NO. | REVISION | DATE |
|-----|----------|------|
| | | |
| | | |
| | | |

Sub Sheet
E1
 Sheet X OF X

University of Minnesota. All reports, plans, specifications, computer files, field data, notes and instruments prepared by the design professional as instruments of service shall remain the property of the design professional. All contents here, tabularity and other reserved rights including the copyright therein.

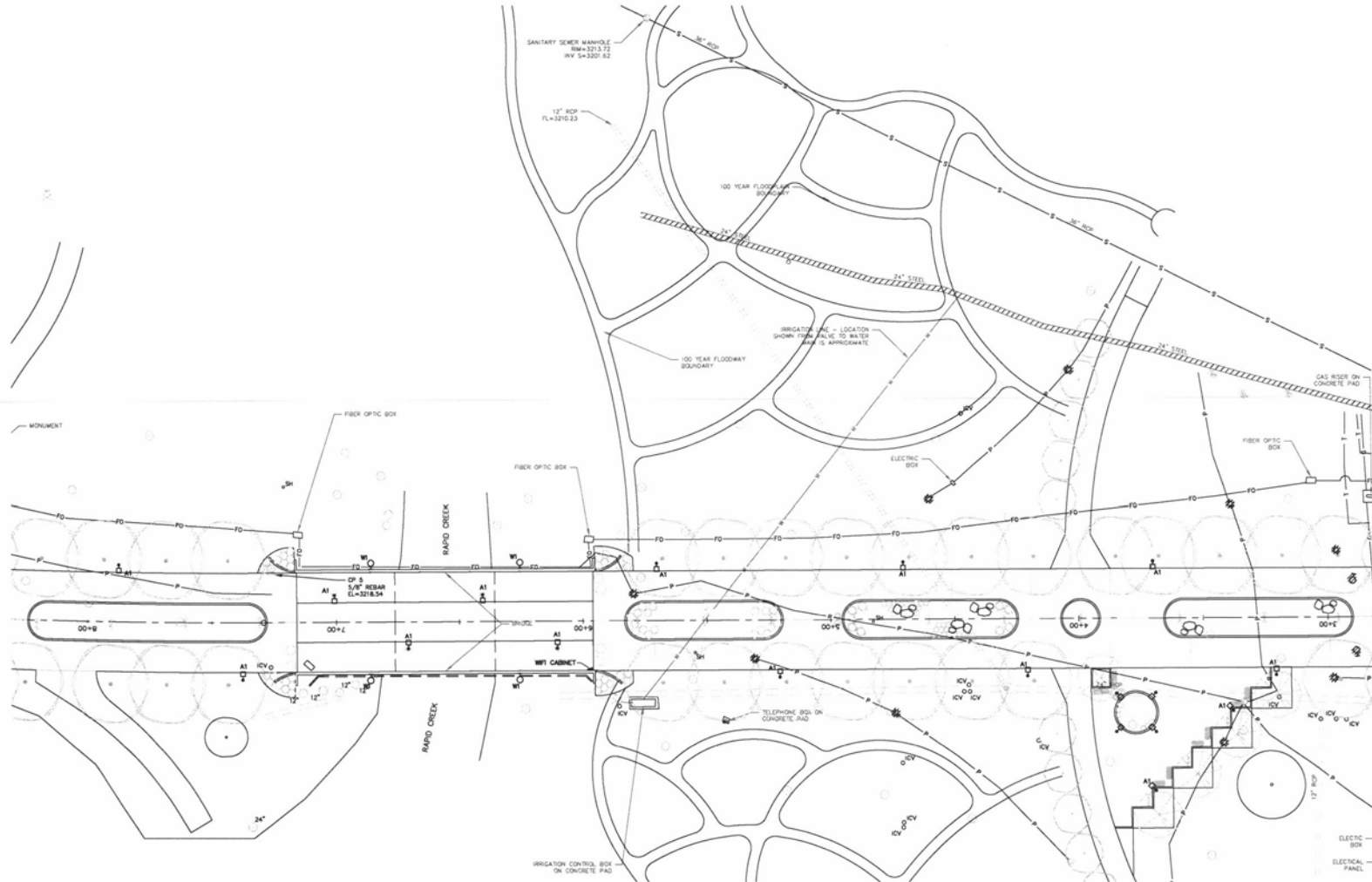

ELECTRICAL SITE PLAN
SCALE 1" = 20'-0"

MISCELLANEOUS ELECTRICAL NOTES:
A. HATCHING INDICATES DEMOLITION.
SPECIFIC ELECTRICAL NOTES: ①

Landscape Architectural Consultant:
Wyss Associates, Inc.
Landscape Architecture
Public & Recreational Design
Civil Course Architecture
756 West 25th Street, Suite 202, Rapid City, SD 57701-3021
PH: 605.342.2288 FAX: 605.342.6500
www.wyssassociates.com

Civil Engineering & Surveying:
FMG, Inc.
1000 West 10th Street, Suite 100, Rapid City, SD 57701-3021
PH: 605.342.2288 FAX: 605.342.6500
www.fmginc.com

Structural Engineer:
Albertson Engineering, Inc.
1000 West 10th Street, Suite 100, Rapid City, SD 57701-3021
PH: 605.342.2288 FAX: 605.342.6500
www.albertsoneng.com

Electrical & Mechanical Engineering:
WPE CONSULTING ENGINEERS
756 West 25th Street, Suite 202, Rapid City, SD 57701-3021
PH: 605.342.2288 FAX: 605.342.6500
www.wpe-engineers.com

65% PRELIMINARY NOT FOR CONSTRUCTION

Memorial Park Promenade
Rapid City, South Dakota

ELECTRICAL SITE PLAN

DESIGNED BY: MKV
DRAWN BY: VLS
APPROVED BY: DMH
PROJECT NO: WPE488.0001
DATE: 07/13/12

| NO. | REVISION | DATE |
|-----|----------|------|
| | | |
| | | |
| | | |



Sub Sheet
E2
Sheet X OF X

University of South Dakota, All reports, plans, specifications, computer files, field data, notes and instruments prepared by the design professional are instruments of service and remain the property of the design professional. All common law, state and other reserved rights including the copyright therein.