



Conditional Use Permit Submittal

LEGEND

- * SPRINKLER HEAD
- ELECTRIC BOX
- POST
- SANITARY SEWER MANHOLE
- STORM SEWER MANHOLE
- LIGHT POLE
- TELEPHONE BOX
- CONIFEROUS TREE
- DECIDUOUS TREE
- BUSH
- CONTROL POINT
- FIRE HYDRANT
- WATER VALVE
- STORM INLET
- SANITARY SEWER LINE
- STORM SEWER LINE
- FIBER OPTIC LINE
- IRRIGATION LINE
- POWER LINE
- PROPERTY LINE

NOTES

- THIS SURVEY IS NOT A BOUNDARY SURVEY.
- RIGHT-OF-WAY GRANTED TO BLACK HILLS FIBERCOM, L.L.C. AS SET FORTH IN INSTRUMENT RECORDED NOVEMBER 5, 1999, IN BOOK 81, PAGE 5398.
- RIGHT-OF-WAY PERMIT GRANTED TO BLACK HILLS POWER AND LIGHT COMPANY TO CONSTRUCT, OPERATE AND MAINTAIN AN ELECTRIC POWER LINE IN BLOCK 244 AS SET FORTH IN INSTRUMENT RECORDED DECEMBER 9, 1983, IN BOOK 21, PAGE 4569. THE ROUTE IS NOT SET FORTH.
- THE COORDINATE SYSTEM USED FOR THIS SURVEY IS SOUTH DAKOTA STATE PLANE COORDINATES, SOUTH ZONE AND 83/98. ELEVATIONS ARE BASED ON NGVD 29. THE AVERAGE COMBINED SCALE FACTOR FOR THIS SURVEY IS 0.999916058.
- THE UTILITY LOCATIONS SHOWN WERE BASED ON FIELD LOCATES PROVIDED BY THE UTILITY COMPANIES (THROUGH ONE-CALL) AND THE OWNER. THE WATER MAIN WAS NOT FIELD LOCATED AND WAS BASED UPON CITY RECORDS AND THE WATER GATE VALVES THAT WERE LOCATED. THE SIZE AND LOCATION OF UNDERGROUND UTILITIES WAS NOT VERIFIED BY EXCAVATION. THE CONTRACTOR IS RESPONSIBLE FOR LOCATING, PROTECTING AND VERIFYING ALL UTILITIES DURING CONSTRUCTION AND PRIOR TO ORDERING MATERIALS.
- THE TOPOGRAPHIC SURVEY SHOWN HEREON WAS COMPLETED JUNE 2011. CHANGES IN UTILITIES AND OTHER SITE FEATURES SINCE THE SURVEY MAY HAVE OCCURRED AND WOULD NOT BE SHOWN ON THIS SITE SURVEY.
- ONLY IRRIGATION/SPRINKLER HEADS THAT WERE VISIBLE DURING THE TOPOGRAPHIC SURVEY ARE SHOWN.

Point Table				
Point #	North	East	Elevation	DESCRIPTION
15	438272.58	1209801.64	3334.28	3/8" REBAR W/CAP
16	438200.79	1208814.88	3331.31	3/8" REBAR W/CAP
17	438302.88	1209859.02	3343.36	3/8" REBAR W/CAP
18	438313.33	1209801.58	3337.27	3/8" REBAR W/CAP
19	438158.22	1209740.33	3331.10	3/8" REBAR W/CAP
20	438320.81	1209876.04	3332.04	3/8" REBAR W/CAP

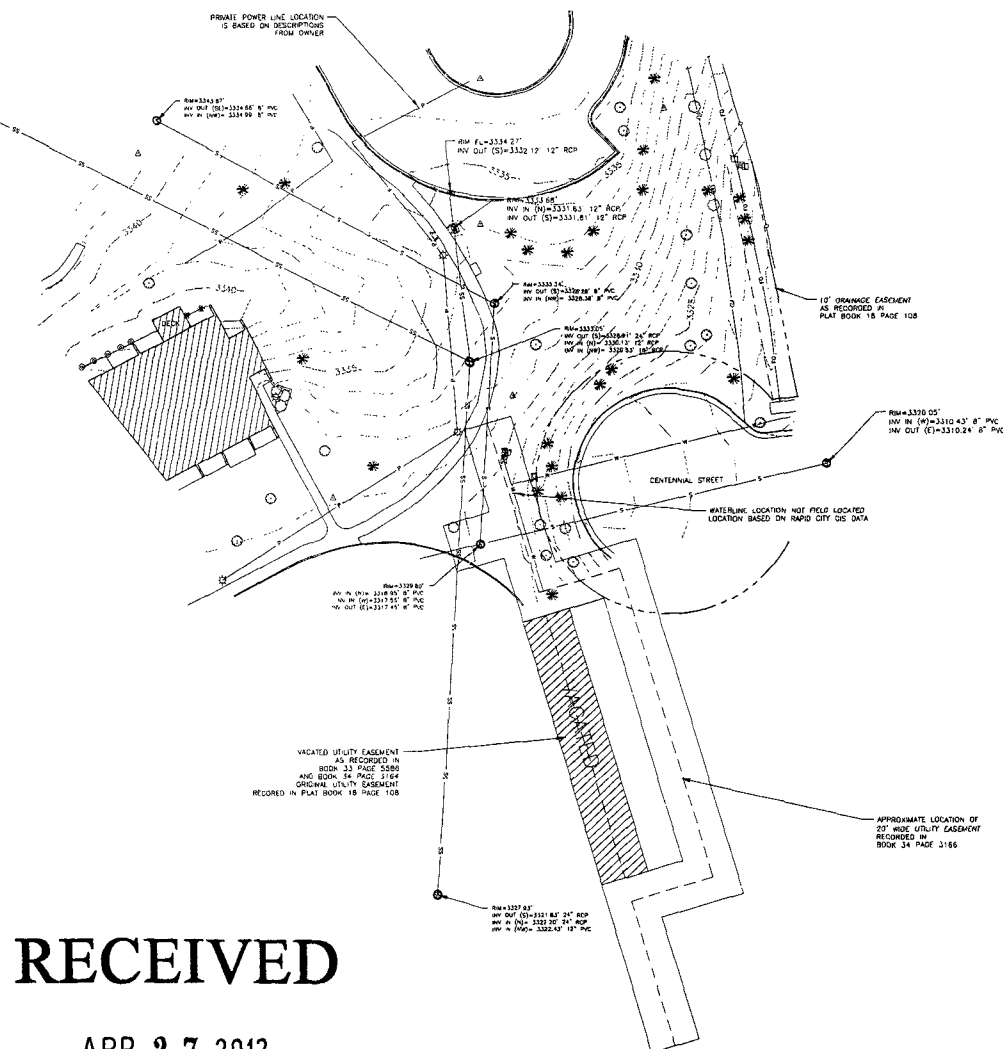

RECEIVED

APR 27 2012

RAPID CITY COMMUNITY PLANNING
& DEVELOPMENT SERVICES

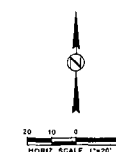

West Hills Village
Apartments Addition

Rapid City, South Dakota

Project Number: 11.1737.002

Date: April 27, 2012

Topographic Survey

V1.01

© 2012 FourFront Design, Inc.