

**SITE DATA**  
 SITE AREA 10 ACRES (435,600 S.F.)  
 BUILDING AREA 98,100 S.F. (22.5%)  
 HARDSCAPE (ASPHALT) AREA 139,200 S.F. (32.0%)  
 LANDSCAPE, WALKS & AMENITIES AREA 198,300 S.F. (45.5%)  
 UNIT COUNT (216)  
 DENSITY (21.6 UNITS PER ACRE)

**AMENITIES**  
 COMMUNITY CENTER - BUILDING TYPE A  
 GATHERING AREA  
 EXERCISE AREA  
 BUSINESS CENTER  
 INDOOR HOT TUB SPA  
 SWIMMING POOL  
 POOL DECK FOUNTAIN/SPLASH  
 BASKETBALL COURT  
 TWO PICNIC/BBQ AREAS  
 LARGE OPEN PLAY AREA  
 JOGGING PATH  
 PLAY AREA

**AMENITIES**  
 APARTMENT BUILDINGS (THREE STORIES) 10  
 BUILDING TYPE B (4) (12-2BR & 12-1BR)  
 BUILDING TYPE C (3) (24-2BR)  
 BUILDING TYPE D (1) (12-3BR)  
 BUILDING TYPE E (1) (12-3BR & 12-1BR)  
 APARTMENT UNITS (216)  
 ONE BEDROOM/ONE BATH (60)  
 TWO BEDROOM/TWO BATH (120)  
 THREE BEDROOM/TWO BATH (36)

**PARKING DATA**  
 PARKING HC 24  
 PARKING REGULAR 367  
 TOTAL OUTSIDE PARKING 411  
 GARAGE PARKING 85  
 TOTAL PARKING PROVIDED 496  
 RAPID CITY REQUIRED PARKING AT  
 1.5 PER DWELLING UNITS = 324

CITY OF RAPID CITY  
 DEVELOPMENT SERVICES

Submitter:  
 9.30.11-PRELIMINARY PLAT SUBMITTAL  
 Engineering Reviewer: \_\_\_\_\_ Date: \_\_\_\_\_  
 COMMENTS: \_\_\_\_\_  
 Revisions: \_\_\_\_\_

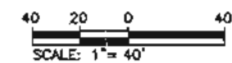

NOTE: ALL IMPROVEMENTS INSIDE OF THE EAST MINNESOTA STREET ROW FROM STA 7+20 THRU 16+65 SHALL BE CONSTRUCTED AS PART OF THIS PROJECT. THESE IMPROVEMENTS SHALL BE DONE IN ACCORDANCE WITH THE EAST MINNESOTA STREET SECTIONS 16 AND 21 ELK VALE ROAD EAST TO SECTION LINE (7-22-11) PLANS UNLESS OTHERWISE NOTED IN THESE PLANS.

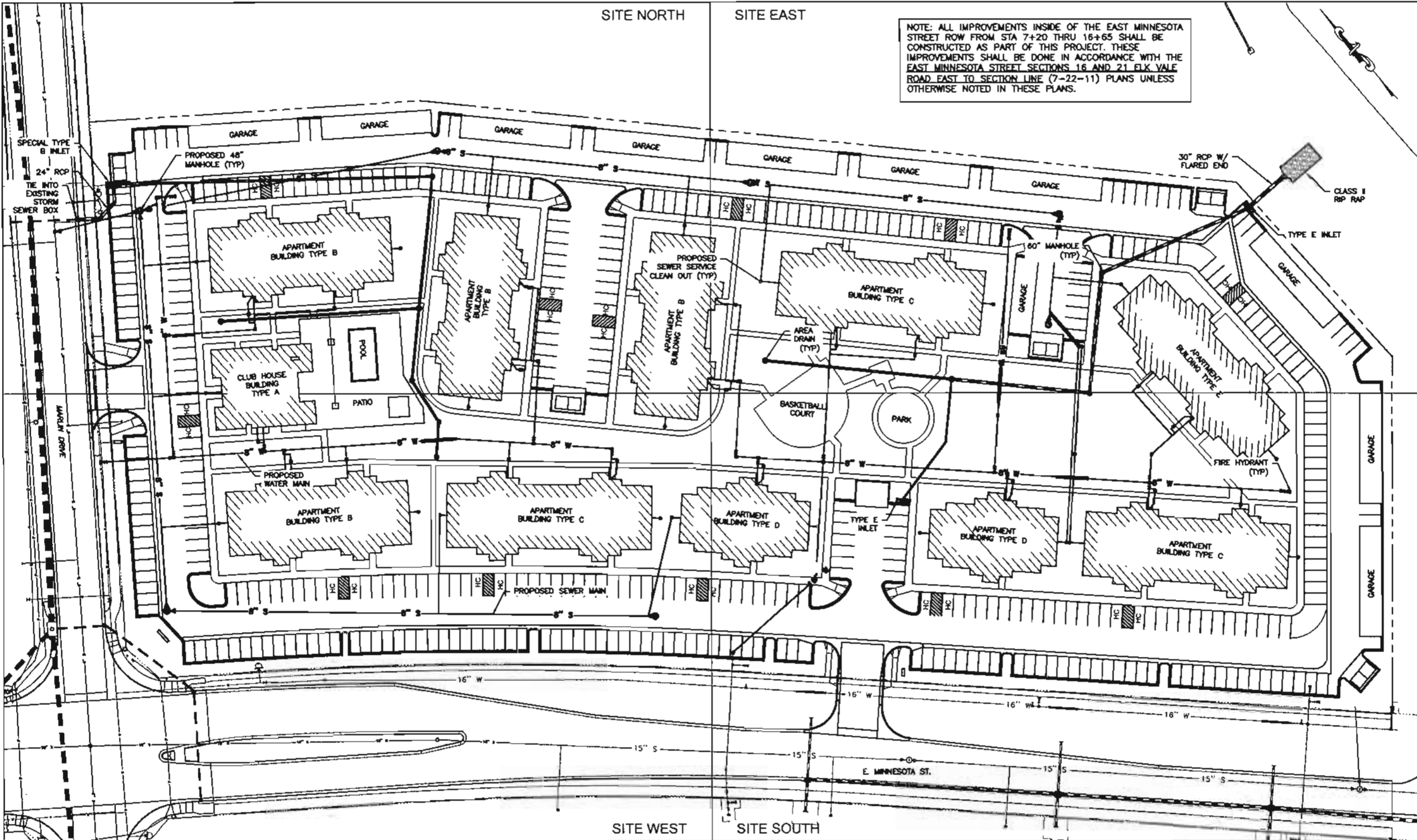

**FOR REVIEW ONLY**

Internal Job No: 11-0592  
 Designed By: TC  
 Drawn By: PMW  
 Surveyed By: RENNER & ASSOC.  
 Survey Date: 09/2011

**DREAM DESIGN**  
 INTERNATIONAL, INC.

ENGINEERING, LANDSCAPE ARCHITECTURE,  
 LAND PLANNING, CONSTRUCTION ADMINISTRATION  
 528 KANSAS CITY STREET, SUITE 4, RAPID CITY, SD 57701  
 PHONE: (605) 348-0538 FAX: (605) 348-0545 WWW.DREAMDESIGNING.COM

GATEWAY APARTMENTS  
 RAPID CITY, SOUTH DAKOTA



SEP 10 2011  
 PROJECT OVERVIEW  
 Rapid City Growth  
 Management Department