



# Site Plan



FOR CUP SUBMITTAL ONLY.  
NOT FOR CONSTRUCTION  
State Registration #6048  
Date 09/09/2011

SP1

\* COPYRIGHT © 2011 ©  
This plan is copyrighted and shall be used  
only for the building shown and  
it may not be copied or reproduced without written  
permission from Inside Outside Architecture, Inc.

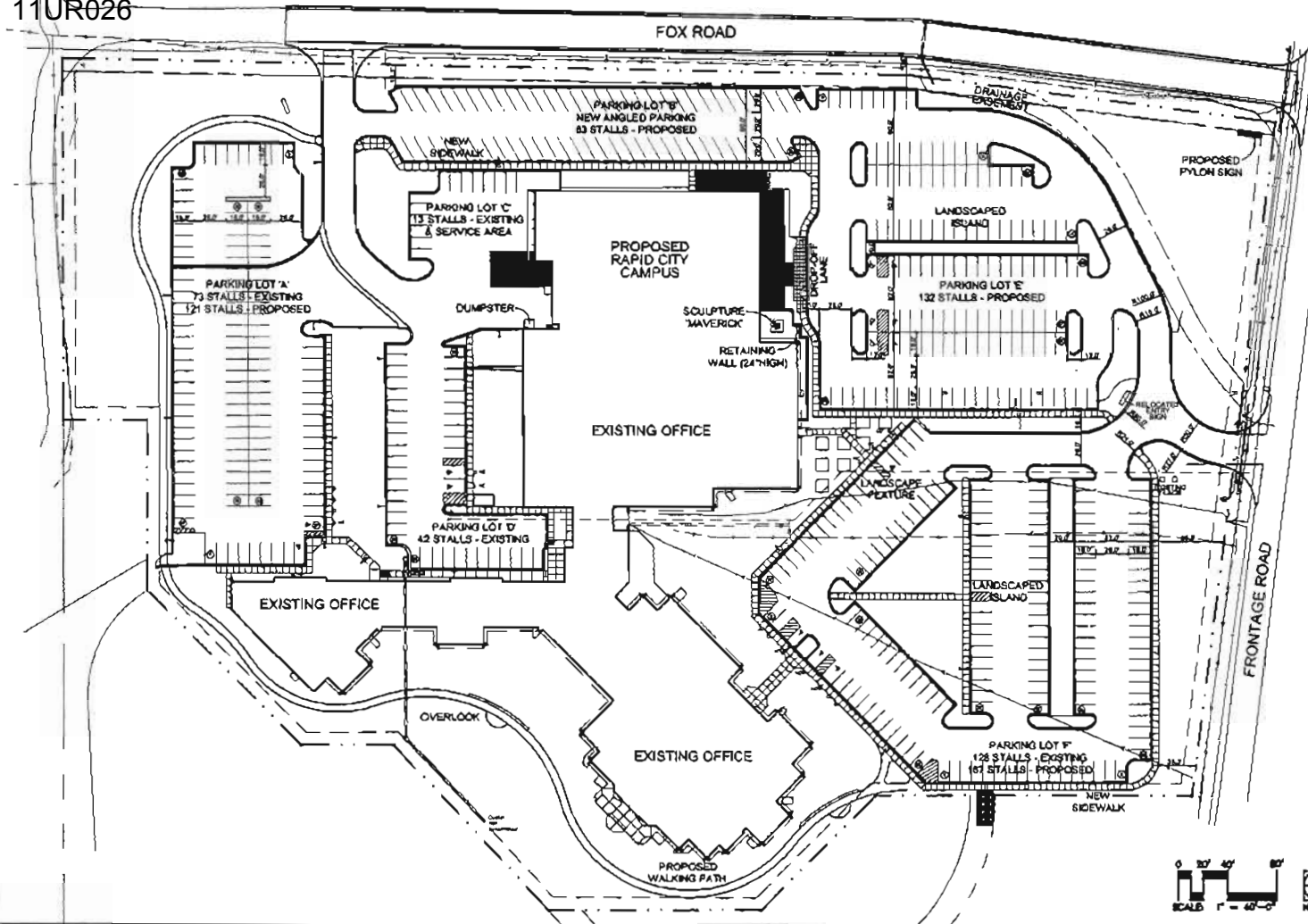

Rapid City Growth  
Management Department  
SEP 09 2011

THE MAJOR IMPROVEMENT TO THIS SITE IS THE ADDITION OF PARKING NECESSARY TO MEET THE NEEDS OF THE DISTANCE LEARNING ELEMENT OF THE CAMPUS.

MAJOR BUILDING ADDITIONS ARE INCLUDED IN THE PROPOSED SITE PLAN. THE FIRST ADDED TO THE NORTHEAST CORNER OF THE BUILDING WILL PROVIDE A SEPARATE ENTRY TO THE UNDOGGED INTERIOR. THE WIDELY ACCESSIBLE HALL PROVIDES INTERIOR STORAGE OF THE MOBILE LEARNING UNIT IN A SECURE ENVIRONMENT.

THE PARKING AND CIRCULATION IMPROVEMENTS INCLUDE A HOODED ENTRANCE FROM THE EAST FRONTAGE ROAD. ADDITIONAL PARKING ON THREE SIDES OF THE SITE, AND PEDESTRIAN IMPROVEMENTS INCLUDING BIODIVERSITY AND A COOL DRAIN SYSTEM.

THE PROPOSED SITE PLAN IS ILLUSTRATED AND QUANTIFIED ON THE LANDSCAPE PLAN.

GENERAL NOTES:

Parking Summary	EXIST.	NEW	TOTAL	HC	NOTES
PARKING AREA B	0	83	83	2	STAFF
PARKING AREA C	13	0	13	0	UNDERGROUND
PARKING AREA D	42	0	42	0	STAFF
PARKING AREA E	0	132	132	0	STUDENT
PARKING AREA F	138	67	205	0	ADMINISTRATION
TOTAL	193	282	475	2	

PARKING SUMMARY:

RECEIVED