



Lea E. Kangas  
18601 152nd AVE N  
DAYTON, MN 55327  
763-428-5870

CONSULTANTS

PROJECT

NAU  
Proposed  
Rapid City Campus  
CUP submittal

Rapid City, SD

CONTENTS

LANDSCAPE  
PLAN

CERTIFICATION

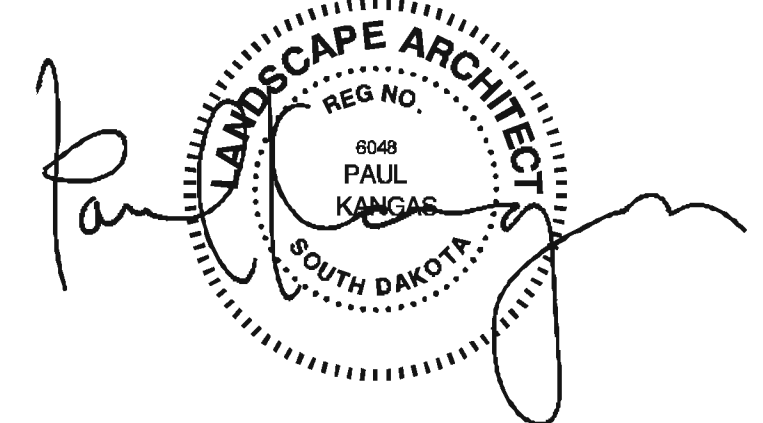

FOR CUP SUBMITTAL ONLY.  
NOT FOR CONSTRUCTION  
State Registration #6048

Date 09/29/2011

L1

\* COPYRIGHT 2011 ©\*  
This plan is copyrighted and shall be used  
only for the building shown and  
is not to be copied or reproduced without written  
permission from Inside Outside Architecture, Inc.

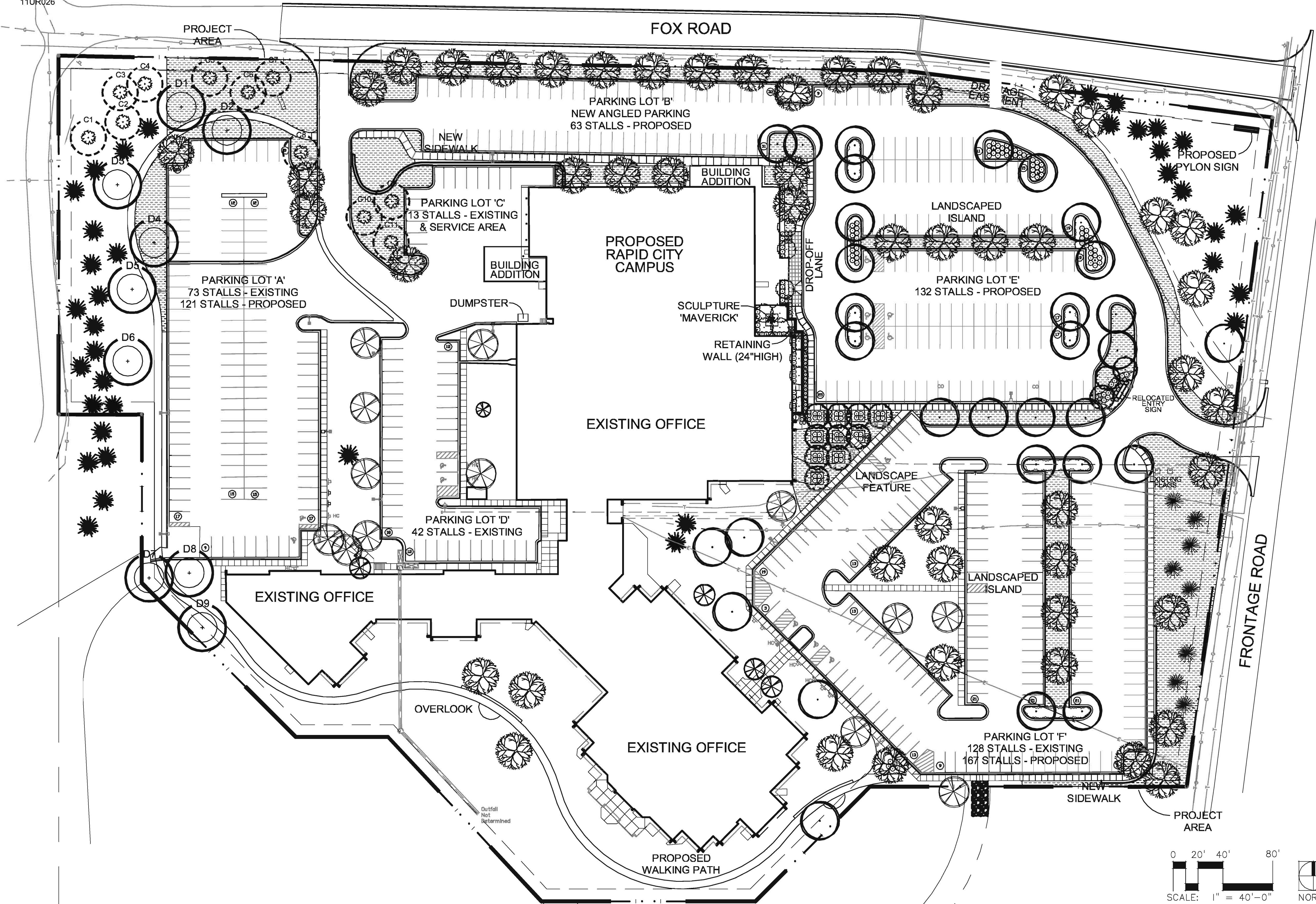

SYMBOL	PLANT TYPE / POTENTIAL SPECIES LIST	SYMBOL	PLANT TYPE / POTENTIAL SPECIES LIST	SYMBOL	PLANT TYPE / POTENTIAL SPECIES LIST
(Symbol)	DECIDUOUS SHADE TREES - 2" CAL. NORTHWOOD RED MAPLE Acer rubrum 'Northwood' LITTLELEAF LINDEN Tilia cordata RED OAK Quercus rubra IMPERIAL HONEYLOCUST Gleditsia triacanthos var. inermis 'Skyline'	(Symbol)	CONIFEROUS TREES - 5/8 HT. SCOTCH PINE Pinus sylvestris COLORADO GREEN SPRUCE Picea pungens BLACK HILLS SPRUCE Picea canadensis ARBORVITAE spp. Thuja spp.	(Symbol)	DECIDUOUS SHRUBS - #2 POT DWARF WINGED EUONYMUS Euonymus alatus 'Compactus' RED TWIGGED DOGWOOD Cornus sericea 'Bailey' ANNABELLE HYDRANGEA Hydrangea arborescens 'Annabelle' SPIREA Spiraea spp. SHRUB ROSES Rugosa rose spp.
(Symbol)	ORNAMENTAL TREES - 1.5" CAL. SERVICEBERRY Amelanchier canadensis FLOWERING CRABAPPLE Malus spp. JAPANESE TREE LILAC Syringa reticulata MERRILL MAGNOLIA Magnolia x 'soulangeana'	(Symbol)	PERENNIALS - #1 POT BLACK EYED SUSAN Rudbeckia hirta 'Goldstrum' AUTUMN JOY SEDUM Sedum x 'Autumn Joy' DAYLILY Hemerocallis sp. HOSTA Hosta x 'Mixed Cultivars'	(Symbol)	CONIFEROUS SHRUBS - #2 POT SEA GREEN JUNIPER Juniperus chinensis 'Sea Green' SAVIN JUNIPER Juniperus sabina TAUNTON SPREADING YEW Taxus x media 'Taunton'

PROJECT SITE AREA = 530,132 SF  
POINTS REQUIRED = 530,132  
POINTS PROVIDED = 681,800

THE ABOVE POINT CALCULATION IS BASED ON THE ENTIRE CAMPUS SITE AREA. THE CALCULATIONS ARE BASED ON FIELD DATA VERIFYING EXISTING LANDSCAPING QUANTITIES ON SEPTEMBER 28, 2011. WHILE THE EXACT QUANTITIES OF EXISTING LANDSCAPING IS DIFFICULT TO DETERMINE WITH 100% CERTAINTY, THE POINT TOTALS ARE IN EXCESS OF THE REQUIRED TOTALS FOR THIS PROJECT.

PROPOSED LANDSCAPING:	VALUE	QTY.	TOTALS
LARGE TREES	2,000	90	180,000
MEDIUM TREES	1,000	13	13,000
SMALL TREES	500	11	5,500
SHRUBS	250	247	61,750
GROUND COVER	100	500	50,000
TURF OR GRASS	10	5,935	59,350
TOTALS			369,600

EXISTING LANDSCAPING:	VALUE	QTY.	TOTALS
LARGE TREES RETAINED	2,000	49	98,000
MEDIUM TREES RETAINED	1,000	0	0
SMALL TREES RETAINED	500	5	2,500
SHRUBS RETAINED	250	99	24,750
GROUND COVER RETAINED	100	40	4,000
TURF OR GRASS RETAINED	10	14,295	142,950
LARGE TREES TRANSPLANTED	2,000	20	40,000
TOTALS			312,200

NATIONAL AMERICAN UNIVERSITY TAKES GREAT PRIDE IN MAINTAINING A STRONG CORPORATE IMAGE AND IS COMMITTED TO ENHANCING THIS SITE THROUGH GOOD SITE DESIGN AND LANDSCAPE IMPROVEMENTS. IN ADDITION TO THE SIGNIFICANT PLANTINGS, THE SITE WILL BENEFIT FROM NEW SIGNAGE, SPECIAL SITE ELEMENTS SUCH AS A WALKING PATH, AND AN EXTERIOR SCULPTURAL ELEMENT.

THE PROPOSED PLANT PALETTE ARE LIKELY PLANT SPECIES TO BE USED ON THIS CAMPUS. SINCE THE PROJECT IS IN THE PRELIMINARY DESIGN STAGE, DETAILED PLANT SELECTIONS HAVE NOT BEEN MADE AT THIS TIME.

ALL LANDSCAPED AREAS TO HAVE UNDERGROUND, AUTOMATED IRRIGATION SYSTEM WITH RAIN SENSOR.

ALL PLANTING BEDS TO BE MULCHED WITH SHREDDED HARDWOOD MULCH AND EDGED WITH BLACK PAINTED STEEL EDGING.

POTENTIAL PLANT PALETTE:

LANDSCAPE POINT CALCULATION:

GENERAL NOTES: