

MINIMUM REQUIREMENTS:

EROSION BMPs SHOWN ARE TO BE TAKEN AS THE MINIMUM REQUIREMENT. STABILIZED CONSTRUCTION ENTRANCE LOCATIONS SHALL BE SELECTED BASED ON THE PHASE OF WORK AND ACTUAL ACCESS LOCATION BEING USED FOR CONSTRUCTION.

ADDITIONAL EROSION/SEDIMENT CONTROL METHODS SHALL BE EMPLOYED BY THE CONTRACTOR AS NECESSARY TO INSURE THAT SEDIMENT/POLLUTANTS DO NOT LEAVE THE SITE. CONTRACTOR SHALL ADJUST HIS/HER EROSION AND SEDIMENT CONTROL MEASURES AS APPROPRIATE DURING THE COURSE OF THE WORK.

DETAILS:

REFER TO THE NEXT SHEET FOR EROSION CONTROL DETAILS.

STORM SEWER INLET PROTECTION:

DURING THE COURSE OF DEMOLITION AND CONSTRUCTION, EXISTING AND PROPOSED STORM INLETS SHALL BE COVERED/ PROTECTED/ FILTERED/ SEALED AS APPROPRIATE TO PREVENT SILT & POLLUTANTS FROM ENTERING RAPID CREEK VIA THE EXISTING AND PROPOSED STORM SEWER COLLECTION AND DISCHARGE PIPING.

PHASED CONSTRUCTION:

APPROPRIATE EROSION CONTROL AND SILT COLLECTION METHODS SHALL BE EMPLOYED AT THE DOWN GRADIENT TERMINUS OF EACH PHASE OF CONSTRUCTION, AS THE WORK PROGRESSES.

FINAL SURFACE STABILIZATION:

TOPSOIL SHALL NOT BE PLACED UNTIL AFTER ALL UTILITY, IRRIGATION, AND LIGHTING HAS BEEN INSTALLED. TOPSOIL SHALL NOT BE PLACED UNTIL SEEDING IS IN PLACE.

- (VTC) STABILIZED CONSTRUCTION ENTRANCE
- (IP) INLET PROTECTION
- (OP) OUTLET PROTECTION
- (W) COMPOST MATTE, 12" DIA
- (WA) CONCRETE WASH-OUT AREA TO BE DETERMINED DURING CONSTRUCTION

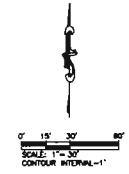

STORMWATER TREATMENT/ATTENUATION POND SHALL BE CONSTRUCTED AT THE BEGINNING OF THE PROJECT AND SHALL BE USED AS A SILT COLLECTION FACILITY THROUGH THE COURSE OF CONSTRUCTION. INSTALL MATTELS AS SHOWN BEFORE BEGINNING EXCAVATION OF POND. POND SHALL BE RESTORED TO PLAN GRADES AND SEEDED AFTER SITE SURFACES ARE STABILIZED. PROTECT THE NEW INLET RISER BY PLUGGING THE LOWEST METERING HOLE AT THE BOTTOM OF THE RISER.

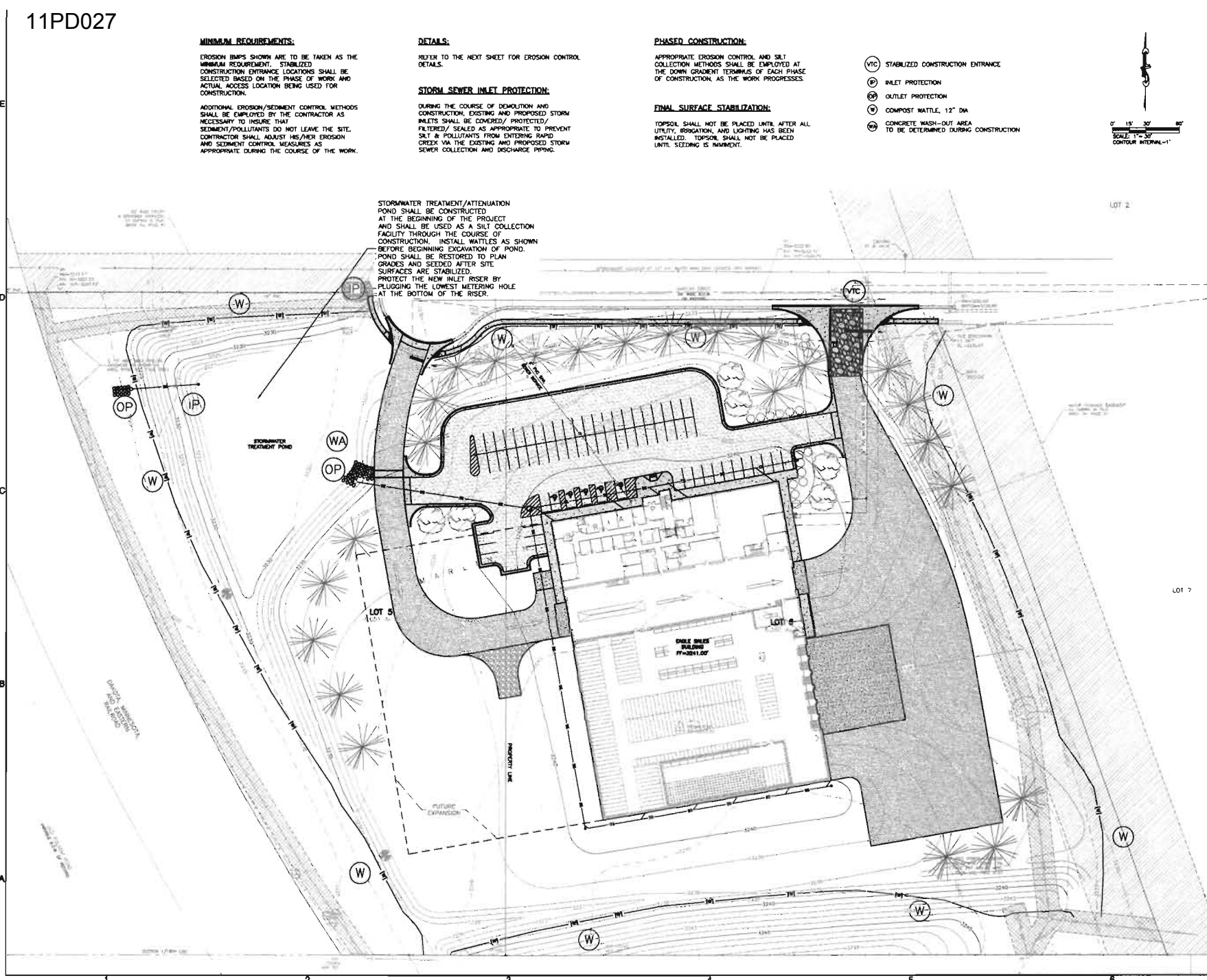

UPPER DECK ARCHITECTS, INC.
 1201 W. DIAMOND BLVD., SUITE 215
 RENO, NV 89502
 PHONE: 775-784-5232
 FAX: 775-784-5240

NO.	DATE	DESCRIPTION
1	08/11/2011	FOR PERMITS
2	08/11/2011	FOR PERMITS
3	08/11/2011	FOR PERMITS

CONTRACTOR:
 EAGLE SALES
 1100 S. 2ND ST.
 RENO, NV 89502
 PHONE: 775-777-1111
 FAX: 775-777-1112

NOTES:
 1. ALL CONSTRUCTION SHALL BE IN ACCORDANCE WITH THE CITY OF RENO, NV PERMITS AND ORDINANCES.
 2. THE CONTRACTOR SHALL BE RESPONSIBLE FOR OBTAINING ALL NECESSARY PERMITS.
 3. THE CONTRACTOR SHALL MAINTAIN ACCESS TO ALL ADJACENT PROPERTIES AT ALL TIMES.
 4. THE CONTRACTOR SHALL MAINTAIN ALL EXISTING UTILITIES AND STRUCTURES.
 5. THE CONTRACTOR SHALL MAINTAIN ALL EXISTING EROSION CONTROL MEASURES.
 6. THE CONTRACTOR SHALL MAINTAIN ALL EXISTING LANDSCAPE FEATURES.
 7. THE CONTRACTOR SHALL MAINTAIN ALL EXISTING SURFACES.
 8. THE CONTRACTOR SHALL MAINTAIN ALL EXISTING UTILITIES AND STRUCTURES.
 9. THE CONTRACTOR SHALL MAINTAIN ALL EXISTING EROSION CONTROL MEASURES.
 10. THE CONTRACTOR SHALL MAINTAIN ALL EXISTING LANDSCAPE FEATURES.

EAGLE SALES
of the Black Hills, Inc.
 Rapid City, South Dakota

PROJECT NUMBER: 11100
 DRAWN BY: [Signature]
 CHECK BY: [Signature]
 SHEET TITLE: EROSION & SEDIMENT CONTROL PLAN
C-105

PRELIMINARY - NOT FOR CONSTRUCTION