

478  
2,893

RECEIVED

APR 29 2011

Rapid City Growth Management Department

TENANT: DIAMOND DAVE'S TACO CO.		
SPACE: 478	AREA: 2,893	SQ. FT.
DATE: 5-15-96	SCALE: NONE	

EXHIBIT A PAGE 2

RUSHMORE MALL  
RAPID CITY, SOUTH DAKOTA

GENERAL GROWTH MANAGEMENT, INC.  
400 S. HWY. 169, SUITE 800  
MINNEAPOLIS, MN 55426  
AGENT FOR THE OWNER

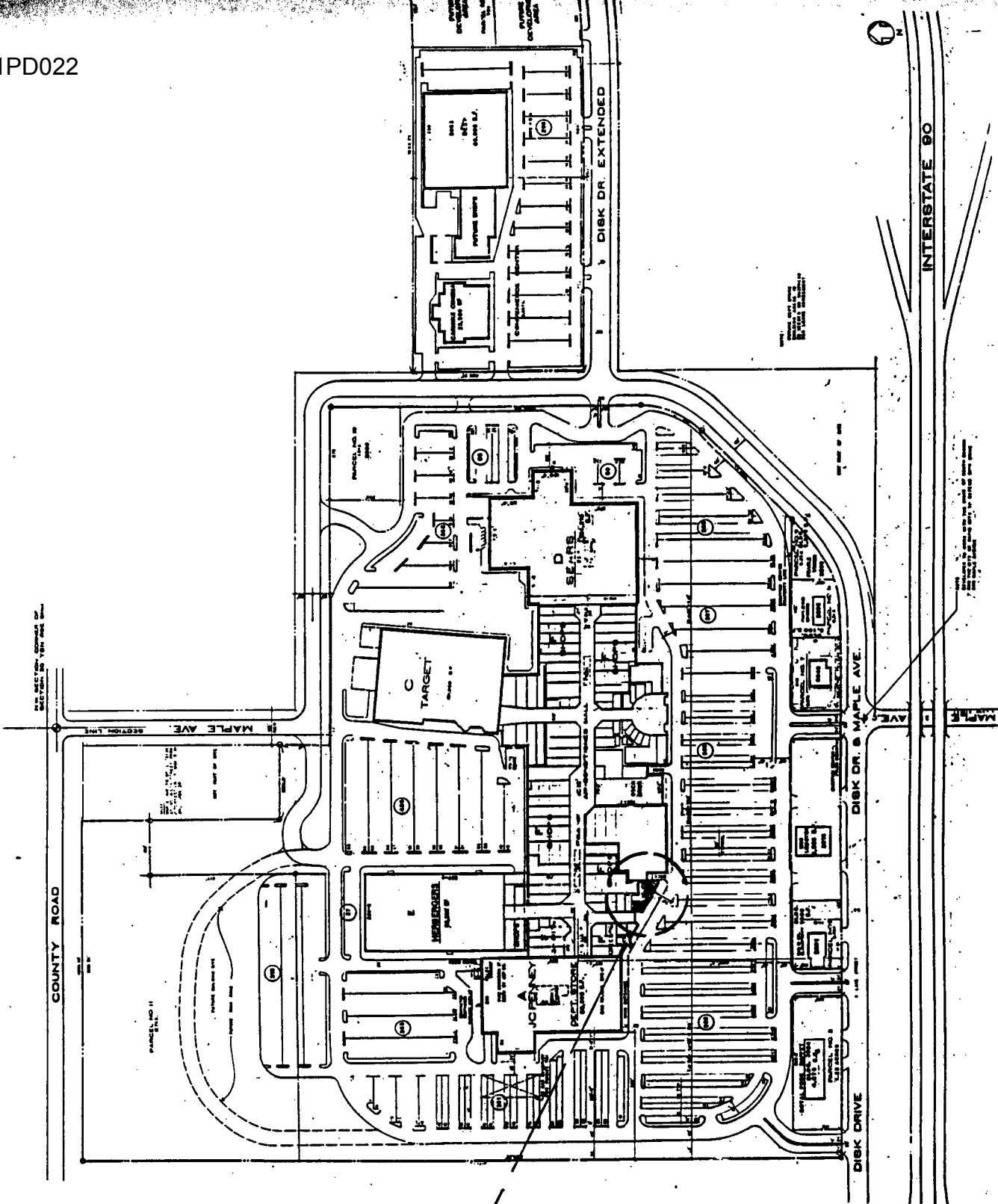

SPACE # 478

NOTE

1. THIS EXHIBIT A-1 IS DIAGRAMATIC AND IS INTENDED ONLY FOR THE PURPOSE OF INDICATING THE LOCATION OF THE DENISED PREMISES, THE BUILDINGS AND PARKING AREAS. IT DOES NOT PURPORT TO SHOW THE EXACT OR FINAL LOCATION OF COLUMNS, DIVISION WALLS OR OTHER REQUIRED ARCHITECTURAL, STRUCTURAL, MECHANICAL OR ELECTRICAL ELEMENTS. SIZES AND DIMENSIONS SHOWN ARE APPROXIMATE. LANDLORD RESERVES THE RIGHT TO ELIMINATE OR ADD AND TO MAKE CHANGES IN THE SIZE OR LOCATION OF SUCH ELEMENTS AND OF THE BUILDINGS AND PARKING AREAS AND AS MAY BE REQUIRED TO CONFORM TO BUILDING CODE, EXIT REQUIREMENTS, FIRE WALLS AND MECHANICAL EQUIPMENT SPACE.
2. ENTRANCE AND EXIT LOCATIONS FROM SURROUNDING ROADS ARE DIAGRAMATIC AND SUBJECT TO APPROVAL OF GOVERNING AUTHORITIES.
3. DIMENSIONS INDICATED FOR THE DENISED PREMISES ARE MEASURED TO THE CENTER LINE OF INTERIOR AND PARTY WALLS AND TO THE EXTERIOR FACE OF EXTERIOR WALLS OR MALL LEASE LINES.
4. MALL KIOSKS, FREE STANDING BUILDING AND FUTURE BUILDING AREAS ARE INDICATED FOR GENERAL PURPOSES AND LOCATION. LANDLORD RESERVES THE RIGHT TO ADD, DELETE, RELOCATE AND CHANGE ANY OR ALL OF THE SAME.
5. NOTHING CONTAINED ON THIS EXHIBIT A-1 SHALL BE CONSTRUED, DEEMED OR INTERPRETED TO BE A WARRANTY, REPRESENTATION OR AGREEMENT ON THE PART OF LANDLORD THAT ANY DEPARTMENT STORE OR REGIONAL OR NATIONAL CHAINSTORE OR OTHER MERCHANT INDICATED ON THIS EXHIBIT BY NAME SHALL INITIALLY OPEN OR REMAIN OPEN FOR BUSINESS OR OCCUPY OR CONTINUE TO OCCUPY ANY PREMISES OR SPACE IN OR ADJOINING THE SHOPPING CENTER.

**RUSHMORE MALL**  
**RAPID CITY, SOUTH DAKOTA**

RECEIVED

APR 29 2011

TENANT DIAMOND DAVE'S TACO CO.

Rapid City Growth Management Department

SPACE 478 SQ.FT. 2,893

DATE 5-15-96

EXHIBIT A-1

GENERAL GROWTH MANAGEMENT, INC.  
400 South Highway 169 Minneapolis, MN

AGENT FOR THE OWNER

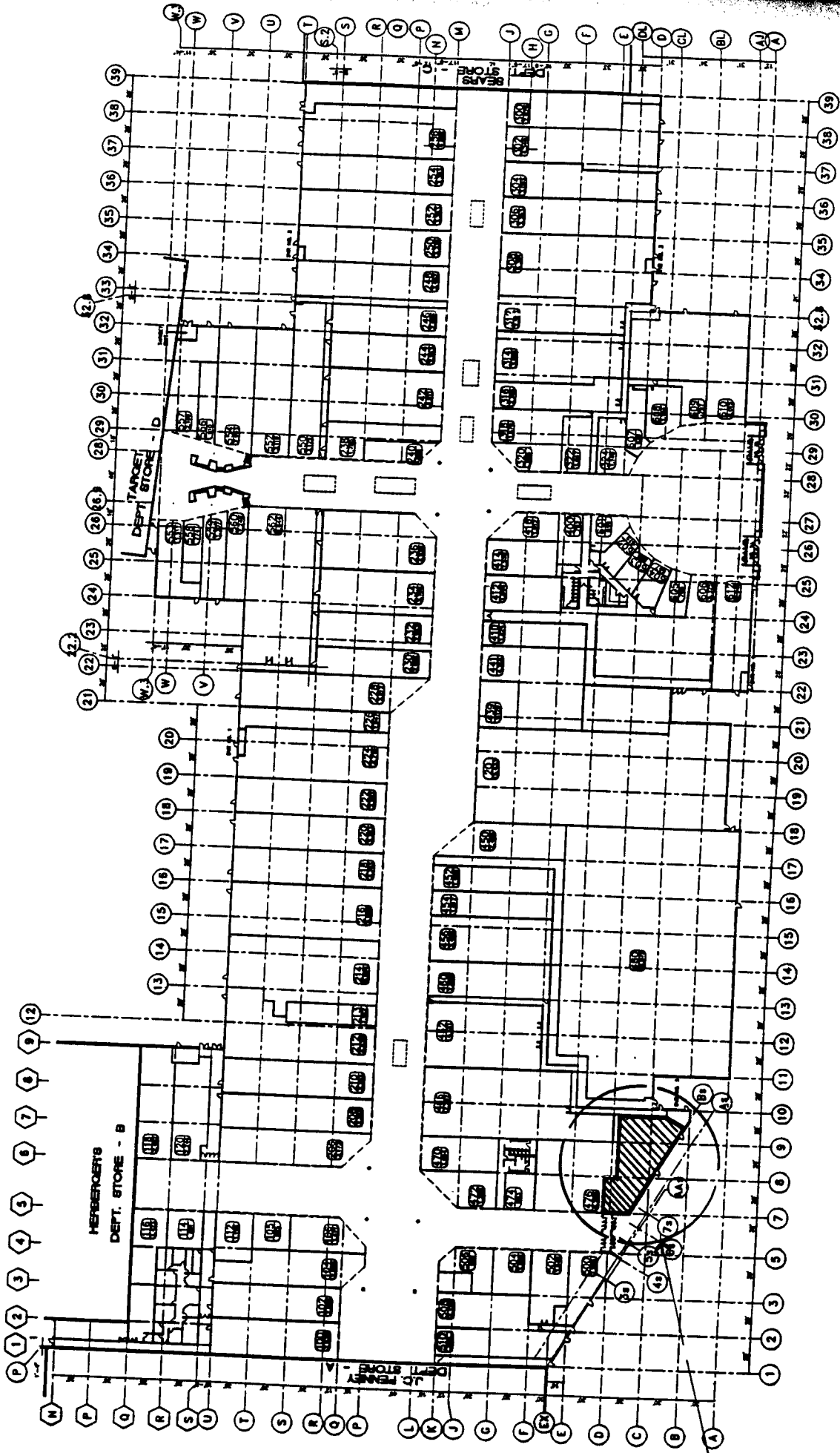

SPACE #478

# USHMORE MALL

RAPID CITY, SOUTH DAKOTA

VANT DIAMOND DAVE'S TACO CO.	
SPACE 478	SQ.FT. 2893
DATE 5-15-96	

## RECEIVED

APR 29 2011

Rapid City Growth Management Department