

# VACATION OF PORTION OF NON-ACCESS EASEMENT, TRACT C OF BIG SKY SUBDIVISION

LOCATED IN THE SW1/4 OF THE NE1/4  
SECTION 3, T1N, R8E, BHM  
RAPID CITY, PENNINGTON COUNTY, SOUTH DAKOTA

GOVERNMENT  
LOT 2  
SECTION 1/16 LINE

GOVERNMENT  
LOT 1

SECTION 1/4 LINE

TRACT A

TRACT C

SECTION 1/16 LINE

SE1/4  
-NE1/4

JANUARY 21, 2010

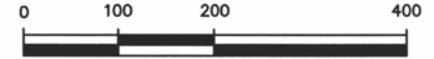

SCALE 1" = 200'

BIG SKY  
SUBDIVISION

NON-ACCESS  
EASEMENT AS  
SHOWN IN PLAT  
BOOK 32, PAGE 39  
(TYP.)

PORTION OF NON-ACCESS  
EASEMENT AS SHOWN IN  
PLAT BOOK 32, PAGE 39  
TO BE VACATED  
THIS DOCUMENT

AURORA  
DRIVE

HOMESTEAD STREET  
76' WIDE R.O.W. OF RECORD

80.0' 114.0'

TRACT B

CARL  
AVENUE

12B  
12A  
11B

12 6  
11 ZIEBACH  
STREET

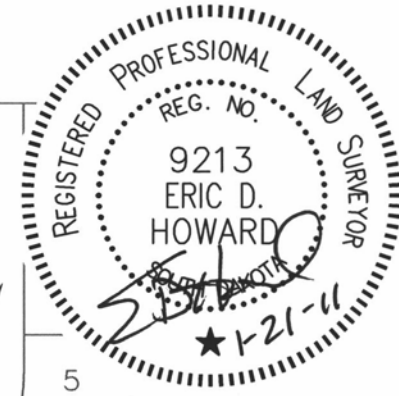

**RENNER & ASSOCIATES, LLC.**

616 SIXTH ST. \* RAPID CITY, SD 57701  
PHONE: 605/721-7310 \* FAX: 605/721-7313  
EMAIL: GARY@RENNERASSOC.COM



CITY HALL 1903