

CITY OF RAPID CITY  
GROWTH MANAGEMENT DEPT.  
DEVELOPMENT SERVICES

Plans are reviewed for general conformance with applicable governmental regulations, stipulations, design criteria and engineering standards. The City of Rapid City does not certify the suitability, adequacy or completeness of the plans or design, which are the responsibility of the engineer of record. All necessary permits shall be obtained prior to construction of the proposed public improvements.

Engineering Reviewer: \_\_\_\_\_ Date: \_\_\_\_\_  
COMMENTS: \_\_\_\_\_

Submittals:

Revisions:

Internal Job No. 10-0582	Designed By TC	Drawn By: PMW
Surveyed By: RENNER		Survey Date: FEB 2011

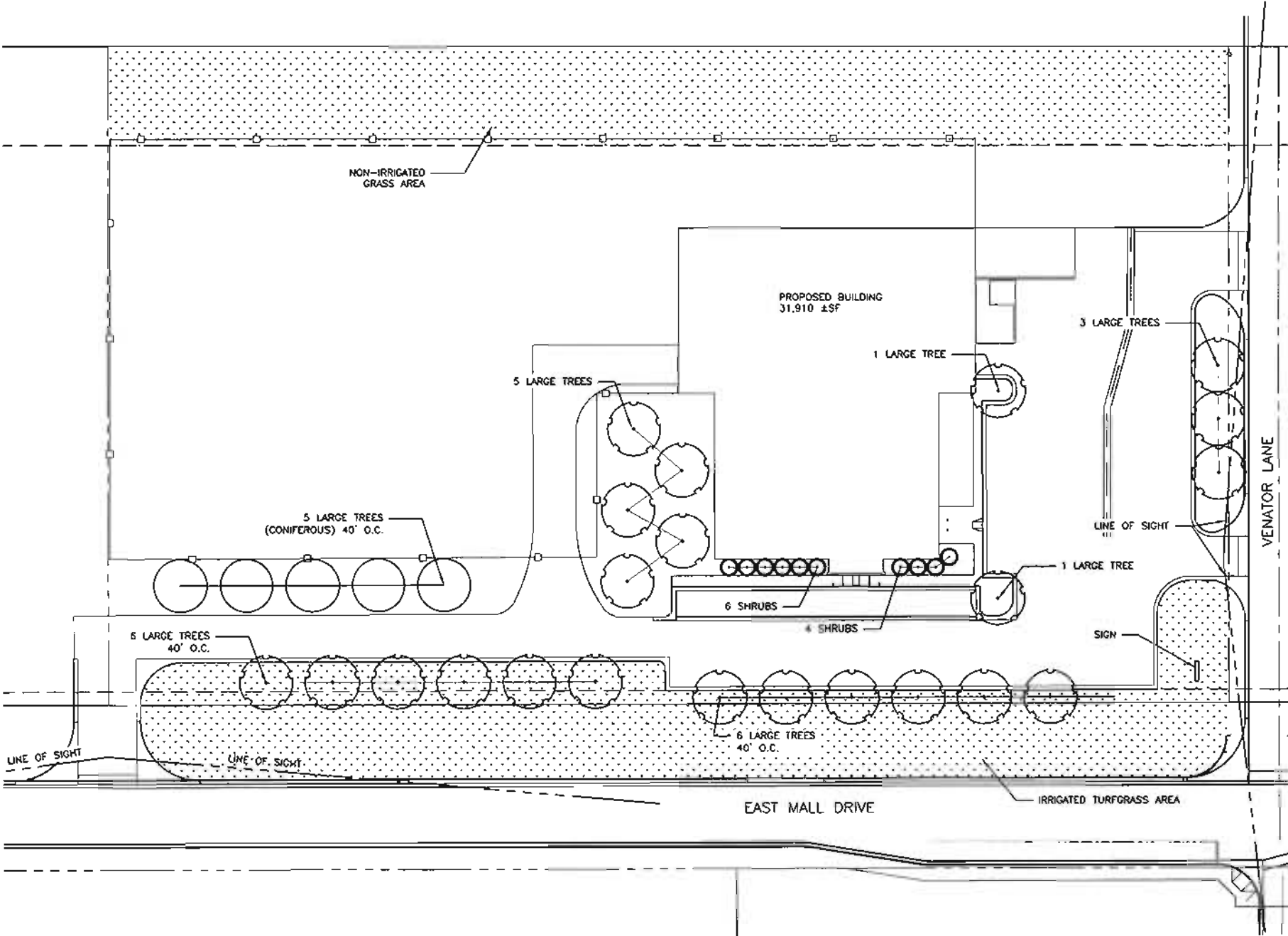

- PLANTING NOTES**
- THE CONTRACTOR SHALL COORDINATE PLANTING INSTALLATION WITH OTHER CONTRACTORS PERFORMING WORK ON SITE.
  - PRIOR TO CONSTRUCTION, THE CONTRACTOR SHALL BE RESPONSIBLE FOR LOCATING ALL UNDERGROUND UTILITIES AND SHALL AVOID DAMAGE TO ALL UTILITIES DURING THE COURSE OF THE WORK. THE CONTRACTOR IS RESPONSIBLE FOR REPAIRING ANY AND ALL DAMAGE TO UTILITIES, STRUCTURES, SITE APPURTENANCES, ETC WHICH OCCURS AS A RESULT OF THE LANDSCAPE AND IRRIGATION CONSTRUCTION.
  - THE CONTRACTOR IS SPECIFICALLY CAUTIONED THAT THE LOCATIONS AND/OR ELEVATION OF EXISTING UTILITIES AS SHOWN ON THESE PLANS IS BASED ON RECORDS OF THE VARIOUS UTILITY COMPANIES AND, WHERE POSSIBLE, MEASUREMENTS TAKEN IN THE FIELD. THE INFORMATION IS NOT TO BE RELIED ON AS BEING EXACT OR COMPLETE. THE CONTRACTOR MUST CALL THE APPROPRIATE UTILITY COMPANY TO REQUEST EXACT FIELD LOCATION OF UTILITIES. IT SHALL BE THE RESPONSIBILITY OF THE CONTRACTOR TO RELOCATE ALL EXISTING UTILITIES WHICH CONFLICT WITH THE PROPOSED IMPROVEMENTS SHOWN ON PLANS.
  - NO PLANT OR CULTIVAR SUBSTITUTION WILL BE ACCEPTABLE WITHOUT WRITTEN APPROVAL BY THE LANDSCAPE ARCHITECT OR OWNER'S CIVIL ENGINEERING CONSULTANT.
  - ALL PLANTING LOCATIONS SHALL BE STAKED OR SET OUT BY THE CONTRACTOR. THE CONTRACTOR SHALL NOTIFY THE LANDSCAPE ARCHITECT 2 DAYS PRIOR TO PLANTING THE STAKING IS COMPLETE.
  - ALL TREES AND SHRUBS SHALL BEAR THE SAME RELATIONSHIP TO PLANTED GRADE AS IN THE NURSERY.
  - ALL SYNTHETIC MATERIALS FROM AROUND THE TREE TRUNK AND ROOT BALL SHALL BE REMOVED AND NOT INCLUDED WITHIN THE BACKFILL SOIL MIX. STRING, ROPE, SYNTHETIC BURLAP, PLASTIC, STRAPPING, AND OTHER MATERIALS THAT WILL NOT DECOMPOSE IN THE SOIL SHALL BE REMOVED AT PLANTING.
  - THE CONTRACTOR SHALL EXERCISE CARE IN THE INSTALLATION OF ALL PLANTING MATERIAL. ANY PLANT MATERIAL INJURED OR DESTROYED DURING CONSTRUCTION SHALL BE REPLACED BY THE CONTRACTOR AT NO COST TO THE OWNER.
  - ALL PLANTING MATERIAL SHALL HAVE A 2 YEAR WARRANTY PERIOD. TURF SHALL HAVE A 90 DAY WARRANTY PERIOD.
    - THE WARRANTY PERIOD SHALL BEGIN ONCE PLANTING AND IRRIGATION HAVE BEEN ACCEPTED IN WRITING FROM THE OWNER.
  - THE PLANTING SEASON SHALL BE FROM:
    - SPRING: APRIL 15TH TO JUNE 15TH
    - FALL: SEPT. 1ST TO OCT. 1ST.
  - TREE SHALL BE SPRAYED WITH AN ANTI-DESICCANT PRIOR TO LEAVING THE NURSERY AND WITHIN 24 HOURS OF PLANTING.
  - A SLOW RELEASE FERTILIZER SHALL BE APPLIED TO THE PLANTING SOIL AS PER THE PLANTING SPECIFICATIONS AND SOIL TEST RECOMMENDATIONS. THE FERTILIZER SHALL BE APPLIED AT A RATE AS PER SOIL TEST RECOMMENDATIONS. FOR TREES, SLOW RELEASE FERTILIZER TABLETS PLACED IN PLANTING PITS ARE ACCEPTABLE.
  - ALL MULCH USED ON SITE SHALL BE A SHREDDED HARDWOOD MULCH. THE MULCH SHALL BE INSTALLED TO A 4" DEPTH.
  - ALL PLANT STOCK SHALL COMPLY WITH THE CURRENT EDITION OF THE AMERICAN STANDARD FOR NURSERY STOCK.
  - ALL PLANTING SOURCES SHALL BE FROM LIKE CLIMATES AND SOIL CONDITIONS AS PROJECT. NOTIFY LANDSCAPE ARCHITECT IF PLANTING SOURCES ARE OUTSIDE OF A 300 MILE DISTANCE FOR REVIEW OF NURSERY AND CONDITIONS.
  - UNLESS OTHERWISE INDICATED ALL PLANTING BEDS IN TURF AREAS SHALL BE BORDERED BY A 1/2" THICK, 4" BLACK STEEL LANDSCAPE EDGER. SEE PLANTING DETAILS.
  - FINISHED GRADE SHALL BE HELD 3 INCHES BELOW TOP OF CURB AND 2 INCHES BELOW TOP OF CURB FOR SOO. OTHER AREAS AS SPECIFIED, SHALL RECEIVE A MULCH DEPTH OF 4" OVER THE ROOT BALL.
  - IF A CONFLICT IS FOUND BETWEEN THE PLANTING SCHEDULE AND THE PLAN COUNT, THE PLAN COUNT TAKES PRECEDENCE OVER THE PLANTING SCHEDULE.
  - TURFGRASS SOO: SEE PLAN FOR LOCATIONS
    - SOO SHALL BE WELL-ROOTED AND BE COMPLETELY FREE FROM NOXIOUS WEEDS AND REASONABLY FREE FROM OTHER OBJECTIONABLE GRASSES, WEEDS, AND STONES. SODDING AND SEEDING SHALL BE DONE IN ACCORDANCE WITH THE SOUTH DAKOTA STANDARD SPECIFICATIONS FOR HIGHWAY CONSTRUCTION, CERTIFIED, COMPLYING WITH "SPECIFICATIONS FOR TURFGRASS SOO MATERIALS" IN TPI'S "GUIDELINE SPECIFICATIONS TO TURFGRASS SODDING." FURNISH VIABLE SOO OF UNIFORM DENSITY, COLOR, AND TEXTURE, STRONGLY ROOTED, AND CAPABLE OF VIGOROUS GROWTH AND DEVELOPMENT WHEN PLANTED.
    - THE SOO SHALL BE A FULL SUN MIX KENTUCKY BLUE GRASS (POA PRATENSIS) MIX CONTAINING A MINIMUM OF 3 CULTIVARS.
    - LAY SOO WITHIN 24 HOURS OF HARVESTING. DO NOT LAY SOO IF DORMANT OR IF GROUND IS FROZEN OR MUDDY.
    - LAY SOO TO FORM A SOLID MASS WITH TIGHTLY FITTED JOINTS. BUTT ENDS AND SIDES OF SOO; DO NOT STRETCH OR OVERLAP. STAGGER SOO STRIPS OR PADS TO OFFSET JOINTS IN ADJACENT COURSES. AVOID DAMAGE TO SUBGRADE OR SOO DURING INSTALLATION. TAMP AND ROLL LIGHTLY TO ENSURE CONTACT WITH SUBGRADE, ELIMINATE AIR POCKETS, AND FORM A SMOOTH SURFACE. WORK SIFTED SOIL OR FINE SAND INTO MINOR CRACKS BETWEEN PIECES OF SOO; REMOVE EXCESS TO AVOID SMOTHERING SOO AND ADJACENT TURF GRASS IS TO BE PLANTED AROUND THE VEGETATION BUFFER.
  - THE CONTRACTOR SHALL FULLY COMPLY WITH ALL RAPID CITY ZONING CODES SECTION 17.50.300 - LANDSCAPE ORDINANCE.
  - ALL LANDSCAPE BEDS SHALL HAVE LANDSCAPE FABRIC INSTALLED UNDER THE MULCH BED.
    - COMPOSITE FABRIC: WOVEN, NEEDLE-PUNCHED POLYPROPYLENE SUBSTRATE BONDED TO A NONWOVEN POLYPROPYLENE FABRIC, 4.8 OZ./SQ. YD.
  - THE PLANT MATERIAL INSTALLATION SHALL BE TIMED WITH IRRIGATION INSTALLATION ALLOWING PLANTS TO GET RECOMMENDED WATER AMOUNTS. OTHER THAN IMMEDIATE PLANT WATERING, TEMPORARY WATERING SHALL NOT BE ALLOWED.
  - ALL PLANTS ARE SUBJECT TO THE APPROVAL OF THE LANDSCAPE ARCHITECT AND/OR OWNER BEFORE, DURING AND AFTER INSTALLATION.
  - CONTRACTOR IS RESPONSIBLE FOR VERIFYING ALL QUANTITIES SHOWN ON THESE PLANS BEFORE PRICING THE WORK.
  - ALL PLANTS MUST BE HEALTHY, VIGOROUS MATERIAL, FREE OF PEST AND DISEASE.
  - ALL PLANTS MUST BE CONTAINER GROWN OR BALLED AND BURLAPPED AS INDICATED IN THE PLANT LIST.
  - ALL TREES MUST BE STRAIGHT TRUNKED AND FULL HEADED AND MEET ALL REQUIREMENTS SPECIFIED.
  - CONTRACTOR TO TAKE SPECIAL CARE TO MAINTAIN SOO IN THE AREAS OF CHANNELIZED FLOW UNTIL SOO HAS ESTABLISHED THE DRAINAGE WAYS. INLETS MUST BE KEPT FREE OF SEDIMENT, ANY AREAS OF EROSION MUST BE MAINTAINED IMMEDIATELY.

**PLANTING NOTES**

FOR CITY OF RAPID CITY USE ONLY  
LANDSCAPE SUMMARY

TOTAL BUILDING SQ.FT.	31,910 SF
SITE AREA PHASE 1 - 6.20 ACRES	207,289 SF
LANDSCAPE POINTS REQUIRED	175,379

LANDSCAPE POINTS PROVIDED: 149,393

ITEM	QUANTITY	POINT VALUE	TOTAL POINTS
CONIFER SHRUB	10	250	2,500
DECIDUOUS TREES	22	2000	44,000
CONIFEROUS TREES	5	2000	10,000
TURFGRASS (SY)	4761	10	47,610
NATIVE GRASS & FORBS (SY)	4528	10	45,280
TOTAL			149,393 POINTS

**IRRIGATION NOTE:**  
THE IRRIGATION SYSTEM WILL BE A SPRAY AND DRIP SYSTEM. TURF AREAS WILL UTILIZE ROTORS AND SPRAY HEADS, ALL PLANTING AREAS SHALL BE XERISCAPE SYSTEMS AND RECEIVE EMITTERS. THE IRRIGATION SYSTEM WILL BE SUPPLIED BY A 2" BACKFLOW PREVENTOR AND SHALL BE A LOCATED IN THE BUILDINGS MECHANICAL ROOM. ALL PLUMBING SHALL FOLLOW LOCAL PLUMBING CODES.

**PRELIMINARY FOR REVIEW ONLY**

**DREAM DESIGN INTERNATIONAL, INC.**  
ENGINEERING, LANDSCAPE ARCHITECTURE, LAND PLANNING, CONSTRUCTION ADMINISTRATION  
528 KANABAS CITY STREET, SUITE 4, RAPID CITY, SD 57701  
PHONE: (605) 348-0538 FAX: (605) 348-0545 WWW.DREAMDESIGNING.COM

**BORDER STATES ELECTRIC**  
RAPID CITY, SD

**RECEIVED**

FEB 28 2011

Rapid City Growth Management Department  
LANDSCAPING PLAN

Sheet Number of 9

