



2 PHOTOS
ALL NTS



3 PHOTO
ALL NTS



4 PHOTOS
ALL NTS



PROJECT ARCHITECT:
ARC INTERNATIONAL
 5808 SHERIDAN LAKE ROAD
 RAPID CITY, SD 57702
 P. 605-341-2666

STRUCTURAL ENGINEER:
ALBERTSON ENGINEERING, INC.
 3202 WEST MAIN SUITE C
 RAPID CITY, SD 57702
 P. 605-343-9608

MECHANICAL/ELECTRICAL ENGINEER:
SKYLINE ENGINEERING, LLC.
 615 12TH STREET
 RAPID CITY, SD 57701
 P. 605-737-3800

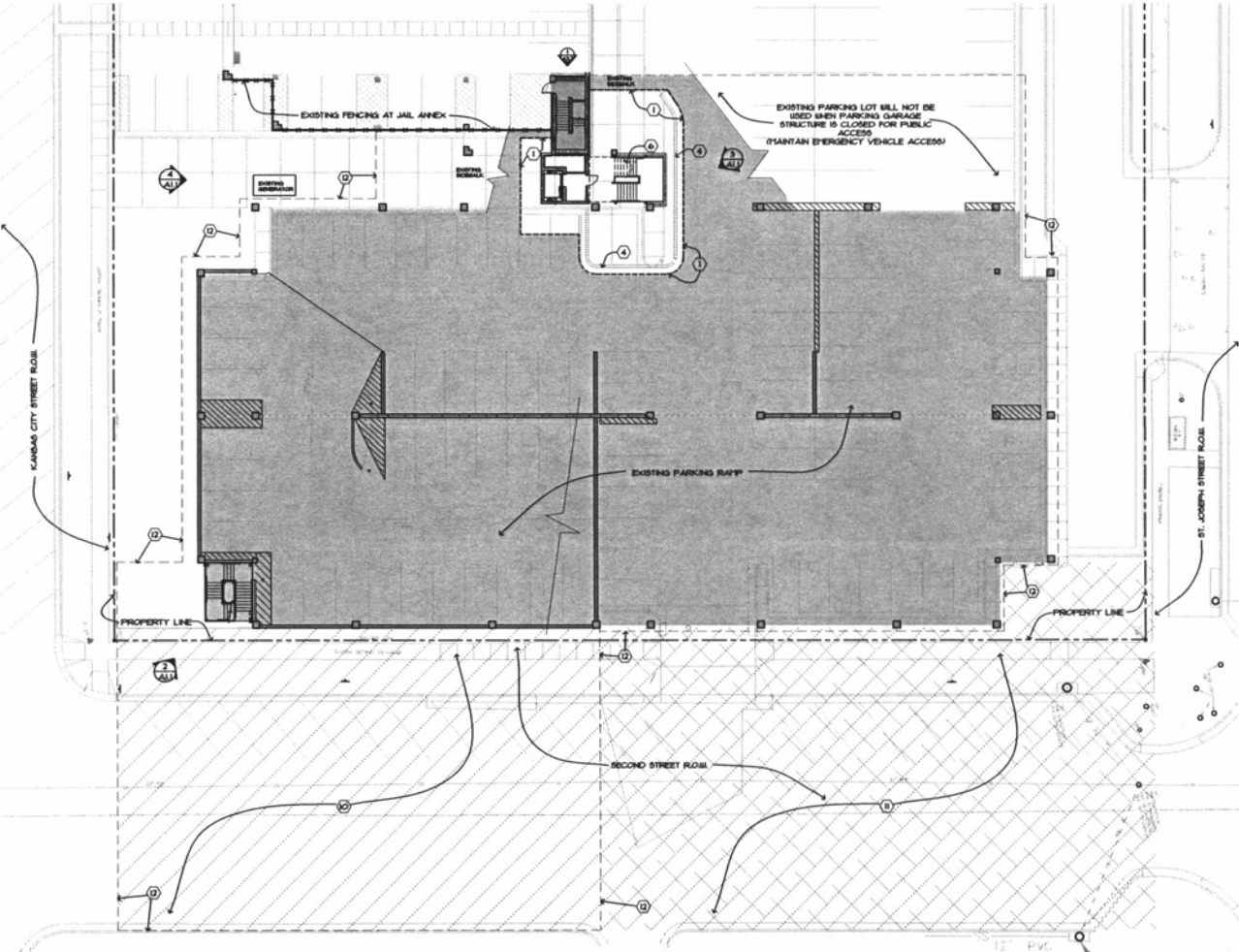

GENERAL NOTES
 A) VERIFY ALL EXISTING HORIZONTAL AND VERTICAL DIMENSIONS
 B) COORDINATE ALL DIMENSIONS AND LAYOUT INFORMATION WITH STRUCTURAL DETAILS

- KEY NOTES
- 1 REMOVE EXISTING CURB, GUTTER AND SURROUNDING ASPHALT AND CONCRETE PAVING TO ACCOMMODATE NEW SIDEWALK, CURB AND GUTTER. SMOKE EDGES TO REMAIN. COORDINATE WITH REQUIREMENTS FOR NEW STRUCTURE AND PAVING.
 - 2 REMOVE EXISTING GUARDRAIL AND HANDRAIL. PREPARE EXISTING STAIR STRUCTURE FOR NEW STAIRS.
 - 3 REMOVE AND RELOCATE EXISTING STRUCTURAL ELEMENT TO PARKING STRUCTURE FIFTH LEVEL. COORDINATE WITH STRUCTURAL DRAWINGS.
 - 4 NEW SIDEWALK, CURB AND GUTTER. COORDINATE WITH GUTTER DETAIL 2/A21.
 - 5 6" DIA. PAINTED STEEL PIPE CONCRETE FILLED BOLLARDS. SEE STRUCTURAL FOR CONNECTION DETAIL.
 - 6 STAIR TOWERS
 - SEE STRUCTURAL
 - PAINTED/SPECIAL COATINGS ON ALL STEEL SURFACES
 - SEALED CONCRETE FLOORS, LANDINGS, AND TREADS
 - 4"X4" STEEL TOP AND BOTTOM CHORDS
 - 2"X2" STEEL PICKETS AT 6" O.C.
 - 1" ROUND STEEL HANDRAIL AT EACH SIDE OF STAIRS
 - 7 PARKING STRIPING AT NEW OR REVISED CONSTRUCTION
 - 8 PARKING GUARDRAIL
 - PAINTED/SPECIAL COATINGS
 - 4"X4" STEEL TOP AND BOTTOM CHORDS
 - 2"X2" STEEL PICKETS AT 6" O.C.
 - SEE STRUCTURAL
 - 9 INSULATED FLOOR SLAB
 - 4" CONCRETE OVER 3" RIGID INSULATION
 - 10 CONSTRUCTION STAGING AREA #1. AVAILABLE TO CONTRACTOR FOR ENTIRE PROJECT DURATION. COORDINATE WITH SUPPLEMENTAL CONDITIONS.
 - 11 CONSTRUCTION STAGING AREA #2. AVAILABLE TO CONTRACTOR ONLY WHEN PARKING GARAGE IS CLOSED FOR PUBLIC ACCESS. AREA #2 WILL NOT BE FENCED OFF. COORDINATE WITH SUPPLEMENTAL CONDITIONS.
 - 12 PROJECT SECURITY FENCE. PROVIDE 8' HIGH CHAIN LINK FENCE. PROVIDE ACCESS GATES TO ACCOMMODATE CONSTRUCTION STAFF, EQUIPMENT AND VEHICLES.

1 SITE PLAN
 ALL 1/16"=1'-0"
 NORTH

DATE: FEBRUARY 16, 2011
 PROJECT MANAGER: CHRIS OLNEY
 PROJECT NUMBER: 2010-027.1



PENNINGTON COUNTY
CAMPUS EXPANSION
PARKING STRUCTURE ADDITION
 RAPID CITY, SOUTH DAKOTA

SITE PLAN

A1.1

