

1 SECTION: TYPICAL B&B DECIDUOUS TREE  
19a NO SCALE

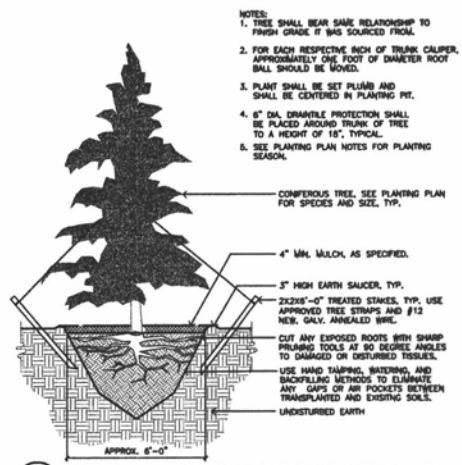

2 SECTION: 12' TRANSPLANTED CONIFEROUS TREE  
19a NOT TO SCALE

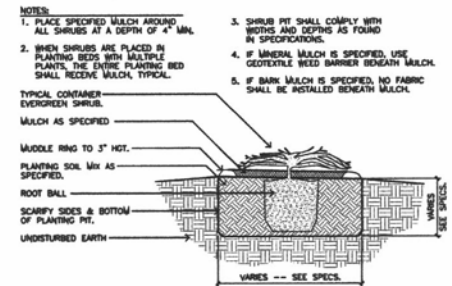

3 SECTION: CONTAINER CONIFEROUS SHRUB  
19a NO SCALE

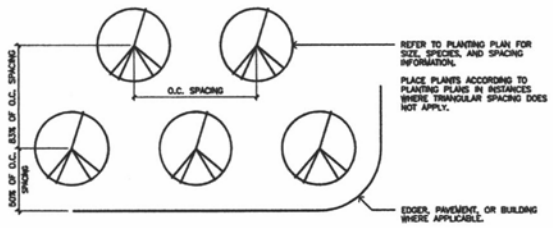

4 PLAN: TYPICAL TRIANGULAR SPACING PLANTING LAYOUT  
19a NO SCALE

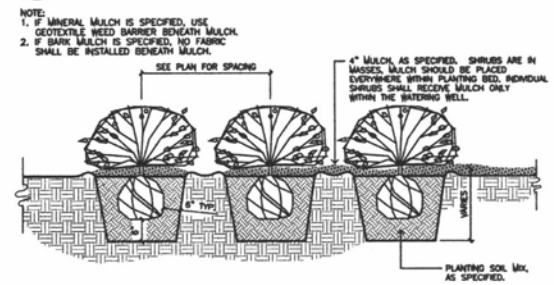

5 SECTION: TYPICAL SHRUB PLANTING BED  
19a NO SCALE

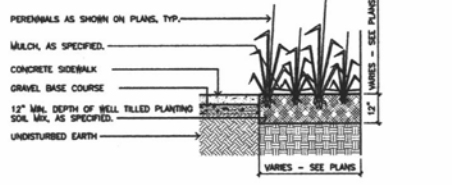

6 SECTION: PERENNIAL PLANTING BED DETAIL  
19a SCALE: 1/2\"/>

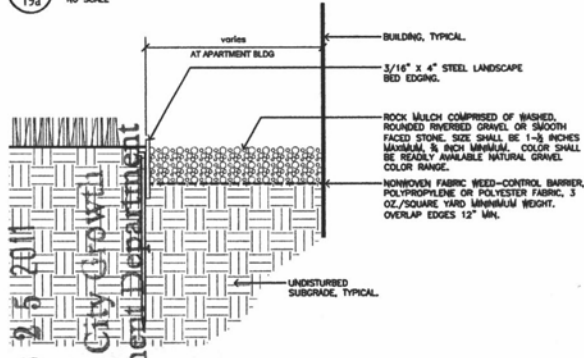

7 SECTION: MOWING EDGE DETAIL, TYPICAL  
19a NO SCALE

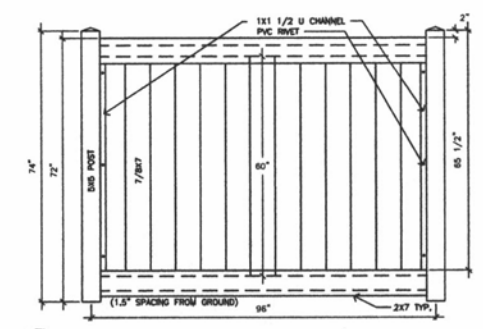

8 ELEVATION: 'LAKELAND' VINYL FENCE  
19a SCALE: 3/4\"/>

- NOTES:
1. TREE SHALL BEAR SAME RELATIONSHIP TO FINISH GRADE AS IT GREW IN NURSERY.
  2. FOR EACH RESPECTIVE INCH OF TRUNK CALIPER, APPROXIMATELY ONE FOOT OF DIAMETER ROOT BALL SHOULD BE MOVED.
  3. PLANT SHALL BE SET PLUMB AND SHALL BE CENTERED IN PLANTING PIT.
  4. 6\"/>

- NOTES:
1. PLACE SPECIFIED MULCH AROUND ALL SHRUBS AT A DEPTH OF 4\"/>

- NOTE:
1. IF MINERAL MULCH IS SPECIFIED, USE GEOTEXTILE WEED BARRIER BENEATH MULCH.
  2. IF BARK MULCH IS SPECIFIED, NO FABRIC SHALL BE INSTALLED BENEATH MULCH.

CITY OF RAPID CITY  
GROWTH MANAGEMENT DEPT.  
DEVELOPMENT SERVICES

Plans are intended for general guidance with applicable governmental regulations, stipulations, design details and engineering annotations. The City of Rapid City does not verify the suitability, adequacy or completeness of the plans or design, which are the responsibility of the engineer or owner. All necessary permits shall be obtained prior to installation of the proposed public improvements.

Engineering Review: \_\_\_\_\_ Date: \_\_\_\_\_  
Comments: \_\_\_\_\_

Wysse Associates, Inc.  
Landscape Architecture  
Parks & Recreation Design  
701 S.W. 51st Ave. - Rapid City, South Dakota 57701-3670  
Tel: 605.348.2256 Fax: 605.348.6506  
email: info@wysse-associates.com

REGISTERED LANDSCAPE ARCHITECT  
REG. NO. 4918  
PATRICK H. WYSS  
SOUTH DAKOTA  
7-11-11

Project Name: Black Hills Estates Eagle Ridge Rapid City, South Dakota

Planting Details

DESIGNED BY: MSJ/PWV  
DRAWN BY: JAW  
APPROVED BY: PWV  
PROJECT NO.: 65301.1  
DATE: \_\_\_\_\_

NO.	REVISION	DATE

Sub Sheet: 19a  
Sheet: \_\_\_\_\_ OF \_\_\_\_\_

RECEIVED

2011  
City of Rapid City  
Management Department



PO Box 2886  
Rapid City, SD 57709  
(605) 342-8865  
(605) 342-3077 fax

RECEIVED

FEB 25 2011

Rapid City Growth  
Management Department

See attachment from Plants Beautiful Nursery, located in Minnesota, regarding the delivery of Coniferous trees for Eagle Ridge Phase II.

Luke Laverack  
President  
Shamrock Enterprises Inc.

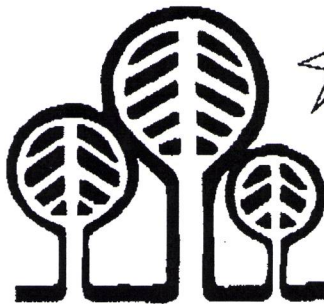

**PLANTS  
BEAUTIFUL  
NURSERY, INC.**

15927 CO HWY 42 • Parkers Prairie, MN 56361-4552  
218-338-6267 • (800) 451-762376 • Fax (218) 338-5297  
www.plantsbeautifulnursery.com • pbz@midwestinfo.com

To: Shar  
Shamrock Enterprises, Inc.

February 15, 2011

In reference to your order of trees for this spring, we will be able to start our spring digging around Mid May. The ideal time to plant these trees for the most optimum growth and survival is middle to late May, as the trees will start there active growth for the year after that.

If you have any more questions give me a call.

Thank You  
Lowell Dittberner  
Vice President  
Plants Beautiful Nursery, Inc.

RECEIVED

FEB 25 2011

Rapid City Growth  
Management Department