

PLANT MATERIAL SCHEDULE

KEY	QTY.	COMMON NAME	BOTANICAL NAME	SIZE
DECIDUOUS TREES				
AE	12	Accolade Elm	Ulmus 'Morton'	2" B&B
BO	3	Bur Oak	Quercus macrocarpa	2" B&B
FL	2	Frantford Linden	Tilia americana 'Baltard'	2" B&B
GL	4	Greenspire Linden	Tilia cordata 'Greenspire'	2" B&B
IW	6	Ironwood	Ostrya virginiana	2" B&B
NAH	9	Northern Acclaim Honeylocust	Gleditsia triacanthos var. inermis 'Horse'	2" B&B
OB	4	Ohio Buckeye	Aesculus glabra	2" B&B
SM	1	Silver Cloud Maple	Acer saccharinum 'Silver Cloud'	2" B&B
ORNAMENTAL TREES				
CH	5	Thornless Cocksaur Hawthorn	Crataegus crus-galli var. inermis	5' ht
DG	10	Snow Mantle Gray Dogwood	Cornus racemosa 'Snow Mantle'	5' ht
PGP	5	Prairie Gem Pear	Pyrus ussuriensis 'Mordak'	5' ht
RSC	3	Red Spander Crab	Malus 'Red Spendor'	5' ht
EVERGREEN TREES				
BH	3	Black Hills Spruce	Picea glauca var. densata	5' ht B&B
ET	8	Existing P. Pine to relocate	Pinus ponderosa	5' ht B&B
FP	4	Funderbas Pine	Pinus ponderosa	5' ht B&B
RJ	13	Rocky Mountain Juniper	Juniperus scopulorum	5' ht B&B
VLP	5	Vanderwolf Limber Pine	Pinus flexilis 'Vanderwolf's Pyramid'	5' ht B&B
DECIDUOUS SHRUBS				
DN	4	Center Glow Ninebark	Physocarpus opulifolius 'Center Glow'	18" ht
GS	16	Gr-Low Sumac	Rhus aromatica 'Gr-Low'	#2 cont.
PC	26	Pygmy Caragana	Caragana pygmaea	12" ht
WS	3	Western Sandcherry	Prunus besseyi	#2 cont.
PERENNIALS				
IG	3	Indian Grass	Sorghastrum nutans	#1 cont.
LB	27	Little Bluestem	Schizachyrium scoparium	#1 cont.

LANDSCAPE MATERIAL POINT TABLE

SITE AREA INFORMATION:

SITE AREA:	253,798 SF
PROPOSED BUILDING AREA:	789 SF
TOTAL LANDSCAPE POINTS REQUIRED:	253,009
PARKING LOT LANDSCAPE POINTS REQUIRED:	126,504
PARKING LOT LANDSCAPE POINTS PROVIDED:	127,490

PROPOSED SITE LANDSCAPE POINTS:

PLANT TYPE	QUANTITY	POINTS	TOTAL
LARGE TREE:	68	2,000	136,000
MEDIUM TREE:	21	1,000	21,000
SMALL TREE:	21	500	10,500
SHRUB:	49	250	12,250
TURF AREA:	13,556 SY	10	135,560
GROUND COVER:	10 SY	100	1,000
TOTAL POINTS:			316,310

EXISTING SITE LANDSCAPE POINTS:

PLANT TYPE	QUANTITY	POINTS	TOTAL
LARGE TREE:	16	2,000	32,000
SMALL TREE:	-	-	-
SHRUB:	-	-	-
TURF AREA:	3,851 SY	10	38,510
TOTAL EXISTING LANDSCAPE POINTS:			70,510
TOTAL LANDSCAPE POINTS PROVIDED:			386,820

LANDSCAPE NOTES:

- UNDERGROUND UTILITIES: THE CONTRACTOR IS RESPONSIBLE TO VERIFY ALL UNDERGROUND UTILITIES PRIOR TO CONSTRUCTION. NOTIFY OWNER REPRESENTATIVE OF ANY DISCREPANCIES. SOUTH DAKOTA ONE CALL NOTIFICATION: 800-781-7474.
- VERIFY QUANTITIES: QUANTITIES PROVIDED ON DRAWINGS ARE FOR INFORMATION ONLY. CONTRACTOR IS RESPONSIBLE FOR DETERMINING ACTUAL QUANTITIES OF ALL MATERIALS TO COMPLETE PROJECT.
- PLANTING SOIL: PROVIDE 12" MIN. PLANTING SOIL IN ALL SHRUB & PERENNIAL AREAS. SEE SPECIFICATIONS AND LANDSCAPE DETAILS.
- PLANT MATERIAL SCHEDULE: REFER TO LANDSCAPE DETAILS SHEET L2.X FOR PLANT MATERIAL SCHEDULE.

SEEDING REQUIREMENTS:

NON-IRRIGATED SEED MIX:

	LB./P.L.S
Blue gramma 'Bad River'	0.42
Streambank Wheatgrass 'Sodar'	0.42
Conky Bluegrass 'Conbar'	0.28
Buffalograss 'Bowie' or 'Cody'	0.14
Prairie Junegrass 'VNS'	0.14
TOTAL PURE LIVE SEED PER 1,000 SF (60 LBS PLS/ACRE)	1.40

IRRIGATED SEED MIX:

	%/MIX
Amorpha Canadensis Fescue	20%
Fine-leaf Perennial Ryegrass	20%
Silty Alkaligrass	20%
Creeping Red Fescue 'Epic'	20%
Kentucky Bluegrass 'Dix'	20%

7 LBS PURE LIVE SEED PER 1,000 SF

LANDSCAPE KEY NOTES:

- LANDSCAPE EDGING: INSTALL ONE OF THE FOLLOWING LANDSCAPE EDGINGS OR APPROVED EQUAL AS INDICATED ON PLAN:
 - 3/4" x 4" DEEP STEEL EDGING BY SURE-LOC STEEL EDGING, COLOR: BROWN
 - 3/4" x 4" DEEP STEEL EDGING NO. 10 BY PROSTEEL EDGING, COLOR: BROWN
- ORGANIC MULCH: PROVIDE 3" MIN. DEPTH SHREDDED WOOD MULCH OVER TYPARB® BIOBARRIER® WEED CONTROL SYSTEM OR APPROVED EQUAL.
- IRRIGATED TURF AREAS: PROVIDE MIN. 6" DEPTH OF TOPSOIL & SEED AS SPECIFIED WITH IRRIGATED SEED MIX.
- NON-IRRIGATED TURF AREAS: PROVIDE MIN. 6" DEPTH OF TOPSOIL & SEED AS SPECIFIED WITH NON-IRRIGATED SEED MIX. AREAS SHOWN TO BE SEEDING ARE APPROXIMATED - REFER TO DEMOLITION, GRADING, AND UTILITY PLANS FOR AREAS DISTURBED BY CONSTRUCTION. CONTRACTOR TO SEED ALL TURF AREAS DISTURBED BY CONSTRUCTION.

LANDSCAPE SYMBOLS:

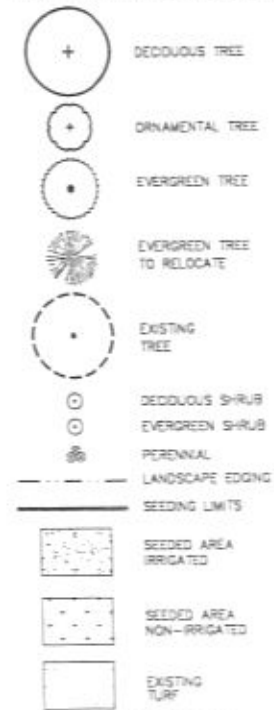

DESIGN WORKS INC.
 126 West Joseph St.
 Rapid City, SD 57701
 Tel: 605/394-0394
 Fax: 605/394-0398



Public Works Department
 Rapid City, SD 57701
 Phone: (605) 341-7800
 Fax: (605) 341-7804
 www.rapidcityengineering.com

cetec
 610-441-1111

Scale: 1"=20'-0"

Designed By:	R.J.F.	Drawn By:	T.J.D.
Design Date:	11/12/10	Print Date:	11/12/10
Internal Job No.:	09182.00	Surveyed By:	KPICH
Surveyed Date:	2010	Survey Date:	2010

RAPID CITY GREENWAY TRAILS
 AND PEDESTRIAN FACILITIES

Sheet Title: LANDSCAPE POINTS PLAN
 Sheet No.: L1

RECEIVED

NOV 1 2010
 Rapid City, South Dakota