

VERIZON WIRELESS

RCYC SOUTH RAPID CITY LTE

SITE PHOTO



GENERAL NOTES

- In the event that Special Inspections are not performed in compliance with the contract terms, bid specifications and/or specified form, the General Contractor will be liable for all damages, construction performance failures, and corrective actions related to the same.
- The following general notes shall apply to drawings and general notes otherwise noted or specified.
- The work indicated on these drawings and described in the specifications shall conform to codes, standards and regulations that have jurisdiction in the state of SOUTH DAKOTA, and the city of RAPID CITY.
- Requirements and regulations pertaining to R.F. safety codes and practices must be incorporated in the work even though they may not be listed individually and occasionally in either the drawings or the specifications.
- Compare field conditions with architectural and engineering drawings. Any discrepancies shall be directed to the Architect for clarification prior to fabrication and/or construction. Submit necessary shop drawings prior to fabrication or install on these sheets to be used without the permission of the owner or the architect.
- Do not scale drawings! 11" x 17" drawings to scale 3/4" = 1'; 24" x 36" drawings scale multiply by 2.
- Unless otherwise shown or noted, typical details shall be used where applicable.
- Details shall be consistent typical at similar conditions.
- Safety measures: The contractor shall be solely and completely responsible for the conditions of the job site, including safety of the persons and property and for independent engineering reviews of these conditions. The Architect's or Engineer's job site review is not intended to include review of the adequacy of the contractor's safety measures.
- Wires, trees, plants and specifications: "Owner" implies VERIZON WIRELESS.
- The work is the responsibility of the general contractor unless noted otherwise.
- The terms "contractor" and "g.c." refer to the owner's general contractor and the general contractor's sub-contractors. It is the general contractor's responsibility to determine the division of work among sub-contractors.

VICINITY MAP

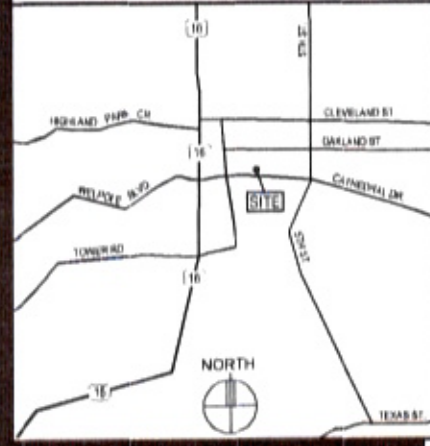

SITE DIRECTIONS

DIRECTIONS FROM BROWN FALLS SWITCH:
 S 60TH ST W TO W 16TH AVENUE. GO SOUTHEAST TO E BENSON RD GO EAST ON EAST BENSON RD TO 1229 N. GO NORTH ON 1229 N FOR 1.8 MI TO 140 W. GO WEST ON 140 W FOR 3/2 MILES TO 1100 SOUTH. TAKE 1100 S (EXIT 87) TO BR 44 (CATHARAL STREET). GO EAST ON BR 44 (CATHARAL ST.) TO 126 1/2 (RUSHMORE RD.) GO SOUTH ON US 16 (RUSHMORE RD.) TO CATHARAL DRIVE GO EAST TO THE SITE THAT IS LOCATED IN THE PENITHOUSE OF VALLEY VIEW APARTMENTS.

PROJECT INFORMATION

SITE NAME: RCYC SOUTH RAPID CITY
 PROJECT NUMBER: 2010432235
 SITE ADDRESS: 636 CATHEDRAL DRIVE, RAPID CITY, SD 57701
 COUNTY: PENNSYLVANIA
 GROUND ELEVATION: 3289 AMSL
 ANTENNA TIP HEIGHT: 3837 AMSL - 94 AGL
 ANTENNA CENTERLINE HEIGHT: 3479 AMSL - 90 AGL
 OVERALL STRUCTURE HEIGHT: 3493 AMSL - 104 AGL
 (BASED ON 80' DATED: 12-20-09)
 ESTIMATED COAX RUN: "X" COAX RUN + (4) 78" LINES @ 20' EA.
 "Y" COAX RUN + (4) 78" LINES @ 53' EA.
 "Z" COAX RUN + (4) 78" LINES @ 80' EA.

PROJECT DESCRIPTION:
 REPLACE EXISTING ANTENNAS, AND MODIFICATIONS OF EXISTING ANTENNA MOUNTS, AND INSTALLATION OF NEW LTE FRAMES IN EQUIPMENT AREA TO IMPROVE SERVICE IN THE RAPID CITY AREA.

SHEET INDEX

SHEET	SHEET DESCRIPTION
1-1	PROJECT INFORMATION AND GENERAL NOTES
A-1	TOWER ELEVATIONS
A-2	COAX AND ANTENNA KEY NOTES, AND DETAILS
A-3	MISCELLANEOUS PHOTOS, DETAILS, AND NOTES
SO-S1	STRUCTURAL NOTES AND DETAILS

ISSUE SUMMARY

REV	DESCRIPTION	SHEET OR DETAIL
A	ISSUED FOR REVIEW 4-09-10	ALL
B	ISSUED FOR OWNER SIGNOFF 09-13-10	ALL
C	ISSUED FOR BID / CONSTRUCTION 05-17-10	ALL

CONTACTS

LESSOR / LICENSOR: PENNSYLVANIA COUNTY HOUSING & REDEVELOPMENT COMMISSION
 LESSEE: VERIZON WIRELESS, 10861 BUSH LAKE ROAD, BLOOMINGTON, MN 55438, STEVE EDWARDS (952) 990-4747
 ARCHITECT: DESIGN 1 OF EDEN PRAIRIE, LTD., 2073 VALLEY VIEW ROAD, EDEN PRAIRIE, MN 55344, (952) 903-9299
 STRUCTURAL ENGINEER: STRUCK ENGINEERING, LLC, 9620 MEMORIAL AVE (SUITE E), OAK PARK HEIGHTS, MN 55457, 951-439-1139

VERIZON WIRELESS DEPARTMENTAL APPROVALS

JOB TITLE	NAME	DATE
RF ENGINEER	DAVID LORE	4-12-10
OPERATIONS MANAGER	MIKE THOMPSON	4-12-10
CONSTRUCTION ENGINEER	BILL BUTTERBAUGH	4-14-10
CONSTRUCTION MANAGER	RON REITER	4-14-10
REAL ESTATE MANAGER	STEVE EDWARDS	4-15-10

LESSOR / LICENSOR APPROVAL

SIGNATURE	PRINTED NAME	DATE

LESSOR / LICENSOR: PLEASE CHECK THE APPROPRIATE BOX BELOW
 NO CHANGES. CHANGES NEEDED. SEE COMMENTS ON PLANS

RECEIVED

JUN 28 2010

Rapid City Growth Management Department

NOT FOR CONSTRUCTION

DESIGN 1

ROBERT J OVENS, INC ARCHITECT, 2073 VALLEY VIEW RD, EDEN PRAIRIE, MN 55344, (952) 901-9999 FAX 952-909-9199

VERIZON WIRELESS

10861 BUSH LAKE ROAD, BLOOMINGTON, MN 55438, (952) 990-4747

PROJECT 2010432235

RCYC SOUTH RAPID CITY LTE

636 CATHEDRAL DRIVE, RAPID CITY, SD 57701

SHEET CONTENTS:
 CONTACTS
 ISSUE SUMMARY
 SHEET INDEX
 DEPARTMENTAL APPROVALS
 LESSOR APPROVAL
 PROJECT INFORMATION
 VICINITY MAP
 GENERAL NOTES

DRAWN BY: THB
 DATE: 3-15-10
 CHECKED BY: TAD
 REV. A: 4-09-10
 REV. B: 05-13-10
 REV. C: 05-17-10