

RECEIVED

APR 23 2010

Rapid City Growth
Management Department

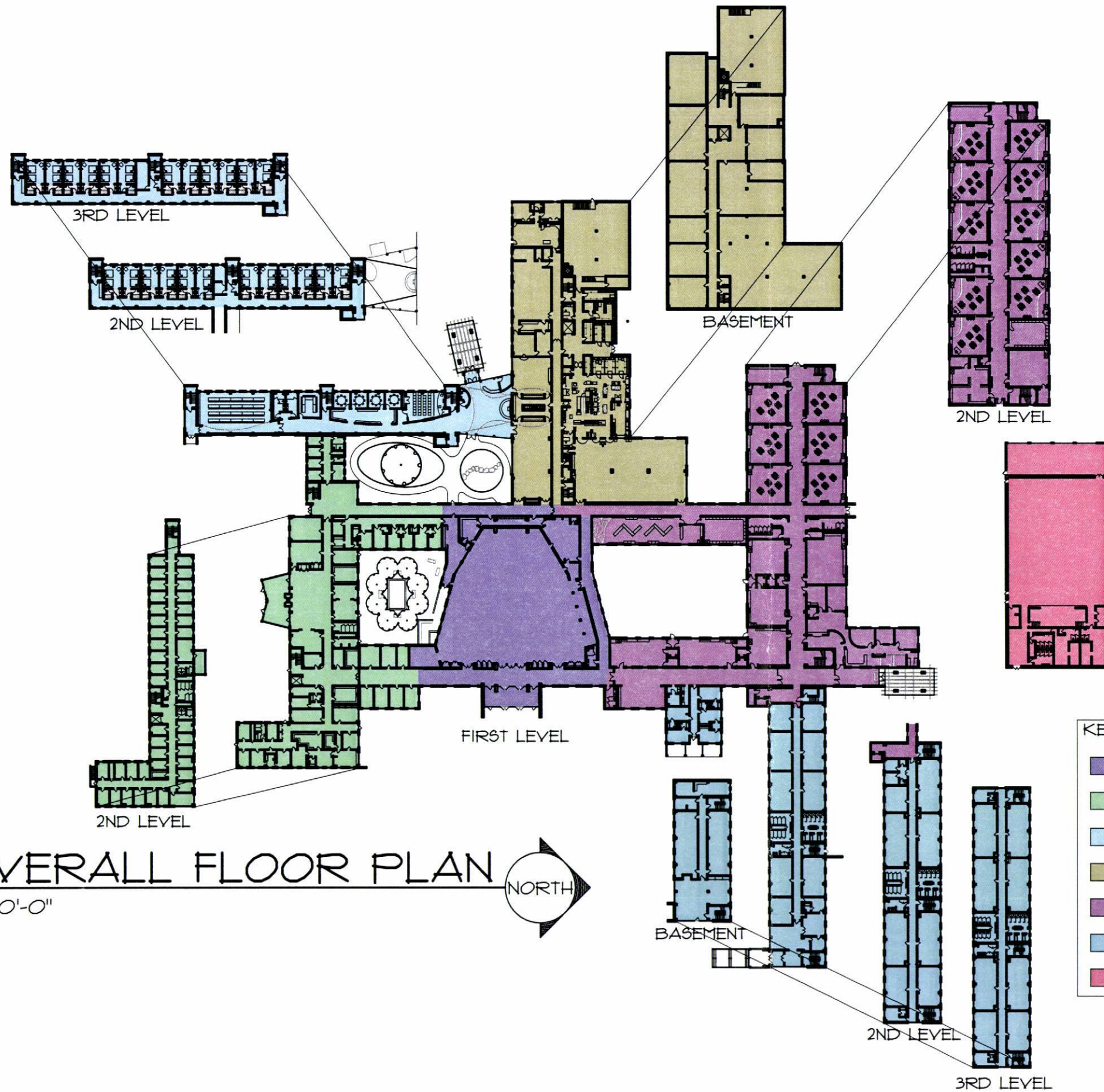

1 OVERALL FLOOR PLAN NORTH
 A1.00 1"=80'-0"

- KEY:
- AREA 1- CHAPEL
 - AREA 2- FUTURE REMODEL/OCCUPANCY
 - AREA 3- SPIRITUAL LIFE CENTER
 - AREA 4- KITCHEN/DINING
 - AREA 5- ELEMENTARY
 - AREA 6- FUTURE REMODEL/OCCUPANCY
 - AREA 7- GYMNASIUM

REVISIONS:
 DATE: APRIL 23, 2010
 PROJECT MANAGER: KELLI TREBIL
 PROJECT NUMBER: 2007-026

**PRELIMINARY
NOT FOR
CONSTRUCTION**

TERRA SANCTA
 RAPID CITY, SOUTH DAKOTA

OVERALL FLOOR PLAN

A1.00