

JUL 13 2010

RECEIVED

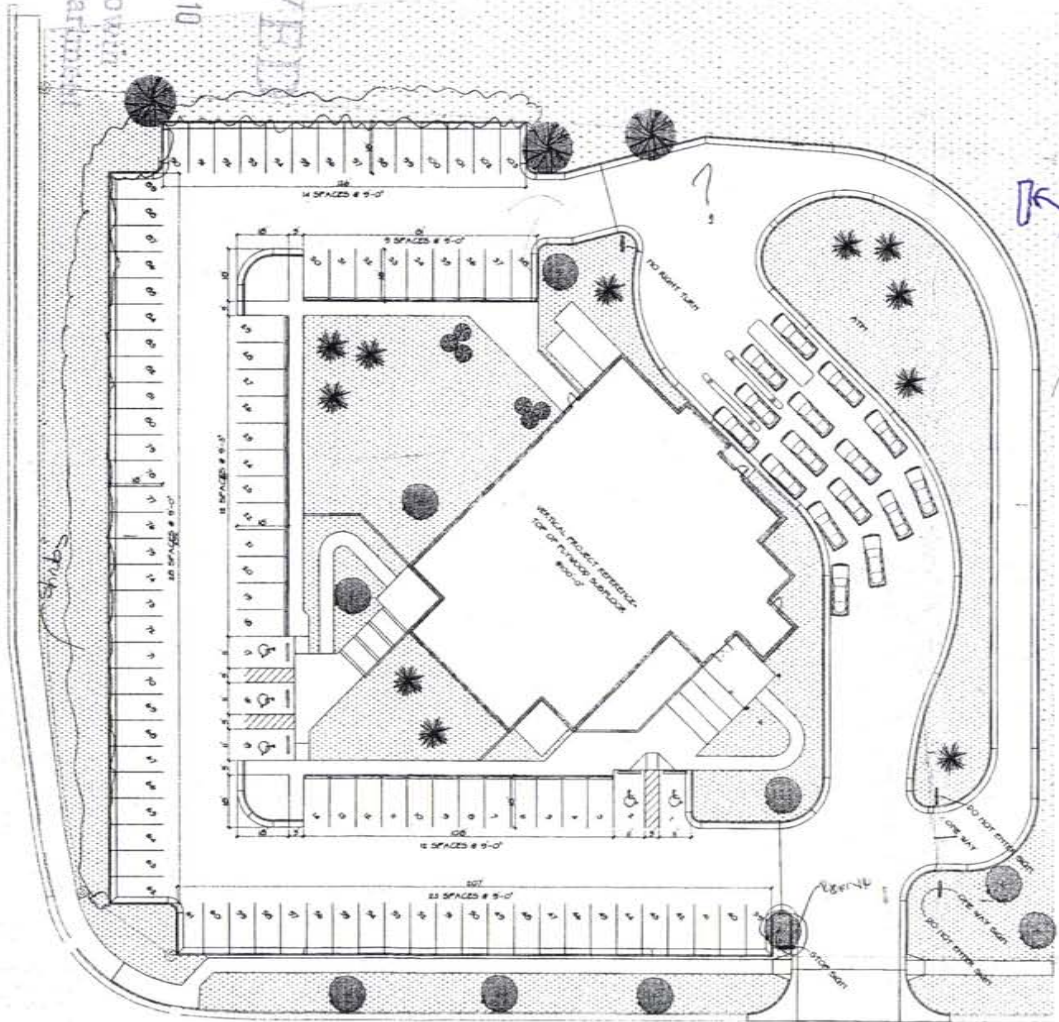

| | AREA | POINTS |
|----------------------------------|----------------|-------------------|
| SITE: 2.19 ACRE | | |
| = 99,799 SQ. FT. | 99,799 SQ. FT. | |
| BASIC BUILDING GSFA | 9,450 SQ. FT. | |
| BALANCE (POINTS REQUIRED) | 30,305 SQ. FT. | |
| POINTS ALLOWED OFFSITE | 22,976 SQ. FT. | |
| # 25% MAX | | |
| LAWN AREA ON EGLIN & ANAMOSA ROW | 4,261 SQ. FT. | |
| LAWN AREA BY NORTH WEST ROW | 14,500 SQ. FT. | |
| TOTAL LAWN (OFFSITE) | 18,761 SQ. FT. | 20,849 PTS. |
| TOTAL LAWN (ONSITE) | 32,465 SQ. FT. | (22,976 PTS. MAX) |
| TOTAL POINTS | | 36,072 PTS. |
| BALANCE OF POINTS REQUIRED | | 33,350 PTS. |

GRASSED AREA (OFF): $\frac{(18,761 \text{ SQ. FT.})}{9} \times 10 \text{ PTS. / SQ. YDS.} = 20,849 \text{ PTS}$

GRASSED AREA (ON): $\frac{(32,465 \text{ SQ. FT.})}{9} \times 10 \text{ PTS. / SQ. YDS.} = 36,072 \text{ PTS}$

- EVERGREEN: 11 TREES X 2000 PTS. = 22,000 PTS
- LARGE DEC.: 3 TREES X 2,000 PTS. = 6,000 PTS.
- MEDIUM DEC.: 10 TREES X 1000 PTS. = 10,000 PTS.
- SMALL DEC.: 2 TREES X 500 PTS. = 1,000 PTS.
- TOTAL TREE POINTS: 39,000 PTS.
- TREE AND GRASS TOTAL POINTS EXCEED REQUIRED

| LANDSCAPE POINTS: | |
|--------------------------------------|----------|
| TREES: | |
| LARGE 45 SPREAD OR 20 TALL EVERGREEN | 2000 PTS |
| MEDIUM 25 SPREAD | 1000 PTS |
| SMALL 15 SPREAD | 500 PTS |
| SHRUBS 2 FT HEIGHT | 250 PTS |
| GROUND COVER ONE SQUARE FOOT | 100 PTS |
| GRASS ONE SQUARE FOOT | 10 PTS |

Lighting Plan
Sign Package

- EVERGREEN
- LARGE DEC.
- MEDIUM DEC.
- SMALL DEC.
- NATIVE GRASS
- SOD

ARCHITECTURE
DESIGN / BUILD
RESTORATION
PLANNING / A
DEVELOPMENT

LEE S. GORBER
ARCHITECT
313 MAIN ST. 2ND FLOOR
RAPID CITY, SD 57701

CONSTRUCTION DRAWINGS FOR:
THE FIRST WESTERN BANK-WALL:
EGLIN STREET BRANCH
EGLIN STREET & EAST ANAMOSA STREET
RAPID CITY, SOUTH DAKOTA. 57701

FIRST WESTERN BANK-BRANCH
C1 LANDSCAPE PLAN
DRAWN BY: DCJ
DATE UPDATED: 03/04/2010
DATE ACCTD: 03/04/2010

DATE REVISIONS:
REVISION 1:
REVISION 2:
REVISION 3:

LANDSCAPE PLAN