

RECEIVED

MAR 14 2010

Rapid City Growth Management Department

- Found Monument
- Set 5/8" Rebar with Survey Cap Marked "Marker - 2002 and 3pm/1cm"
- Set 5/8" Rebar No Cap at Curve R.O.M. PC'S & PT'S
- Ⓜ Measured This Survey
- Ⓜ Recorded in a Previous Plat or Description

APRIL 29, 2010 *
NEW PEDESTRIAN PLAZAS, WALKWAYS, AMENITIES TO BE COMPLETED AS PART OF BUILDING EXPANSION: (SEE CIVIL & LANDSCAPE SHEETS)

OCTOBER 21, 2008 - A MINIMAL AMENDMENT TO CONDITIONAL USE PERMIT FOR ADDITION OF DECKS TO BUILDINGS K & I

NOTE: RESIDENT APARTMENT BUILDINGS C-N ARE ALL INDEPENDANT LIVING.

ALL SQUARE FOOTAGES ARE APPROXIMATE IN NATURE.

NOTE: ADDITION OF 9,858 SF OF STRUCTURE CONSTITUTES A 7% CHANGE TO OVERALL BUILDING FOOTPRINTS ON CAMPUS... APRIL 21/2010

TOTALS @ LAST UPDATE (APRIL 6, 2009) TO CONDITIONAL USE PERMIT

LANDSCAPE POINTS

TOTAL SITE SQ. FT.	690,861
BLDG. FOOTPRINT SQ. FT.	139,145
TOTAL POINTS REQ'D :	551,716

168 Lg. Trees AT 2000 pts. ea. =	336,000
26 Sm. Trees AT 500 pts. ea. =	13,000
739 SHRUBS AT 250 pts. ea. =	184,750
45,136 sq. ft. Grass AT 10 pts./sq. ft. =	451,360
TOTAL POINTS PROVIDED :	985,110

PARKING

TOTAL STALLS REQ'D :	168
TOTAL HDCP STALLS :	6
TOTAL REG. STALLS PROVIDED :	184
TOTAL HDCP STALLS :	18
TOTAL SGL CAR GARAGES :	64

ADJUSTED TOTALS (APRIL 29, 2010) TO CONDITIONAL USE PERMIT

LANDSCAPE POINTS REQUIRED

TOTAL SITE SQ. FT.	690,861
EXISTING BLDG FOOTPRINT SQ. FT.	139,145
ADDITIONAL PROPOSED BLDG FOOTPRINT(S)	9,858
TOTAL POINTS REQUIRED	541,858

* **LANDSCAPE ELEMENTS TO BE DEMOLISHED**

11 LARGE TREES @ 2000 PTS EACH	-22,000
2 SMALL TREES @ 1000 PTS EACH	-2,000
161 SHRUBS @ 250 POINTS EACH	-40250

* **LANDSCAPE POINTS TO BE PROVIDED / ADDED TO CAMPUS LANDSCAPE: (SEE LANDSCAPE PLANS)**

OVERALL TOTAL EXISTING:	985,110
LESS AMOUNT DEMOLISHED	-64,250
AMOUNTS TO BE ADDED	+19,356
100,216 PROVIDED / AMENDED	

• 31 LARGE TREES @ 2000 PTS EACH = 62000
 • 2 SMALL TREES @ 1000 PTS EACH = 2000
 • 210 SHRUBS @ 250 POINTS EACH = 52500
 • 1277 LESS SQ FT TURF GRASS @ 10 PTS / SQ FT (APPROXIMATELY) = -12,777
 • 36 ADDITIONAL SQ FT GRASS @ 100 PTS PER SQ FT = 3,633

Owner:
WESTHILLS VILLAGE HEALTH CARE FACILITY
 255 TEXAS STREET
 RAPID CITY, SD, 57701

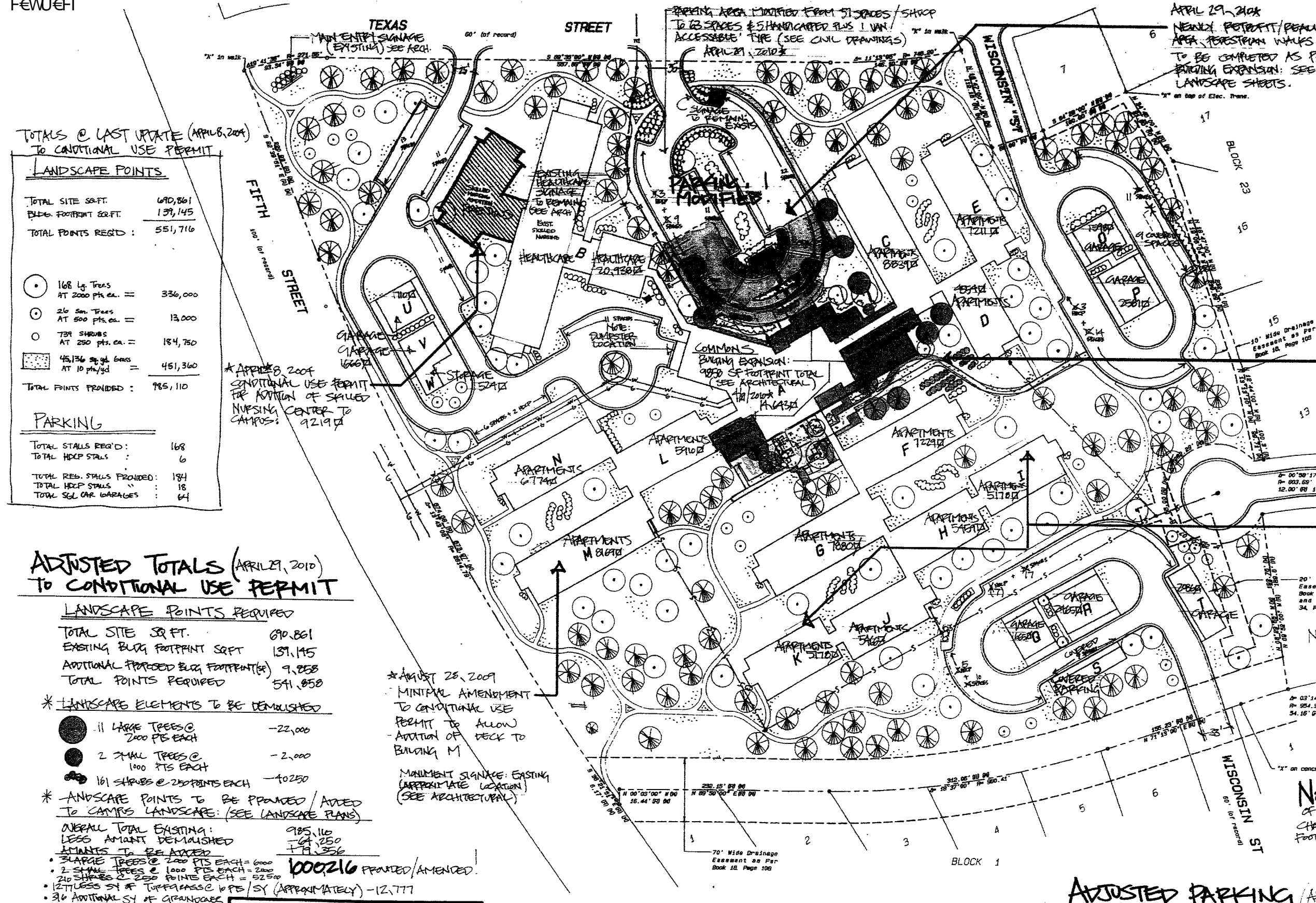

* AUGUST 25, 2009
 MINIMAL AMENDMENT TO CONDITIONAL USE PERMIT TO ALLOW ADDITION OF DECK TO BUILDING M
 MONUMENT SIGNAGE: EASTING (APPROXIMATE LOCATION) (SEE ARCHITECTURAL)

SITE PLAN
 1" = 50'-0"
 FOR CONDITIONAL USE PERMIT FOR SKILLED NURSING ADDITION APRIL 8, 2009
 FOR CONDITIONAL USE PERMIT FOR COMMONS ADDITION 4/9/2010 (AMENDED)

REVISIONS

ADJUSTED PARKING (APRIL 29, 2010)

FOR CONDITIONAL USE PERMIT

NOTE: ADDITIONAL SQUARE FOOTAGE DOES NOT INCLUDE ANY ADDITIONAL DWELLING UNITS (PRIMARILY AMENITIES) THIS DOES NOT INCREASE PARKING STALLS REQ'D.

TOTAL STALLS REQUIRED:	168
TOTAL HANDICAPPED STALLS	6
TOTAL STANDARD STALLS PROVIDED	195
TOTAL HANDICAPPED PROVIDED	22
NEW VAN ACCESSABLE CENTRY	1
TOTAL SINGLE CAR GARAGES	64

RECEIVED
 MAR 12 2004
 Rapid City Growth Management Department